

E.R. Wagner

CASTERS & WHEELS

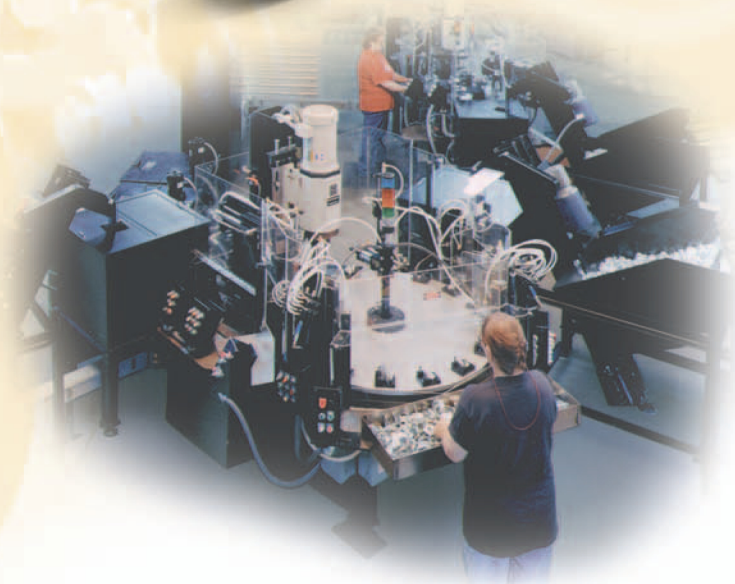
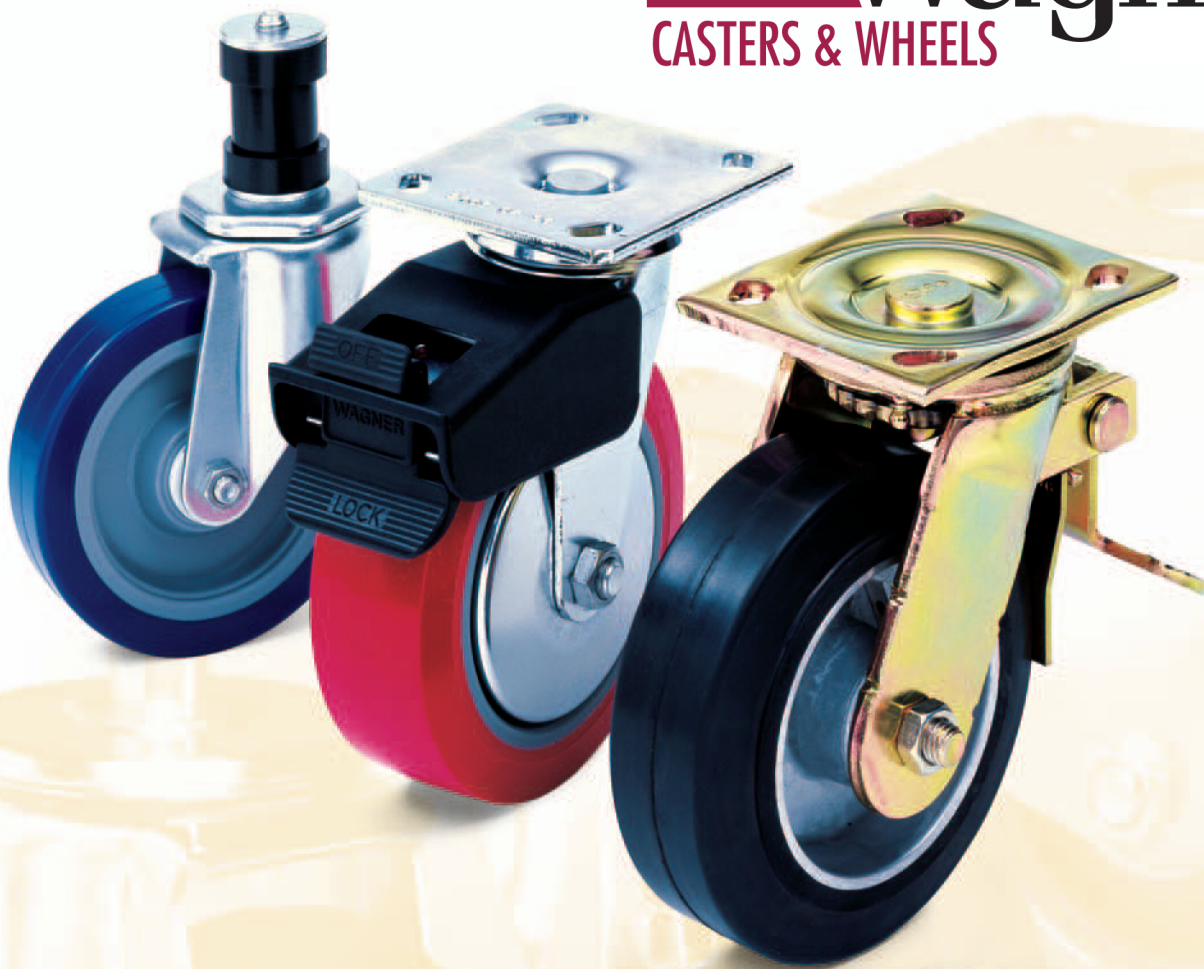

Acorn Industrial Products Co

520 Hertzog Boulevard

King of Prussia, PA 19406

Phone 800-523-5474

Fax 800-782-6780

E-Mail acorn@acornindprod.com

www.acornindprod.com

Table of Contents

E.R. WAGNER CASTERS & WHEELS	Inside Front Cover
TABLE OF CONTENTS	1
SELECTING A CASTER	4
SELECTING A WHEEL	5-6
WHEEL BEARINGS	7
LIGHT DUTY CASTERS	
75 to 125 lb. capacity (13/16" wheel tread width)	
Series 9F48, 9F78, 1F40 Swivel and Rigid Plate	8-9
Series 9F49, 8F49, 9F79, Swivel Stem	10-11
100 to 145 lb. capacity (1" wheel tread width)	
Series 2F68, 1F63 Swivel and Rigid Plate	12-13
Series 2F69 Swivel Stem	14-15
LIGHT-MEDIUM DUTY CASTERS	
120 to 280 lb. capacity (1-1/4" wheel tread width)	
Series 2F98, 1F93 Swivel and Rigid Plate	16-17
Series 2F99 Swivel Stem	18-19
MEDIUM DUTY CASTERS	
200 to 400 lb. capacity (1-3/8" to 1-1/2" wheel tread width)	
Series 1F28, 1F23 Swivel and Rigid Plate	20-21
Series 1F29 Swivel Stem	22-23
125 to 450 lb. capacity (1-1/4" to 1-1/2" wheel tread width)	
Americaster™ Series 3F08, 3F28, 3F03, 3F23, 3F09, 3F29 Swivel and Rigid Plate, Swivel Stem	24-27
150 to 500 lb. capacity (13/16" dual to 1-3/4" wheel tread width)	
Series 1F58, 1F53, 1F59 Swivel and Rigid Plate, Swivel Stem	28-29
MEDIUM-HEAVY DUTY CASTERS (Series 4F88, 4F83)	
300 to 700 lb. capacity (2" wheel tread width)	
Total Lock Swivel, Swivel and Rigid Plate Casters	30-31
HEAVY DUTY CASTERS (Series 1F88, 1F88, 1F83)	
300 to 1200 lb. capacity (2" wheel tread width)	
Swivel and Rigid Plate, Swivel Plate with Total Lock Brake, or Four-Position Swivel Lock	32-33
HEAVY DUTY VALUE CASTERS (Series 8W88, 8W83)	
300 to 1200 lb. capacity (2" wheel tread width)	
Swivel and Rigid Plate	34
HEAVY DUTY KINGPINLESS CASTERS (Series 8FXA, 8WXA, 8FX3, 8WX3)	
1600 to 2000 lb. capacity (2-1/2" wheel tread width)	
Swivel and Rigid Plate	35
SPECIALTY CASTERS	
Twin Wheel Casters	36
Special Thread Guard Casters & One-Piece Rigid Plate Casters	37
Light-Medium Duty Total Lock Swivel, Swivel and Rigid Plate Casters	38
Five-Inch Wheel Diameter Cart Casters	39
Shock Absorbing Casters & Pneumatic Wheel Casters	40
30- and 55-gallon Drum Dollies	41
WHEELS	
Soft Tread Wheels	
Cushionex Supreme	42
Poly II Rubber	43
Mold-On Rubber	44
Hard Tread Wheels	
Mold-On Polyurethane	44
Poly II Urethane	45
Durafoam	46
Poly II Poly	47
Spartan Supreme	48
Duratex Phenolic & Semi-Steel	49
ACCESSORIES	
Sockets & Brackets	Back Cover

Selecting a Wheel

WHEEL MATERIAL COMPARISONS				FLOOR SURFACES										OPERATING CONDITIONS													
WHEEL TYPE	TREAD HARDNESS	LOAD CAPACITY RANGE (LBS.)	TEMPERATURE RANGE	CARPET	BRICK	CONCRETE	LINOLEUM	ASPHALT	TERRAZZO	WOOD	STEEL SMOOTH	STEEL RIBBED	TILE	WATER	STEAM	MILD CHEMICALS	OIL & GREASE	METAL CHIPS	HIGH HEAT (+250°F)	EXTREME COLD (-10°F)	ANIMAL FATS	NOISE REDUCTION	FLOOR PROTECTION	CUSHION LOAD			
2 PIECE WHEEL - TREAD IS BONDED, MOLDED OR MECHANICALLY LOCKED TO A CORE																											
(TREAD / CORE MATERIAL)																											
Fully Pneumatic / Metal	Soft ↑ ↓ Hard	200 - 350	-45° F to 180° F	X	X	X	X	X	X	X	X	X	X	X	X	X	X	X	X	X	X	X	X	X	X	X	
Soft Rubber / Hard Rubber		75 - 350	-45° F to 125° F	X	X	X	X	X	X	X	X	X	X	X	X	X	X	X	X	X	X	X	X	X	X	X	
TPR (Thermoplastic Rubber) / Polyolefin		75 - 475	-45° F to 180° F	X	X	X	X	X	X	X	X	X	X	X	X	X	X	X	X	X	X	X	X	X	X	X	X
Rubber / Aluminum		300 - 500	-45° F to 180° F	X	X	X	X	X	X	X	X	X	X	X	X	X	X	X	X	X	X	X	X	X	X	X	X
Polyurethane / Polyolefin		125 - 900	-45° F to 180° F	X	X	X	X	X	X	X	X	X	X	X	X	X	X	X	X	X	X	X	X	X	X	X	X
Polyurethane / Steel		1800 - 2000	-45° F to 180° F	X	X	X	X	X	X	X	X	X	X	X	X	X	X	X	X	X	X	X	X	X	X	X	X
Polyurethane / Aluminim	Hard	750 - 1350	-45° F to 180° F	X	X	X	X	X	X	X	X	X	X	X	X	X	X	X	X	X	X	X	X	X	X	X	
1 PIECE SOLID MOLDED WHEEL																											
Nylon Twin Wheel	Hard ↑ ↓ Hardest	125 - 150	-45° F to 180° F	X	X	X					X	X		X	X	X	X			X	X						
All Hard Rubber		100 - 560	-45° F to 125° F	X	X	X					X			X	X	X				X				X			
Polypropylene (a.k.a.) Polyolefin		100 - 900	-45° F to 180° F	X	X	X	X				X			X	X	X	X				X	X		X			
Phenolic Resin		250 - 1200	-45° F to 300° F	X	X	X				X	X			X	X	X	X			X	X	X					
High Temperature Phenolic Resin		300 - 900	-45° F to 475° F	X	X	X				X	X			X	X	X	X			X	X	X					
Semi-Steel / Cast Iron		Hardest	175 - 1400	-45° F to 500° F			X	X		X	X					X	X	X	X	X	X	X					

This chart is intended only as a general comparison, and not as a recommendation for any particular wheel in a specific application.

Mold-On Rubber

This model is constructed of a cast aluminum hub to which a soft rubber tread is permanently bonded. It provides quiet operation, absorbs shock, and protects floors. Available in 2" tread width with roller bearing for use with heavier loads. Tread hardness: 70 to 85 Shore A.

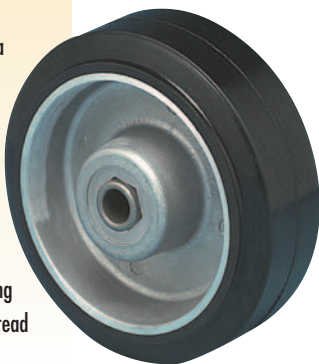

Cushionex Supreme

This all-rubber wheel has a soft rubber tread integrally molded and bonded to a hard rubber core. It provides a cushioned ride and quiet operation and is an economical and versatile choice for light to medium loads. Tread hardness: 70 to 85 Shore A.



Poly II Rubber

This durable wheel has a thermoplastic rubber tread molded and mechanically locked to a polypropylene plastic hub. It rolls easily and quietly. Available with delrin, ball, or roller bearings. Tread hardness: 90 to 100 Shore A.

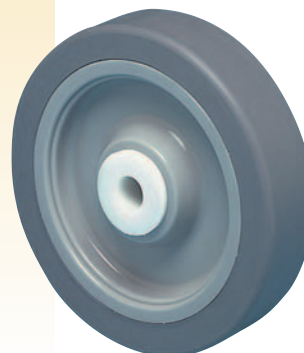

SOFT TREAD WHEELS

Soft tread wheels have lighter load ratings than equal size hard tread wheels. They roll quietly by absorbing floor surface imperfections which are normally transmitted through the caster. Soft tread wheels provide better swiveling action under light loads. They are recommended for:

- Light to medium loads
- Hard, uneven surfaces
- Quiet operation
- Frequent movement of loads
- Swiveling traction of light loads
- Applications where rolling ease is not critical

Wagner offers three soft tread wheels: **Cushionex Supreme, Mold-on Rubber, and Poly II Rubber.**

Selecting a Wheel

HARD TREAD WHEELS

Hard tread wheels have greater load ratings than soft tread wheels, primarily because hard treads do not flatten as easily. As a result, they roll with less effort, swivel easier under heavy loads and take less compression set. Hard tread wheels are recommended for:

- Rolling ease
- Light to heavy loads
- Seldom moved applications, either light or heavy
- Carpeted areas
- Outdoors
- When quiet operation is not critical

Wagner offers seven different types of hard tread wheels: Poly II Urethane, Mold-on Polyurethane, Durafoam, Poly II Poly, Spartan Supreme, Duratex Phenolic, and Semi-steel.

Poly II Urethane

This basic hard tread wheel has a polyurethane tread molded and mechanically locked to a polypropylene plastic hub. It offers excellent floor protection and abrasion resistance, rolling ease, quiet operation, and resistance to water, acids, oil, and most chemicals. Available with delrin, ball, or roller wheel bearings. Tread hardness: 50 to 60 Shore D.

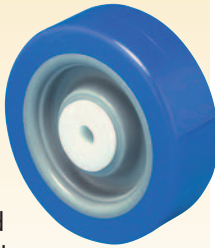

Mold-On Polyurethane

This wheel has a polyurethane tread permanently molded and mechanically locked to an aluminum hub. It provides easy rolling, high load capacity, good floor protection, and long service life. Available in 2" tread with roller bearing. Tread hardness: 55 Shore D.



Durafoam and Poly II Poly

These wheels are made of a polypropylene compound that is an excellent, multi-application performer. These wheels exhibit superior resistance to abrasion, compression set, acids, oils, grease, and impact. They provide easy rolling and good floor protection. Poly II Poly wheels are available in delrin, ball, or roller bearings. Tread hardness: 75 to 85 Shore D.



Spartan Supreme

This model features an all-hard rubber compound. It rolls effortlessly and is an economical and versatile choice for many applications. Tread hardness: 75 to 85 Shore D.



Duratex

Generally considered to be the easiest rolling wheel, the Duratex wheel is molded of phenolic resin which is reinforced with fibrous material, generally canvas. It features a high load capacity and provides better floor protection than semi-steel wheels. Tread hardness: 102 Shore E.



Semi-Steel

This super-tough wheel consists of cast iron enriched with steel. It rolls easily under heavy loads, has superior wear resistance, and takes shock impact well. It is not recommended where noise, shock protection of loads, or floor protection are of concern.

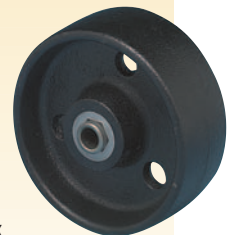

Wheel Bearings

Plain Bearings



These are the most economical bearings because the natural material of the wheel hub bore functions as the bearing. Plain bearings are most common in plastic hub wheels because the plastic material has natural

lubricistic properties. They are ideal for corrosive applications, require infrequent or no oil lubrication, and wear well.

Sintered Bearings

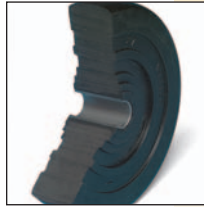

These sintered metal sleeves are impregnated with oil and press fit into the wheel hub bore. They typically require infrequent or no oil

lubrication, wear well, and have good heat and cold resistant properties.

Delrin® Bearings

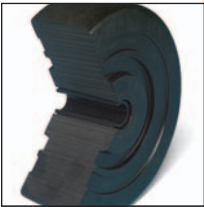

These bearings are made of an engineered plastic material press fit into the wheel hub bore. They are very durable, corrosion resistant, and typically require infrequent or no oil lubrication. Two Delrin bearing styles are available:

- 1) Straight sleeve type (top) for all Cushionex Supreme, Spartan Supreme, and 1" and 2" tread width Poly II wheels; and
- 2) Flanged insert type (bottom) for all other Poly II wheels.

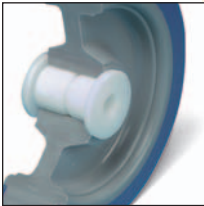

Delrin is a registered trademark of DuPont.

Roller Bearings

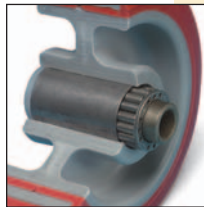

These bearings will carry a heavier load capacity and typically last longer than ball bearings. They provide good start-up and rolling ease and require periodic grease lubrication. Roller bearings have hardened rollers and are inserted into a hardened split outer race which is inserted into the wheel bore. Roller bearings for 2" tread wheels (top) include a wheel spanner bushing, which is not required for any other tread width (bottom).



Ball Bearings



Flanged ball bearings provide optimum start-up and rolling ease. Ball bearing wheels are recommended for use with load capacities up to 250 lbs.

75 to 125 lb.
capacity
¹³/₁₆" wheel tread
width

Light Duty Swivel Plate Casters

STANDARD FEATURES

- Light duty for general use.
- Double row swivel construction.
- 1/4" diameter rivet axle.
- Zinc-plated finish for corrosion resistance and appearance.
- Heat treat hardened and factory lubricated swivel raceways.



SERIES 9F48
Double Row Swivel
Plate Caster
(9F4852004000192)



SERIES 9F78
Double Row Swivel
Plate Caster
(Chrome-plated finish is
standard)
(9F7852004000292)



SERIES 1F40
One-piece Rigid
Caster
(1F40520040001AU)

OPTIONS Consult Factory (Available for 9F48 Series only)

Wheel Brake



- Side mount pinch type wheel brake available for all swivel models.
- Nut and bolt axle recommended for wheel brake casters.

Thread Guards



- Prevents objects from wrapping on wheel axle and obstructing rotation.
- Cannot be used with wheel brake.
- Available for most wheels.

Other

Conductive Wheels
(2 x 13/16 and 3 x 13/16
Cushionex Supreme)

Chrome Plated Finish

Nut and Bolt Axle

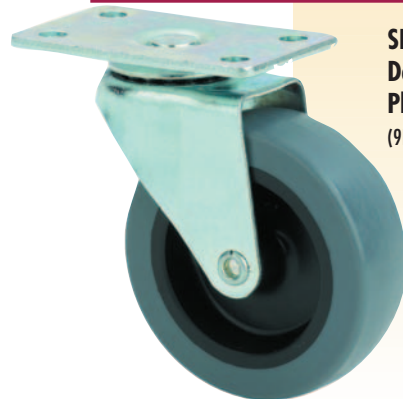

SERIES 9F48
Double Row Swivel
Plate Caster
(9F4853B26000193)

**** Plate Code Number**

Top Plate Choices



Overall Size 1-3/16" x 2"
Hole Spacing 13/16" x 1-9/16"
Hole Diameter 13/64"
Bolt Diameter 1/4"

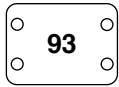

Overall Size 1-29/32" x 2-5/8"
Hole Spacing 15/16" x 2-1/8"
Hole Diameter 9/32"
Bolt Diameter 1/4"

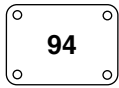

Overall Size 1-29/32" x 2-5/8"
Hole Spacing 1-13/32" x 2-1/8"
Hole Diameter 13/64"
Bolt Diameter 3/16"

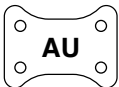

Overall Size 1-7/8" x 2-5/8"
Hole Spacing 31/32" x 1-7/8"
Hole Diameter 9/32"
Bolt Diameter 1/4"
(AU Plate is available for 2" Rigid Caster only.)

Wheel Types



Cushionex Supreme
Black soft rubber tread molded to black hard rubber core.



Durafoam (Dished)
Black molded polypropylene.



Poly II Rubber
Gray thermoplastic rubber tread molded to black polypropylene core.

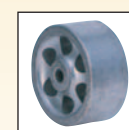

Sintered Metal
Powdered iron compacted and sintered.



Spartan Supreme
Black hard rubber tread molded to black hard rubber core.

A Wheel Dia. (inches)	Approximate Tread Width (inches)	Caster Capacity (pounds)	Wheel Bearing Type	B Height (inches)	C Swivel Radius (inches)	Approximate Weight (pounds)	Swivel Caster Part No.	Rigid Caster Part No.
SERIES 9F48 SWIVEL AND 1F40 RIGID PLATE CASTERS								
CUSHIONEX SUPREME WHEEL								
2	13/16	75	Delrin	2-5/8	1-7/8	1/2	9F48520040001**	1F40520040001AU
2-1/2	13/16	90	Delrin	3-3/16	2-1/8	1/2	9F48570040001**	—
3	13/16	100	Delrin	3-11/16	2-1/2	3/4	9F48530040001**	—
POLY II RUBBER WHEEL								
2	13/16	75	Plain	2-5/8	1-7/8	1/2	9F4852P260001**	1F4052P260001AU
3	13/16	100	Plain	3-11/16	2-1/2	3/4	9F4853P260001**	—
SPARTAN SUPREME WHEEL								
2	13/16	100	Delrin	2-5/8	1-7/8	1/2	9F48520090001**	1F40520090001AU
2-1/2	13/16	115	Delrin	3-3/16	2-1/8	1/2	9F48570090001**	—
3	13/16	125	Delrin	3-11/16	2-1/2	3/4	9F48530090001**	—
DURAFOAM WHEEL								
2	3/4	100	Plain	2-5/8	1-7/8	1/2	9F48521270001**	1F40521270001AU
2-1/2	13/16	115	Plain	3-3/16	2-1/8	1/2	9F48571270001**	—
3	3/4	125	Plain	3-11/16	2-1/2	1/2	9F48531270001**	—
SINTERED METAL WHEEL								
2	15/16	125	Plain	2-5/8	1-7/8	3/4	9F48520110001**	1F40520110001AU
SERIES 9F78 SWIVEL PLATE CASTERS								
CUSHIONEX SUPREME WHEEL								
2	Ball	75	Sintered	2-11/16	1-7/8	1/2	9F7852004000292	—
SPARTAN SUPREME WHEEL								
2	Ball	100	Sintered	2-11/16	1-7/8	1/2	9F7852009000292	—

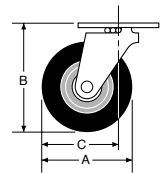

** NOTE: For your plate choice, replace ** in part number with plate code number shown in plate choices.

75 to 125 lb.
capacity
¹³/₁₆" wheel tread
width

Light Duty Swivel Stem Casters

STANDARD FEATURES

- Light duty for general use.
- 1/4" diameter rivet axle.
- Zinc-plated finish for corrosion resistance and appearance.
- Heat treat hardened and factory lubricated swivel raceways.

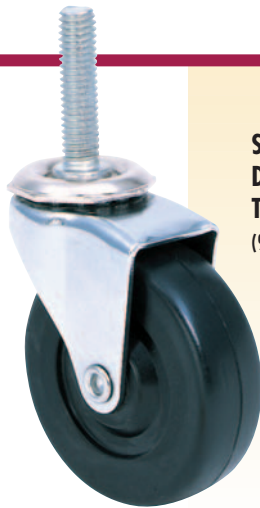

SERIES 9F49
Double Row Swivel
Threaded Stem Caster
(9F4957004000107)



SERIES 8F49
Double Row Swivel
Threaded Ladder
Stem Caster
(8F4953004000180)



SERIES 9F79
Double Row Swivel
Friction Ring Stem
Caster
(Chrome-plated finish
is standard)
(9F7952004000201)

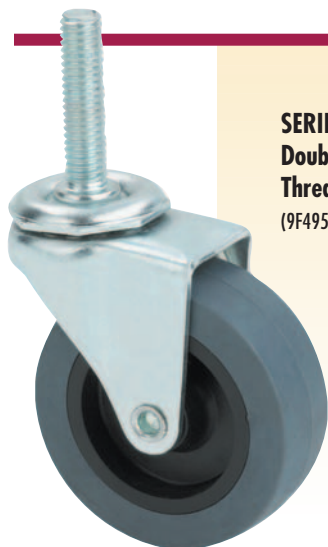

SERIES 9F49
Double Row Swivel
Threaded Stem Caster
(9F4953826000107)

OPTIONS Consult Factory (Available for 9F49 Series only)

Wheel Brake



- Side mount pinch type wheel brake available for all swivel models.
- Nut and bolt axle recommended for wheel brake casters.

Thread Guards



- Prevents objects from wrapping on wheel axle and obstructing rotation.
- Cannot be used with wheel brake.
- Available for most wheels.

Other

Conductive Wheels
(2 x 13/16 and 3 x 13/16 Cushionex Supreme)

Chrome-Plated Finish

Wheel Types



Cushionex Supreme
Black soft rubber tread molded to black hard rubber core.



Spartan Supreme
Black hard rubber tread molded to black hard rubber core.



Poly II Rubber
Gray thermoplastic rubber tread molded to black polypropylene core.



Durafoam (Dished)
Black molded polypropylene.

Stem Choices

Friction Ring Stems

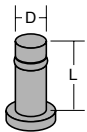

Stem Size Dia. x Length (D) (L)	** Stem Code Number
7/16 x 1-3/8	01
7/16 x 1-29/32	03

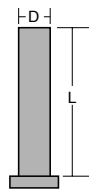

Round Stems

Stem Size Dia. x Length (D) (L)	** Stem Code Number
7/16 x 1-29/32	02

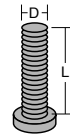

Threaded Stems

Stem Size Dia. x TPI x Length (D) (TPI) (L)	** Stem Code Number
5/16 - 18 x 3/4	84
5/16 - 18 x 1	17
5/16 - 18 x 1-1/2	08
5/16 - 18 x 4.936 Ladder Stem	80
3/8 - 16 x 1	04
3/8 - 16 x 1-1/2	07
1/2 - 13 x 1-1/2	10

Other stem sizes available on request.

A Wheel Dia. (inches)	Approximate Tread Width (inches)	Caster Capacity (pounds)	Wheel Bearing Type	B Height (inches)	C Swivel Radius (inches)	Approximate Weight (pounds)	Caster Part No.
SERIES 9F49 DOUBLE ROW SWIVEL STEM CASTERS							
CUSHIONEX SUPREME WHEEL							
2	13/16	75	Delrin	2-1/2	1-7/8	1/2	9F49520040001**
2-1/2	13/16	90	Delrin	3-1/16	2-1/8	1/2	9F49570040001**
3	13/16	100	Delrin	3-9/16	2-1/2	3/4	9F49530040001**
POLY II RUBBER WHEEL							
2	13/16	75	Plain	2-1/2	1-7/8	1/2	9F4952P260001**
3	13/16	100	Plain	3-9/16	2-1/2	3/4	9F4953P260001**
SPARTAN SUPREME WHEEL							
2	13/16	100	Delrin	2-1/2	1-7/8	1/2	9F49520090001**
2-1/2	13/16	115	Delrin	3-1/16	2-1/8	1/2	9F49570090001**
3	13/16	125	Delrin	3-9/16	2-1/2	3/4	9F49530090001**
DURAFOAM WHEEL							
2	3/4	100	Plain	2-1/2	1-7/8	1/2	9F49521270001**
2-1/2	13/16	115	Plain	3-1/16	2-1/8	1/2	9F49571270001**
3	3/4	125	Plain	3-9/16	2-1/2	1/2	9F49531270001**
SERIES 8F49 SWIVEL LADDER STEM CASTERS							
CUSHIONEX SUPREME WHEEL							
2	13/16	75	Delrin	2-1/2	1-11/16	1/2	8F4952004000180
3	13/16	100	Delrin	3-1/2	2-9/16	3/4	8F4953004000180
SERIES 9F79 DOUBLE ROW SWIVEL STEM CASTERS							
CUSHIONEX SUPREME WHEEL							
2	Ball	75	Sintered	2-5/8	1-7/8	1/2	9F79520040002**
SPARTAN SUPREME WHEEL							
2	Ball	100	Sintered	2-5/8	1-7/8	1/2	9F79520090002**

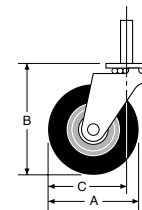

** NOTE: For your stem choice, replace ** in part number with stem code number shown in stem choices.

100 to 145 lb.
capacity
1" wheel tread
width

Light Duty Swivel and Rigid Plate Casters



STANDARD FEATURES

- Light duty applications.
- Double row swivel construction.
- 5/16" diameter nut and bolt axle.
- Zinc-plated finish for corrosion resistance and appearance.
- Heat treat hardened and factory lubricated swivel raceways.



SERIES 2F68
Double Row Swivel
Plate Caster
(2F6804004000197)



SERIES 1F63
Two-Piece Rigid
Plate Caster
(1F6304P25000197)

OPTIONS Consult Factory

Side Pinch Type Wheel Brake



- Side mount pinch type wheel brake available for all swivel models.

Strap Type Wheel Brake



- Strap type wheel brake available for all swivel models.

Trailing End Wheel Brake



- Positive lock, easy access tread type wheel brake. Field installable brake kits available. Kit includes: brake assembly, axle, and locknut.

Thread Guards



- Prevents objects from wrapping on wheel axle and obstructing rotation.
- Cannot be used with wheel brake.
- Available for most wheels.

Other

- Economical Rivet Axle One Piece Rigid Casters
- Conductive Wheels (4 x 1 and 5 x 1 Cushionex Supreme)
- Nickel-Plated Finish
- Delrin Bearing available for all Poly II Wheels
- NSF Certified Casters



Rubber "O" Ring Swivel Raceway Grease Seal

**** Plate Code Number**

Top Plate Choices

Wheel Types



Overall Size 2-3/4" x 3-3/4"
Hole Spacing 1-3/4" x 3"
Hole Diameter 11/32"
Bolt Diameter 5/16"

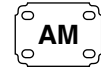

Overall Size 2-3/4" x 3-3/4"
Hole Spacing 1-3/4" x 2-5/8" to 3"
Hole Diameter 11/32" x 1/2" slots
Bolt Diameter 5/16"

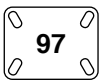

Overall Size 3-1/8" x 4-1/8"
Hole Spacing 1-3/4" x 3" to 2-3/8" x 3-3/8"
Hole Diameter 3/8" x 3/4" slots
Bolt Diameter 5/16"

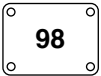

Overall Size 3-1/8" x 4-1/8"
Hole Spacing 2-3/8" x 3-7/16"
Hole Diameter 11/32"
Bolt Diameter 5/16"

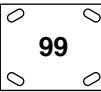

Overall Size 3-3/4" x 4-5/8"
Hole Spacing 2-5/8" x 3-5/8" to 3" x 3"
Hole Diameter 3/8" x 3/4" slots
Bolt Diameter 5/16"



Cushionex Supreme
Black soft rubber tread molded to black hard rubber core.



Spartan Supreme
Black hard rubber tread molded to black hard rubber core.

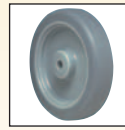

Poly II Rubber
Dark gray thermoplastic rubber tread molded to light gray polypropylene core.



Durafoam (Solid)
Black molded polypropylene.



Poly II Urethane
Dark blue polyurethane tread molded to light gray polypropylene core.

SERIES 2F68 SWIVEL AND 1F63 RIGID PLATE CASTERS

A Wheel Dia. (inches)	Approximate Tread Width (inches)	Caster Capacity (pounds)	Wheel Bearing Type	B Height (inches)	C Swivel Radius (inches)	Approximate Weight (pounds)	Swivel Caster Part No.	Rigid Caster Part No.
CUSHIONEX SUPREME WHEEL								
3	1	100	Delrin	3-13/16	2-3/4	1-1/4	2F68030040001**	1F63030040001**
4	1	115	Delrin	4-13/16	3-1/4	1-1/2	2F68040040001**	1F63040040001**
5	1	125	Delrin	5-13/16	4	2	2F68050040001**	1F63050040001**
POLY II RUBBER WHEEL								
3	1	125	Plain	3-13/16	2-3/4	1	2F6803P260001**	1F6303P260001**
4	1	135	Plain	4-13/16	3-1/4	1-1/4	2F6804P260001**	1F6304P260001**
5	1	145	Plain	5-13/16	4	1-1/2	2F6805P260001**	1F6305P260001**
SPARTAN SUPREME WHEEL								
3	1	125	Delrin	3-13/16	2-3/4	1-1/4	2F68030090001**	1F63030090001**
4	1	140	Delrin	4-13/16	3-1/4	1-1/2	2F68040090001**	1F63040090001**
5	1	145	Delrin	5-13/16	4	2	2F68050090001**	1F63050090001**
DURAFOAM WHEEL								
3	1	125	Plain	3-13/16	2-3/4	1	2F68030270001**	1F63030270001**
4	1	140	Plain	4-13/16	3-1/4	1-1/4	2F68040270001**	1F63040270001**
5	1	145	Plain	5-13/16	4	1-1/2	2F68050270001**	1F63050270001**
POLY II URETHANE WHEEL								
3	1	125	Plain	3-13/16	2-3/4	1	2F6803P250001**	1F6303P250001**
4	1	140	Plain	4-13/16	3-1/4	1-1/4	2F6804P250001**	1F6304P250001**
5	1	145	Plain	5-13/16	4	1-1/2	2F6805P250001**	1F6305P250001**

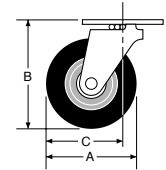

** NOTE: For your plate choice, replace ** in part number with plate code number shown in top plate choices.

100 to 145 lb.
capacity
1" wheel tread
width

Light Duty Swivel Stem Casters



STANDARD FEATURES

- Light duty applications.
- Double row swivel construction.
- 5/16" diameter nut and bolt axle.
- Zinc-plated finish for corrosion resistance and appearance.
- Heat treat hardened and factory lubricated swivel raceways.
- Assembly wrench
1J000222297



SERIES 2F69
Double Row Swivel
Friction Ring Stem
Caster
(2F6903027000101)

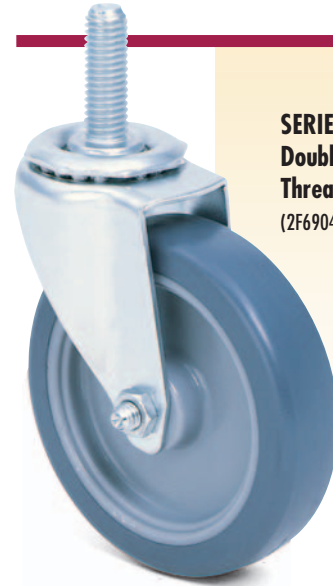

SERIES 2F69
Double Row Swivel
Threaded Stem Caster
(2F6904P26000110)

OPTIONS Consult Factory

Expandable Stem Adapters

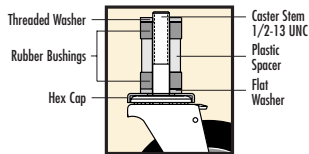

These stems will fit a variety of round and square tubing sizes. They feature a top-mounted, easily accessible hex cap for ease of assembly and tightening. The two rubber bushings permit easy tightening in tubing, while the plastic spacer adds stability to the assembly.

Specify stem code number 25 in caster part number. Casters and expandable stem kits can be ordered separately or factory can install expandable adapter onto the caster.

LIGHT DUTY ADAPTERS (For 2F69 Series Casters)

Expandable Stem Kit Model No.	Fits Tubing I.D. Size
2F000233894	0.750" to 0.999"
2F000233994	1.000" to 1.249"
2F000234094	1.250" to 1.499"
2F000234194	1.500" to 1.749"

Strap Type Brake



Side Pinch Type Wheel Brake



- Brakes available for all swivel models.

Trailing End Wheel Brake



- Positive lock, easy access tread type wheel brake. Field installable brake kits available. Kit includes: brake assembly, axle, and locknut.

Thread Guards



- Prevents objects from wrapping on wheel axle and obstructing rotation.
- Cannot be used with wheel brake.
- Available for most wheels.

Other

Economical Rivet Axle

Conductive Wheels

(4 x 1 and 5 x 1 Cushionex Supreme)

Nickel-Plated Finish

Delrin Bearing available for all Poly II Wheels

NSF Certified Casters



Rubber "O" Ring Swivel Raceway Grease Seal

Stem Choices

Friction Ring Stems

Stem Size Dia. x Length (D) (L)	** Stem Code Number
7/16 x 1-3/8	01
7/16 x 1-29/32	03
5/8 x 2-3/16	ZW
13/16 x 1-3/4	37

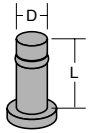

Threaded Stems

Stem Size Dia. x TPI x Length (D) (TPI) (L)	** Stem Code Number
3/8 - 16 x 1	04
3/8 - 16 x 1-1/2	07
7/16 - 14 x 7/8	23
7/16 - 14 x 1-1/2	05
1/2 - 13 x 3/4	06
1/2 - 13 x 1	61
1/2 - 13 x 1-1/2	10
Expandable	25

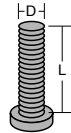

Octagon Stems

Stem Size Dia. x Length (D) (L)	Hole Size	Hole Location (A) (E)	** Stem Code Number
.750 x 2	3 @ .265"	1" .375"	74
.860 x 2	1 @ .265"	1" —	36

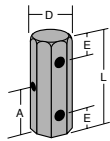

Other stem sizes available on request.

Wheel Types



Cushionex Supreme
Black soft rubber tread molded to black hard rubber core.



Spartan Supreme
Black hard rubber tread molded to black hard rubber core.

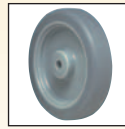

Poly II Rubber
Dark gray thermoplastic rubber tread molded to light gray polypropylene core.



Durafoam (Solid)
Black molded polypropylene.

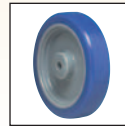

Poly II Urethane
Dark blue polyurethane tread molded to light gray polypropylene core.

SERIES 2F69 SWIVEL STEM CASTERS

A Wheel Dia. (inches)	Approximate Tread Width (inches)	Caster Capacity (pounds)	Wheel Bearing Type	B Height (inches)	C Swivel Radius (inches)	Approximate Weight (pounds)	Swivel Caster Part No.
CUSHIONEX SUPREME WHEEL							
3	1	100	Delrin	3-3/4	2-3/4	1-1/4	2F69030040001**
4	1	115	Delrin	4-11/16	3-1/4	1-1/2	2F69040040001**
5	1	125	Delrin	5-11/16	4	2	2F69050040001**
POLY II RUBBER WHEEL							
3	1	125	Plain	3-3/4	2-3/4	1	2F6903P260001**
4	1	135	Plain	4-11/16	3-1/4	1-1/4	2F6904P260001**
5	1	145	Plain	5-11/16	4	1-1/2	2F6905P260001**
SPARTAN SUPREME WHEEL							
3	1	125	Delrin	3-3/4	2-3/4	1-1/4	2F69030090001**
4	1	140	Delrin	4-11/16	3-1/4	1-1/2	2F69040090001**
5	1	145	Delrin	5-11/16	4	2	2F69050090001**
DURAFUAM WHEEL							
3	1	125	Plain	3-3/4	2-3/4	1	2F69030270001**
4	1	140	Plain	4-11/16	3-1/4	1-1/4	2F69040270001**
5	1	145	Plain	5-11/16	4	1-1/2	2F69050270001**
POLY II URETHANE WHEEL							
3	1	125	Plain	3-3/4	2-3/4	1	2F6903P250001**
4	1	140	Plain	4-11/16	3-1/4	1-1/4	2F6904P250001**
5	1	145	Plain	5-11/16	4	1-1/2	2F6905P250001**

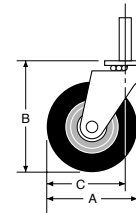

** NOTE: For your stem choice, replace ** in part number with stem code number shown in stem choices.

120 to 280 lb. capacity
 1 1/4" wheel tread width

Light-Medium Duty Swivel and Rigid Plate Casters



STANDARD FEATURES

- Light-medium duty applications.
- Double row swivel construction.
- 5/16" diameter nut and bolt axle.
- Zinc-plated finish for corrosion resistance and appearance.
- Heat treat hardened and factory lubricated swivel raceways.



SERIES 2F98
Double Row Swivel Plate Caster
 (2F9804004000198)



SERIES 1F93
Two-Piece Rigid Plate Caster
 (1F9304B25000198)

OPTIONS Consult Factory

Strap Type Wheel Brake



- Strap type wheel brake available for all swivel models.

Side Pinch Type Wheel Brake



- Side mount pinch type wheel brake available for all swivel models.

Trailing End Wheel Brake



- Positive lock, easy access tread type wheel brake. Field installable brake kits available. Kit includes: brake assembly, axle, and locknut.

Thread Guards



- Prevents objects from wrapping on wheel axle and obstructing rotation.
- Cannot be used with wheel brake.
- Available for most wheels.

Other

Nickel-Plated Finish
 One Piece Rigid Casters
 Economical Rivet Axle
 NSF Certified Casters



Rubber "O" Ring Swivel Raceway Grease Seal

**** Plate Code Number**

Top Plate Choices

Wheel Types



Overall Size 2-3/4" x 3-3/4"
Hole Spacing 1-3/4" x 3"
Hole Diameter 11/32"
Bolt Diameter 5/16"



Overall Size 2-3/4" x 3-3/4"
Hole Spacing 1-3/4" x 2-5/8" to 3"
Hole Diameter 11/32" x 1/2" slots
Bolt Diameter 5/16"



Overall Size 3-1/8" x 4-1/8"
Hole Spacing 1-3/4" x 3" to 2-3/8" x 3-3/8"
Hole Diameter 3/8" x 3/4" slots
Bolt Diameter 5/16"



Overall Size 3-1/8" x 4-1/8"
Hole Spacing 2-3/8" x 3-7/16"
Hole Diameter 11/32"
Bolt Diameter 5/16"



Overall Size 3-3/4" x 4-5/8"
Hole Spacing 2-5/8" x 3-5/8" to 3" x 3"
Hole Diameter 3/8" x 3/4" slots
Bolt Diameter 5/16"



Overall Size 2-1/2" x 5"
Hole Spacing 1-1/16" x 3-15/32" to 1-3/16" x 4"
Hole Diameter 11/32" x 39/64" slots
Bolt Diameter 5/16"
AT top plate is available for rigid casters only.



Cushionex Supreme
Black soft rubber tread molded to black hard rubber core.

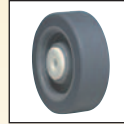

Poly II Rubber
Dark gray thermoplastic rubber tread molded to light gray polypropylene core.



Spartan Supreme
Black hard rubber tread molded to black hard rubber core.

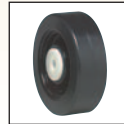

Poly II Poly
Black polypropylene tread molded to black polypropylene core.



Durafoam (Solid)
Black molded polypropylene. (2-1/2" wheel is dish type.)

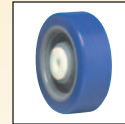

Poly II Urethane
Dark blue polyurethane tread molded to light gray polypropylene core.



Duratex Phenolic
Black phenolic resin reinforced with macerated fabric.

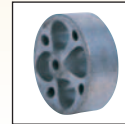

Sintered Metal
Powdered iron compacted and sintered.

SERIES 2F98 SWIVEL AND 1F93 RIGID PLATE CASTERS

A Wheel Dia. (inches)	Approximate Tread Width (inches)	Caster Capacity (pounds)	Wheel Bearing Type	B Height (inches)	C Swivel Radius (inches)	Approximate Weight (pounds)	Swivel Caster Part No.	Rigid Caster Part No.
CUSHIONEX SUPREME WHEEL								
2-1/2	1-1/8	120	Sintered	3-7/16	2-1/4	1	2F98070040001**	1F93070040001**
3	1-1/4	125	Delrin	3-3/4	2-3/8	1-1/4	2F98030040001**	1F93030040001**
4	1-1/4	165	Delrin	4-11/16	3-3/8	1-1/2	2F98040040001**	1F93040040001**
5	1-1/4	190	Delrin	5-5/8	4-1/8	2-1/4	2F98050040001**	1F93050040001**
POLY II RUBBER WHEEL								
3	1-1/4	210	Delrin	3-3/4	2-3/8	1	2F9803B260001**	1F9303B260001**
3-1/2	1-1/4	250	Delrin	4-7/16	3-1/8	1-1/4	2F9809B260801**	1F9309B260801**
4	1-1/4	275	Delrin	4-11/16	3-3/8	1-1/2	2F9804B260001**	1F9304B260001**
5	1-1/4	280	Delrin	5-5/8	4-1/8	1-3/4	2F9805B260001**	1F9305B260001**
SPARTAN SUPREME WHEEL								
2-1/2	1-1/8	175	Sintered	3-7/16	2-1/4	1	2F98070090001**	1F93070090001**
3	1-1/4	210	Delrin	3-3/4	2-3/8	1-1/4	2F98030090001**	1F93030090001**
4	1-1/4	255	Delrin	4-11/16	3-3/8	1-1/2	2F98040090001**	1F93040090001**
5	1-1/4	280	Delrin	5-5/8	4-1/8	2-1/4	2F98050090001**	1F93050090001**
DURAFOAM WHEEL								
2-1/2	1-1/4	175	Plain	3-7/16	2-1/4	1	2F98071270001**	1F93071270001**
3	1-1/4	210	Plain	3-3/4	2-3/8	1	2F98030270001**	1F93030270001**
4	1-1/4	255	Plain	4-11/16	3-3/8	1-1/4	2F98040270001**	1F93040270001**
5	1-1/4	280	Plain	5-5/8	4-1/8	1-1/2	2F98050270001**	1F93050270001**
POLY II POLY WHEEL								
3	1-1/4	210	Delrin	3-3/4	2-3/8	1	2F9803B270001**	1F9303B270001**
3-1/2	1-1/4	250	Delrin	4-7/16	3-1/8	1-1/4	2F9809B270801**	1F9309B270801**
4	1-3/8	275	Delrin	4-11/16	3-3/8	1-1/2	2F9804B270001**	1F9304B270001**
5	1-3/8	280	Delrin	5-5/8	4-1/8	1-3/4	2F9805B270001**	1F9305B270001**
POLY II URETHANE WHEEL								
3	1-1/4	210	Delrin	3-3/4	2-3/8	1	2F9803B250001**	1F9303B250001**
3-1/2	1-1/4	250	Delrin	4-7/16	3-1/8	1-1/4	2F9809B250801**	1F9309B250801**
4	1-1/4	275	Delrin	4-11/16	3-3/8	1-1/2	2F9804B250001**	1F9304B250001**
5	1-1/4	280	Delrin	5-5/8	4-1/8	1-3/4	2F9805B250001**	1F9305B250001**
DURATEX WHEEL								
3	1-1/4	250	Plain	3-3/4	2-3/8	1-1/2	2F98030380001**	1F93030380001**
SINTERED WHEEL								
2-1/2	1	175	Plain	3-7/16	2-1/4	1-1/2	2F98070110001**	1F93070110001**
3	1-5/32	250	Plain	3-3/4	2-3/8	2-1/4	2F98030110001**	1F93030110001**

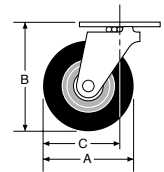

**** NOTE:** For your plate choice, replace ** in part number with plate code number shown in top plate choices.

120 to 280 lb.
capacity
1 1/4" wheel tread
width

Light-Medium Duty Swivel Stem Casters



STANDARD FEATURES

- Light-medium duty applications.
- Double row swivel construction.
- 5/16" diameter nut and bolt axle.
- Zinc-plated finish for corrosion resistance and appearance.
- Heat treat hardened and factory lubricated swivel raceways.
- Assembly wrench 1J00022297



SERIES 2F99
Double Row Swivel Friction Ring Stem Caster
(2F9903027000101)

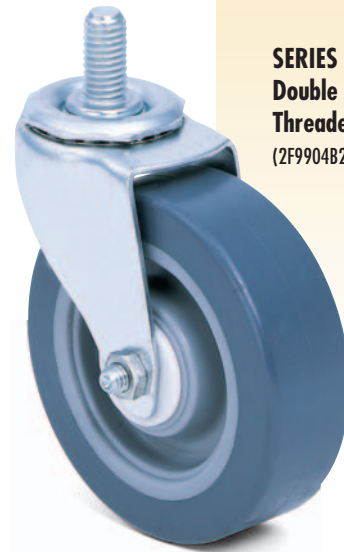

SERIES 2F99
Double Row Swivel Threaded Stem Caster
(2F9904826000161)

OPTIONS Consult Factory

Expandable Stem Adapters

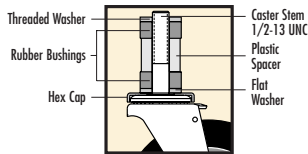

These stems will fit a variety of round and square tubing sizes. They feature a top-mounted, easily accessible hex cap for ease of assembly and tightening. The two rubber bushings permit easy tightening in tubing, while the plastic spacer adds stability to the assembly.

Specify stem code number 25 in caster part number. Casters and expandable stem kits can be ordered separately or factory can install expandable adapter onto the caster.

LIGHT DUTY ADAPTERS (For 2F99 Series Casters)

Expandable Stem Kit Model No.	Fits Tubing I.D. Size
2F000233894	0.750" to 0.999"
2F000233994	1.000" to 1.249"
2F000234094	1.250" to 1.499"
2F000234194	1.500" to 1.749"

Strap Type Brake



Side Pinch Type Wheel Brake



- Wheel brakes available for all swivel models.

Trailing End Wheel Brake



- Positive lock, easy access tread type wheel brake. Field installable brake kits available. Kit includes: brake assembly, axle, and locknut.

Thread Guards



- Prevents objects from wrapping on wheel axle and obstructing rotation.
- Cannot be used with wheel brake.
- Available for most wheels.

Other

Nickel-Plated Finish

Economical Rivet Axle

Delrin Bearing available for all Poly II Wheels

NSF Certified Casters



Rubber "O" Ring Swivel Raceway Grease Seal

Stem Choices

Friction Ring Stems

Stem Size Dia. x Length (D) (L)	** Stem Code Number
7/16 x 1-3/8	01
7/16 x 1-29/32	03
5/8 x 2-3/16	ZW
13/16 x 1-3/4	37

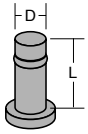

Threaded Stems

Stem Size Dia. x TPI x Length (D) (TPI) (L)	** Stem Code Number
3/8 - 16 x 1	04
3/8 - 16 x 1-1/2	07
7/16 - 14 x 7/8	23
7/16 - 14 x 1-1/2	05
1/2 - 13 x 3/4	06
1/2 - 13 x 1	61
1/2 - 13 x 1-1/2	10
Expandable	25

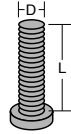

Octagon Stems

Stem Size Dia. x Length (D) (L)	Hole Size	Hole Location (A) (E)	** Stem Code Number
.750 x 2	3 @ .265"	1" .375"	74
.860 x 2	1 @ .265"	1" —	36

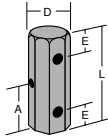

Other stem sizes available on request.

Wheel Types



Cushionex Supreme
Black soft rubber tread molded to black hard rubber core.



Durafoam (Solid)
Black molded polypropylene.

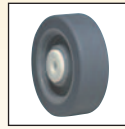

Poly II Rubber
Dark gray thermoplastic rubber tread molded to light gray polypropylene core.

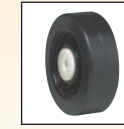

Poly II Poly
Black polypropylene tread molded to black polypropylene core.



Spartan Supreme
Black hard rubber tread molded to black hard rubber core.

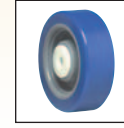

Poly II Urethane
Dark blue polyurethane tread molded to light gray polypropylene core.

SERIES 2F99 SWIVEL STEM CASTERS

A Wheel Dia. (inches)	Approximate Tread Width (inches)	Caster Capacity (pounds)	Wheel Bearing Type	B Height (inches)	C Swivel Radius (inches)	Approximate Weight (pounds)	Swivel Caster Part No.
CUSHIONEX SUPREME WHEEL							
2-1/2	1-1/8	120	Sintered	3-5/16	2-1/4	1	2F99070040001**
3	1-1/4	125	Delrin	3-5/8	2-3/8	1-1/4	2F99030040001**
4	1-1/4	165	Delrin	4-1/2	3-3/8	1-1/2	2F99040040001**
5	1-1/4	190	Delrin	5-1/2	4-1/8	2-1/4	2F99050040001**
POLY II RUBBER WHEEL							
3	1-1/4	210	Delrin	3-5/8	2-3/8	1	2F9903B260001**
3-1/2	1-1/4	250	Delrin	4-1/4	3-1/8	1-1/4	2F9909B260801**
4	1-1/4	275	Delrin	4-1/2	3-3/8	1-1/2	2F9904B260001**
5	1-1/4	280	Delrin	5-1/2	4-1/8	1-3/4	2F9905B260001**
SPARTAN SUPREME WHEEL							
2-1/2	1-1/8	175	Sintered	3-5/16	2-1/4	1	2F99070090001**
3	1-1/4	210	Delrin	3-5/8	2-3/8	1-1/4	2F99030090001**
4	1-1/4	255	Delrin	4-1/2	3-3/8	1-1/2	2F99040090001**
5	1-1/4	280	Delrin	5-1/2	4-1/8	2-1/4	2F99050090001**
DURAFOAM WHEEL							
2-1/2	1-1/4	175	Plain	3-5/16	2-1/4	1	2F99071270001**
3	1-1/4	210	Plain	3-5/8	2-3/8	1	2F99030270001**
4	1-1/4	255	Plain	4-1/2	3-3/8	1-1/4	2F99040270001**
5	1-1/4	280	Plain	5-1/2	4-1/8	1-1/2	2F99050270001**
POLY II POLY WHEEL							
3	1-1/4	210	Delrin	3-5/8	2-3/8	1	2F9903B270001**
3-1/2	1-1/4	250	Delrin	4-1/4	3-1/8	1-1/4	2F9909B270801**
4	1-3/8	275	Delrin	4-1/2	3-3/8	1-1/2	2F9904B270001**
5	1-3/8	280	Delrin	5-1/2	4-1/8	1-3/4	2F9905B270001**
POLY II URETHANE WHEEL							
3	1-1/4	210	Delrin	3-5/8	2-3/8	1	2F9903B250001**
3-1/2	1-1/4	250	Delrin	4-1/4	3-1/8	1-1/4	2F9909B250801**
4	1-1/4	275	Delrin	4-1/2	3-3/8	1-1/2	2F9904B250001**
5	1-1/4	280	Delrin	5-1/2	4-1/8	1-3/4	2F9905B250001**

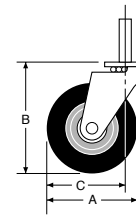

** NOTE: For your stem choice, replace ** in part number with stem code number shown in stem choices.

200 to 400 lb.
capacity
1³/₈" to 1¹/₂" wheel
tread width

Medium Duty Swivel and Rigid Plate Casters

MADE IN U.S.A.



STANDARD FEATURES

- Medium duty applications.
- Double row swivel construction.
- 3/8" diameter nut and bolt axle.
- Zinc-plated finish for corrosion resistance and appearance.
- Heat treat hardened and factory lubricated swivel raceways.





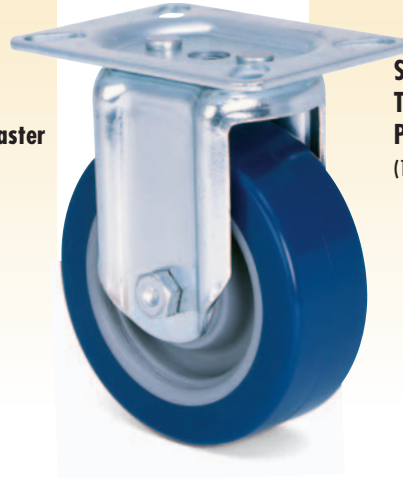

SERIES 1F28
Double Row
Swivel Plate Caster
(1F2804027000197)



SERIES 1F23
Two-Piece Rigid
Plate Caster
(1F2304B25000197)

OPTIONS Consult Factory

Wheel Brake	Thread Guards	Roller Bearing Wheels	Other
 <ul style="list-style-type: none"> • Side mount pinch type wheel brake available for all swivel models. 	 <ul style="list-style-type: none"> • Prevents objects from wrapping on wheel axle and obstructing rotation. • Cannot be used with wheel brake. • Available for most wheels. 	<p>For all Poly II wheel sizes and tread types.</p>  <p>Ball Bearing Wheels</p> <p>For all Poly II wheel sizes and tread types. Recommended for load capacities of under 250 lbs.</p> 	<p>Economical Rivet Axle Nickel-Plated Finish NSF Certified Casters</p> 

**** Plate Code Number**

Top Plate Choices



Overall Size 2-3/4" x 3-3/4"
Hole Spacing 1-3/4" x 3"
Hole Diameter 11/32"
Bolt Diameter 5/16"

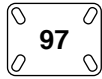

Overall Size 3-1/8" x 4-1/8"
Hole Spacing 1-3/4" x 3" to 2-3/8" x 3-3/8"
Hole Diameter 3/8" x 3/4" slots
Bolt Diameter 5/16"

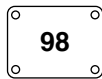

Overall Size 3-1/8" x 4-1/8"
Hole Spacing 2-3/8" x 3-7/16"
Hole Diameter 11/32"
Bolt Diameter 5/16"

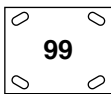

Overall Size 3-3/4" x 4-5/8"
Hole Spacing 2-5/8" x 3-5/8" to 3" x 3"
Hole Diameter 3/8" x 3/4" slots
Bolt Diameter 5/16"

Wheel Types



Cushionex Supreme
Black soft rubber tread molded to black hard rubber core.



Durafoam (Solid)
Black molded polypropylene.

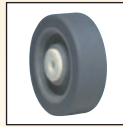

Poly II Rubber
Dark gray thermoplastic rubber tread molded to light gray polypropylene core.



Poly II Poly
Black polypropylene tread molded to black polypropylene core.



Spartan Supreme
Black hard rubber tread molded to black hard rubber core.



Poly II Urethane
Dark blue polyurethane tread molded to light gray polypropylene core.

SERIES 1F28 SWIVEL AND 1F23 RIGID PLATE CASTERS

A Wheel Dia. (inches)	Approximate Tread Width (inches)	Caster Capacity (pounds)	Wheel Bearing Type	B Height (inches)	C Swivel Radius* (inches)	Approximate Weight (pounds)	Swivel Caster Part No.	Rigid Caster Part No.
CUSHIONEX SUPREME WHEEL								
4	1-3/8	200	Delrin	5-1/16	3-3/8	2-1/2	1F28040040001**	1F23040040001**
5	1-3/8	240	Delrin	6-1/16	3-15/16	3	1F28050040001**	1F23050040001**
6	1-3/8	280	Delrin	7-1/16	4-15/16	4	1F28060040001**	1F23060040001**
POLY II RUBBER WHEEL								
4	1-1/2	200	Delrin	5-1/16	3-3/8	2	1F2804B260001**	1F2304B260001**
5	1-1/2	240	Delrin	6-1/16	3-15/16	2-1/4	1F2805B260001**	1F2305B260001**
6	1-1/2	280	Delrin	7-1/16	4-15/16	2-1/2	1F2806B260001**	1F2306B260001**
SPARTAN SUPREME WHEEL								
4	1-3/8	300	Delrin	5-1/16	3-3/8	2-1/2	1F28040090001**	1F23040090001**
5	1-3/8	350	Delrin	6-1/16	3-15/16	3	1F28050090001**	1F23050090001**
6	1-3/8	400	Delrin	7-1/16	4-15/16	4	1F28060090001**	1F23060090001**
DURAFOAM WHEEL								
4	1-3/8	300	Plain	5-1/16	3-3/8	2	1F28040270001**	1F23040270001**
5	1-3/8	350	Plain	6-1/16	3-15/16	2-1/4	1F28050270001**	1F23050270001**
6	1-3/8	400	Plain	7-1/16	4-15/16	2-3/4	1F28060270001**	1F23060270001**
POLY II POLY WHEEL								
4	1-3/8	375	Delrin	5-1/16	3-3/8	2	1F2804B270001**	1F2304B270001**
5	1-3/8	400	Delrin	6-1/16	3-15/16	2-1/4	1F2805B270001**	1F2305B270001**
6	1-3/8	400	Delrin	7-1/16	4-15/16	2-1/2	1F2806B270001**	1F2306B270001**
POLY II URETHANE WHEEL								
4	1-1/2	375	Delrin	5-1/16	3-3/8	2	1F2804B250001**	1F2304B250001**
5	1-1/2	400	Delrin	6-1/16	3-15/16	2-1/4	1F2805B250001**	1F2305B250001**
6	1-1/2	400	Delrin	7-1/16	4-15/16	2-1/2	1F2806B250001**	1F2306B250001**

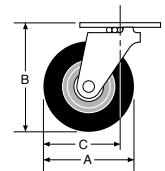

** NOTE: For your plate choice, replace ** in part number with plate code number shown in top plate choices.

200 to 400 lb.
capacity
1³/₈" to 1¹/₂" wheel
tread width

Medium Duty Swivel Stem Casters

MADE IN U.S.A.



STANDARD FEATURES

- **Medium duty applications.**
- **Double row swivel construction.**
- **3/8" diameter nut and bolt axle.**
- **Zinc-plated finish for corrosion resistance and appearance.**
- **Heat treat hardened and factory lubricated swivel raceways.**
- **Assembly wrench 1J000192797**



**SERIES 1F29
Double Row Swivel
Friction Ring Stem
Caster**
(1F2904004000137)



**SERIES 1F29
Double Row Swivel
Threaded Stem Caster**
(1F2904B26000110)

OPTIONS Consult Factory

Expandable Stem Adapters

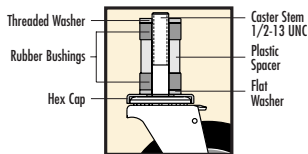

These stems will fit a variety of round and square tubing sizes. They feature a top-mounted, easily accessible hex cap for ease of assembly and tightening. The two rubber bushings permit easy tightening in tubing, while the plastic spacer adds stability to the assembly.

Specify stem code number 25 in caster part number. Casters and expandable stem kits can be ordered separately or factory can install expandable adapter onto the caster.

MEDIUM DUTY ADAPTERS (For 1F29 Series Casters)

Expandable Stem Kit Model No.	Fits Tubing I.D. Size
1F000233094	0.750" to 0.999"
1F000233194	1.000" to 1.249"
1F000233294	1.250" to 1.499"
1F000233394	1.500" to 1.749"

Wheel Brake



- Side mount pinch type wheel brake available for all swivel models.

Thread Guards



- Prevents objects from wrapping on wheel axle and obstructing rotation.
- Cannot be used with wheel brake.
- Available for most wheels.

Roller Bearing Wheels

For all Poly II wheel sizes and tread types.



Ball Bearing Wheels

For all Poly II wheel sizes and tread types. Recommended for load capacities of under 250 lbs.

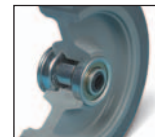

Other

- **Nickel-Plated Finish**
- **Economical Rivet Axle**
- **NSF Certified Casters**



**Rubber "O" Ring Swivel Raceway
Grease Seal**

Stem Choices

Friction Ring Stems

Stem Size Dia. x Length (D) (L)	** Stem Code Number
7/16 x 1-29/32	03
13/16 x 1-3/4	37
1 x 2-1/2	ZX

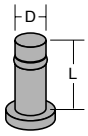

Threaded Stems

Stem Size Dia. x TPI x Length (D) (TPI) (L)	** Stem Code Number
1/2 - 13 x 3/4	06
1/2 - 13 x 1	61
1/2 - 13 x 1-1/2	10
5/8 - 18 x 1-1/2	45
3/4 - 10 x 1-1/2	ZT
Expandable	25

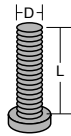

Octagon Stems

Stem Size Dia. x Length (D) (L)	Hole Size	Hole Location (A) (E)	** Stem Code Number
.750 x 2	3 @ .265"	1" .375"	74
.860 x 2	1 @ .265"	1" —	36

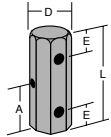

Other stem sizes available on request.

Wheel Types



Cushionex Supreme
Black soft rubber tread molded to black hard rubber core.



Durafoam (Solid)
Black molded polypropylene.



Poly II Rubber
Dark gray thermoplastic rubber tread molded to light gray polypropylene core.

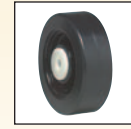

Poly II Poly
Black polypropylene tread molded to black polypropylene core.



Spartan Supreme
Black hard rubber tread molded to black hard rubber core.

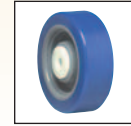

Poly II Urethane
Dark blue polyurethane tread molded to light gray polypropylene core.

SERIES 1F29 SWIVEL STEM CASTERS

A Wheel Dia. (inches)	Approximate Tread Width (inches)	Caster Capacity (pounds)	Wheel Bearing Type	B Height (inches)	C Swivel Radius (inches)	Approximate Weight (pounds)	Swivel Caster Part No.
CUSHIONEX SUPREME WHEEL							
4	1-3/8	200	Delrin	4-7/8	3-3/8	2-1/4	1F29040040001**
5	1-3/8	240	Delrin	5-7/8	3-15/16	2-3/4	1F29050040001**
6	1-3/8	280	Delrin	6-7/8	4-15/16	3-3/4	1F29060040001**
POLY II RUBBER WHEEL							
4	1-1/2	200	Delrin	4-7/8	3-3/8	1-3/4	1F2904B260001**
5	1-1/2	240	Delrin	5-7/8	3-15/16	2	1F2905B260001**
6	1-1/2	280	Delrin	6-7/8	4-15/16	2-1/4	1F2906B260001**
SPARTAN SUPREME WHEEL							
4	1-3/8	300	Delrin	4-7/8	3-3/8	2-1/4	1F29040090001**
5	1-3/8	350	Delrin	5-7/8	3-15/16	2-3/4	1F29050090001**
6	1-3/8	400	Delrin	6-7/8	4-15/16	3-3/4	1F29060090001**
DURAFOAM WHEEL							
4	1-3/8	300	Plain	4-7/8	3-3/8	1-3/4	1F29040270001**
5	1-3/8	350	Plain	5-7/8	3-15/16	2-3/4	1F29050270001**
6	1-3/8	400	Plain	6-7/8	4-15/16	2-1/2	1F29060270001**
POLY II POLY WHEEL							
4	1-3/8	375	Delrin	4-7/8	3-3/8	1-3/4	1F2904B270001**
5	1-3/8	400	Delrin	5-7/8	3-15/16	2	1F2905B270001**
6	1-3/8	400	Delrin	6-7/8	4-15/16	2-1/4	1F2906B270001**
POLY II URETHANE WHEEL							
4	1-1/2	375	Delrin	4-7/8	3-3/8	1-3/4	1F2904B250001**
5	1-1/2	400	Delrin	5-7/8	3-15/16	2	1F2905B250001**
6	1-1/2	400	Delrin	6-7/8	4-15/16	2-1/4	1F2906B250001**

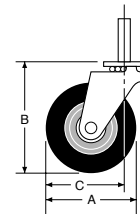

** NOTE: For your stem choice, replace ** in part number with stem code number shown in stem choices.

125 to 450 lb. capacity
1¼ to 1½" wheel tread width

Americaster™ Institutional Series Swivel and Rigid Plate Casters, Swivel Stem Casters

MADE IN U.S.A.



STANDARD FEATURES

- Medium duty applications.
- Double row swivel construction.
- 3/8" diameter nut and bolt axle.
- Delrin wheel bearing offers a long life due to its resistance to thermal and chemical deterioration.
- Zinc-plated finish for corrosion resistance and appearance.
- Heat treat hardened and factory lubricated swivel raceways.
- Assembly wrench **1J000192797**



SERIES 3F28
Swivel Plate Caster
(3F2804D040001AM)



SERIES 3F23
Two-piece Rigid Plate Caster
(3F2304B2500197)

OPTIONS Consult Factory

Expandable Stem Adapters

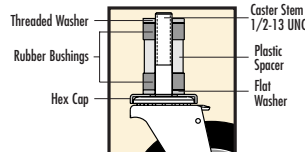

These stems will fit a variety of round and square tubing sizes. They feature a top-mounted, easily accessible hex cap for ease of assembly and tightening. The two rubber bushings permit easy tightening in tubing, while the plastic spacer adds stability to the assembly.

Specify stem code number 25 in caster part number. Casters and expandable stem kits can be ordered separately or factory can install expandable adapter onto the caster.

MEDIUM DUTY ADAPTERS (For 3F09 and 3F29 Series Casters)

Expandable Stem Kit Model No.	Fits Tubing I.D. Size
1F000233094	0.750" to 0.999"
1F000233194	1.000" to 1.249"
1F000233294	1.250" to 1.499"
1F000233394	1.500" to 1.749"

Wheel Brake



Positive lock wheel brake works equally well with all types of wheel bearings because it engages the top of the wheel tread rather than using a pinching type braking action. Available on wheel sizes from 3" to 6".

Not recommended for use with Semi-Steel wheels.

Wheel Bearings



Roller Bearings are best suited to heavy load applications. They provide optimum start-up and rolling ease at both high and low speeds.



Ball Bearings provide optimum start-up and rolling for capacities of 250 lbs. or less.

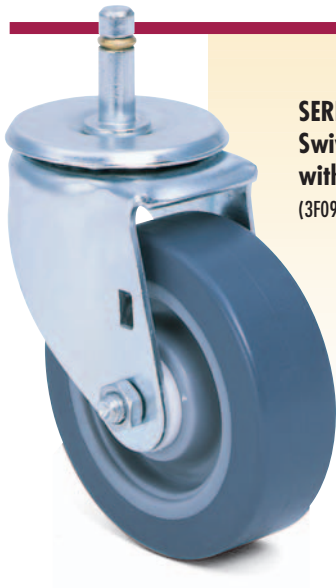

**SERIES 3F09
Swivel Stem Caster
with Dust Cover**
(3F09B4B26000101)

OPTIONS Consult Factory

**Grease Seal/
Dust Cover**



Dust cover and grease seal options are available on all swivel models. The dust cover provides protection from dust and water. The grease seals are designed to protect both the upper and lower raceways by keeping the lubricant in and dirt and moisture out. Offers the ultimate in swivel bearing protection ensuring optimum performance and durability.

Thread Guard



- Prevents objects from wrapping on wheel axle and obstructing rotation.
- Cannot be used with wheel brake.
- Available for most wheels.

Other
**Economical 3/8" Diameter Rivet
Axle**
Nickel-Plated Finish
NSF Certified Casters



Wheel Types



Cushionex Supreme
Black soft rubber tread molded to black hard rubber core.

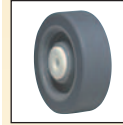

Poly II Rubber
Dark gray thermoplastic rubber tread molded to light gray polypropylene core.



Spartan Supreme
Black hard rubber tread molded to black hard rubber core.



Poly II Poly
Black polypropylene tread molded to black polypropylene core.

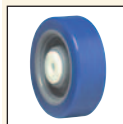

Poly II Urethane
Dark blue polyurethane tread molded to light gray polypropylene core.



Duratex Phenolic
Black phenolic resin reinforced with macerated fabric.



Semi-steel
Cast iron enriched with steel.



Poly II Wheel Design
"Interlocking tunnels" allow the wheel tread material to flow through wheel core channels when molded, providing a mechanical lock which prevents tread separation from the core.

Americaster specifications are shown on pages 26 and 27.

Americaster™ Institutional Series Swivel and Rigid Plate Casters, Swivel Stem Casters

Part Number with Standard Features

A Wheel Dia. (inches)	Approximate Tread Width (inches)	Caster Capacity (pounds)	Wheel Bearing Type	B Height (inches)	C Swivel Radius* (inches)	Approximate Weight (pounds)	Swivel Plate Caster Part No.	Rigid Plate Caster Part No.	Swivel Stem Caster Part No.
CUSHIONEX SUPREME WHEEL									
3-1/2	1-1/4	155	Delrin	4-5/8	3-3/16	2-1/4	3F0809D040001**	3F0309D040001**	3F0909D040001**
4	1-1/4	165	Delrin	5-1/8	3-3/8	2-1/2	3F0804D040001**	3F0304D040001**	3F0904D040001**
4	1-3/8	200	Delrin	5-3/8	3-3/8	2-3/4	3F2804D040001**	3F2304D040001**	3F2904D040001**
5	1-1/4	200	Delrin	6-1/4	3-15/16	3-1/4	3F0805D040001**	3F0305D040001**	3F0905D040001**
5	1-3/8	240	Delrin	6-3/8	3-15/16	3-1/2	3F2805D040001**	3F2305D040001**	3F2905D040001**
6	1-3/8	280	Delrin	7-3/8	4-7/16	4-1/2	3F2806D040001**	3F2306D040001**	3F2906D040001**
POLY II RUBBER WHEEL									
3	1-1/4	210	Delrin	4-3/8	2-15/16	1-3/4	3F0803B260801**	3F0303B260801**	3F0903B260801**
3-1/2	1-1/4	250	Delrin	4-5/8	3-3/16	2	3F0809B260001**	3F0309B260001**	3F0909B260001**
4	1-1/4	275	Delrin	5-1/8	3-3/8	2	3F0804B260001**	3F0304B260001**	3F0904B260001**
4	1-1/2	200	Delrin	5-3/8	3-3/8	2-1/4	3F2804B260001**	3F2304B260001**	3F2904B260001**
5	1-1/4	300	Delrin	6-1/4	3-15/16	2-1/2	3F0805B260001**	3F0305B260001**	3F0905B260001**
5	1-1/2	240	Delrin	6-3/8	3-15/16	2-3/4	3F2805B260001**	3F2305B260001**	3F2905B260001**
6	1-1/2	280	Delrin	7-3/8	4-7/16	3-1/4	3F2806B260001**	3F2306B260001**	3F2906B260001**
SPARTAN SUPREME WHEEL									
3-1/2	1-1/4	250	Delrin	4-5/8	3-3/16	2-1/4	3F0809D090001**	3F0309D090001**	3F0909D090001**
4	1-1/4	255	Delrin	5-1/8	3-3/8	2-1/2	3F0804D090001**	3F0304D090001**	3F0904D090001**
4	1-3/8	300	Delrin	5-3/8	3-3/8	2-3/4	3F2804D090001**	3F2304D090001**	3F2904D090001**
5	1-1/4	280	Delrin	6-1/4	3-15/16	3-1/4	3F0805D090001**	3F0305D090001**	3F0905D090001**
5	1-3/8	350	Delrin	6-3/8	3-15/16	3-1/2	3F2805D090001**	3F2305D090001**	3F2905D090001**
6	1-3/8	400	Delrin	7-3/8	4-7/16	4-1/2	3F2806D090001**	3F2306D090001**	3F2906D090001**
POLY II POLY WHEEL									
3	1-1/4	210	Delrin	4-3/8	2-15/16	1-3/4	3F0803B270801**	3F0303B270801**	3F0903B270801**
3-1/2	1-1/4	250	Delrin	4-5/8	3-3/16	2	3F0809B270001**	3F0309B270001**	3F0909B270001**
4	1-3/8	375	Delrin	5-1/8	3-3/8	2	3F0804B270001**	3F0304B270001**	3F0904B270001**
4	1-3/8	375	Delrin	5-3/8	3-3/8	2-1/4	3F2804B270001**	3F2304B270001**	3F2904B270001**
5	1-3/8	450	Delrin	6-1/4	3-15/16	2-1/2	3F0805B270001**	3F0305B270001**	3F0905B270001**
5	1-3/8	450	Delrin	6-3/8	3-15/16	2-3/4	3F2805B270001**	3F2305B270001**	3F2905B270001**
6	1-3/8	450	Delrin	7-3/8	4-7/16	3-1/4	3F2806B270001**	3F2306B270001**	3F2906B270001**
POLY II URETHANE WHEEL									
3	1-1/4	210	Delrin	4-3/8	2-15/16	1-3/4	3F0803B250801**	3F0303B250801**	3F0903B250801**
3-1/2	1-1/4	250	Delrin	4-5/8	3-3/16	2	3F0809B250001**	3F0309B250001**	3F0909B250001**
4	1-1/4	275	Delrin	5-1/8	3-3/8	2	3F0804B250001**	3F0304B250001**	3F0904B250001**
4	1-1/2	375	Delrin	5-3/8	3-3/8	2-1/4	3F2804B250001**	3F2304B250001**	3F2904B250001**
5	1-1/4	300	Delrin	6-1/4	3-15/16	2-1/2	3F0805B250001**	3F0305B250001**	3F0905B250001**
5	1-1/2	450	Delrin	6-3/8	3-15/16	2-3/4	3F2805B250001**	3F2305B250001**	3F2905B250001**
6	1-1/2	450	Delrin	7-3/8	4-7/16	3-1/4	3F2806B250001**	3F2306B250001**	3F2906B250001**
DURATEX WHEEL									
3	1-1/2	350	Roller	4-3/8	3-1/8	2-1/4	3F28034380801**	3F23034380801**	3F29034380801**
3(H)	1-1/2	300	Roller	4-3/8	3-1/8	2-1/4	3F28034340801**	3F23034340801**	3F29034340801**
4	1-1/2	450	Roller	5-3/8	3-3/8	2-3/4	3F28044380001**	3F23044380001**	3F29044380001**
4(H)	1-1/2	375	Roller	5-1/16	3-3/8	2-3/4	1F28044340001**	1F23044340001**	1F29044340001**
5	1-1/2	450	Roller	6-3/8	3-15/16	3-1/2	3F28054380001**	3F23054380001**	3F29054380001**
5(H)	1-1/2	400	Roller	6-1/16	3-15/16	3-1/2	1F28054340001**	1F23054340001**	1F29054340001**
6	1-1/2	450	Roller	7-3/8	4-7/16	4-1/4	3F28064380001**	3F23064380001**	3F29064380001**
SEMI-STEEL WHEEL									
3	1-1/4	450	Roller	4-3/8	2-15/16	2-3/4	3F08034110801**	3F03034110801**	3F09034110801**
4	1-1/2	450	Roller	5-3/8	3-3/8	3-3/4	3F28044110001**	3F23044110001**	3F29044110001**

** NOTE: For your plate or stem choice, replace ** in part number with plate or stem code number shown in top plate or stem choices.

(H) Wheel is high temperature phenolic with an operative range of 475°F continuous, 525°F intermittent.

OPTIONS Consult Factory

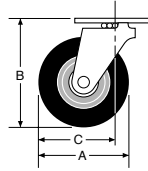

	B Height Option	Wheel	Bearing	Swivel Strap Brake	Swivel Dust Cover	Swivel Grease Seals	Wheel Hub Cap
		Roller	Ball*				
	None	No	No	Yes	Yes	Yes	No
	5-3/8	No	No	Yes	Yes	Yes	No
	5-1/8	Yes	No	Yes	Yes	Yes	No
	6-3/8	No	No	Yes	Yes	Yes	No
	6-1/4	Yes	No	Yes	Yes	Yes	No
	None	Yes	No	Yes	Yes	Yes	No
	None	No	No	Yes	Yes	Yes	No
	None	Yes	Yes	Yes	Yes	Yes	Yes
	5-3/8	Yes	Yes	Yes	Yes	Yes	Yes
	5-1/8	Yes	Yes	Yes	Yes	Yes	Yes
	6-3/8	Yes	Yes	Yes	Yes	Yes	Yes
	6-1/4	Yes	Yes	Yes	Yes	Yes	Yes
	None	Yes	Yes	Yes	Yes	Yes	No
	None	No	No	Yes	Yes	Yes	No
	5-3/8	No	No	Yes	Yes	Yes	No
	5-1/8	Yes	No	Yes	Yes	Yes	No
	6-3/8	No	No	Yes	Yes	Yes	No
	6-1/4	Yes	No	Yes	Yes	Yes	No
	None	Yes	No	Yes	Yes	Yes	No
	None	No	No	Yes	Yes	Yes	No
	None	Yes	Yes	Yes	Yes	Yes	Yes
	5-3/8	Yes	Yes	Yes	Yes	Yes	Yes
	5-1/8	Yes	Yes	Yes	Yes	Yes	Yes
	6-3/8	Yes	Yes	Yes	Yes	Yes	Yes
	6-1/4	Yes	Yes	Yes	Yes	Yes	Yes
	None	Yes	Yes	Yes	Yes	Yes	No
	None	No	No	Yes	Yes	Yes	No
	None	Yes	Yes	Yes	Yes	Yes	Yes
	5-3/8	Yes	Yes	Yes	Yes	Yes	Yes
	5-1/8	Yes	Yes	Yes	Yes	Yes	Yes
	6-3/8	Yes	Yes	Yes	Yes	Yes	Yes
	6-1/4	Yes	Yes	Yes	Yes	Yes	Yes
	None	Yes	Yes	Yes	Yes	Yes	No
	None	No	No	Yes	Yes	Yes	No
	None	N/A	No	Yes	Yes	Yes	No
	None	N/A	No	No	No	No	No
	5-1/8	N/A	No	Yes	Yes	Yes	No
	None	N/A	No	No	No	No	No
	6-1/4	N/A	No	Yes	Yes	Yes	No
	None	N/A	No	No	No	No	No
	None	N/A	No	Yes	Yes	Yes	No
	None	N/A	No	No	Yes	Yes	No
	5-1/8	N/A	No	No	Yes	Yes	No

* Ball bearings not recommended for load capacities exceeding 250 lbs.
Note: Swivel stem caster heights are 1/8" shorter than heights listed.

**** Plate Code Number**

Top Plate Choices



Overall Size 2-3/4" x 3-3/4"
Hole Spacing 1-3/4" x 3"
Hole Diameter 11/32"
Bolt Diameter 5/16"



Overall Size 2-3/4" x 3-3/4"
Hole Spacing 1-3/4" x 2-5/8" to 3"
Hole Diameter 11/32" x 1/2" slots
Bolt Diameter 5/16"



Overall Size 3-1/8" x 4-1/8"
Hole Spacing 1-3/4" x 3" to 2-3/8" x 3-3/8"
Hole Diameter 3/8" x 3/4" slots
Bolt Diameter 5/16"



Overall Size 3-1/8" x 4-1/8"
Hole Spacing 2-3/8" x 3-7/16"
Hole Diameter 11/32"
Bolt Diameter 5/16"



Overall Size 3-3/4" x 4-5/8"
Hole Spacing 2-5/8" x 3-5/8" to 3" x 3"
Hole Diameter 3/8" x 3/4" slots
Bolt Diameter 5/16"



Overall Size 4" x 5"
Hole Spacing 3" x 4"
Hole Diameter 13/32"
Bolt Diameter 3/8"

AS top plate is available for swivel casters only.

Stem Choices

Friction Ring Stems

Stem Size Dia. x Length (D) (L)	** Stem Code Number
7/16 x 1-3/8	01
7/16 x 1-29/32	03
5/8 x 2-3/16	ZW
13/16 x 1-3/4	37

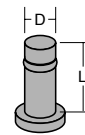

Threaded Stems

Stem Size Dia. x TPI x Length (D) (TPI) (L)	** Stem Code Number
3/8 - 16 x 1	04
3/8 - 16 x 1-1/2	07
7/16 - 14 x 7/8	23
7/16 - 14 x 1-1/2	05
1/2 - 13 x 3/4	06
1/2 - 13 x 1	61
1/2 - 13 x 1-1/2	10
Expandable	25

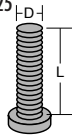

Octagon Stems

Stem Size Dia. x Length (D) (L)	Hole Size	Hole Location (A) (E)	Stem** Code Number
.750 x 2	3 @ .265"	1" .375"	74
.860 x 2	1 @ .265"	1" —	36

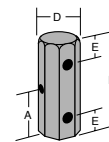

Other stem sizes available on request.

150 to 500 lb.
capacity
1³/₁₆" dual to 1³/₄"
wheel tread width

Low Profile Medium Duty Swivel and Rigid Plate, Swivel Stem Casters

STANDARD FEATURES



- **Medium duty applications.**
- **Double row swivel construction.**
- **3/8" diameter nut and bolt axle.**
- **Zinc-plated finish for corrosion resistance and appearance.**
(Optional black finish also available.)
- **Heat treat hardened and factory lubricated swivel raceways.**
- **Ideal for electronic and business machines, display stands and racks and other applications needing a high capacity, low height caster.**
- **Assembly wrench 1J000192797**

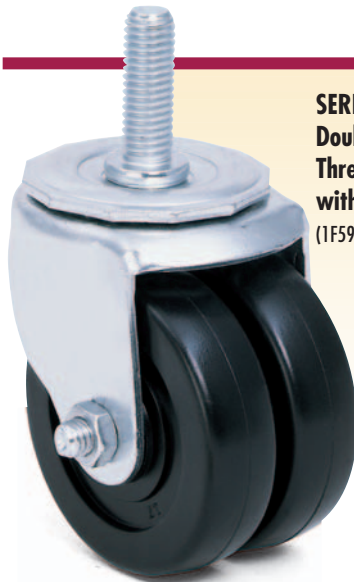

SERIES 1F59
Double Row Swivel
Threaded Stem Caster
with Dual Wheel
(1F5903704000110)

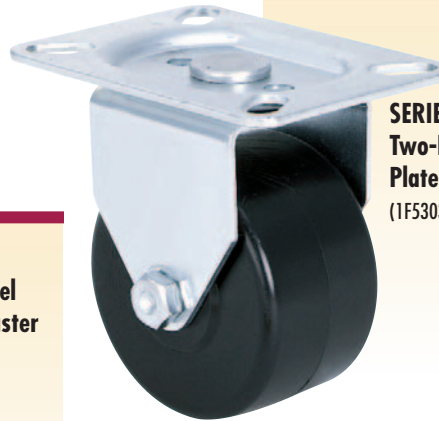

SERIES 1F53
Two-Piece Rigid
Plate Caster
(1F5303027000197)



SERIES 1F58
Double Row Swivel
Plate Caster
(1F5803438HD0197)



SERIES 1F58
Swivel Plate Caster
with Thread Guards
(1F5803K25001100)

No Brake Available

OPTIONS Consult Factory

Wheel Brake



- Side mount pinch type wheel brake available for 3" diameter wheel swivel casters.

Thumb Screw Wheel Brake



- Thumb screw type wheel brake available for all swivel models.



Cushionex Supreme
Black soft rubber tread molded to black hard rubber core.

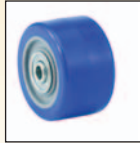

Poly II Urethane
Dark blue polyurethane tread molded to light gray polypropylene core. Standard ball and precision ball wheel bearings.



Spartan Supreme
Black hard rubber tread molded to black hard rubber core.



Durafoam (Solid)
Black molded polypropylene.



Duratex
Black phenolic resin reinforced with macerated fabric.

Stem Choices

Friction Ring Stems

Stem Size Dia. x Length (D) (L)	** Stem Code Number
7/16 x 1-3/8	01
13/16 x 1-3/4	37

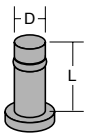

Threaded Stems

Stem Size Dia. x TPI x Length (D) (TPI) (L)	** Stem Code Number
1/2 - 13 x 3/4	06
1/2 - 13 x 1-1/2	10
1/2 - 13 x 2-1/2	18
leveling stem	

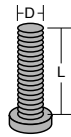

Other stem sizes available on request.

** Plate Code Number

Top Plate Choices



Overall Size 2-3/4" x 3-3/4"
Hole Spacing 1-3/4" x 3"
Hole Diameter 11/32"
Bolt Diameter 5/16"



Overall Size 3-1/8" x 4-1/8"
Hole Spacing 1-3/4" x 3" to 2-3/8" x 3-3/8"
Hole Diameter 3/8" x 3/4" slots
Bolt Diameter 5/16"



Overall Size 3-3/4" x 4-5/8"
Hole Spacing 2-5/8" x 3-5/8" to 3" x 3"
Hole Diameter 3/8" x 3/4" slots
Bolt Diameter 5/16"

Other top plate sizes available (AM swivel, 98).

A Wheel Dia. (inches)	Approximate Tread Width (inches)	Caster Capacity (pounds)	Wheel Bearing Type	B Height (inches)	C Swivel Radius* (inches)	Approximate Weight (pounds)	Swivel Plate Caster Part No.	Rigid Plate Caster Part No.	Swivel Stem Caster Part No.
CUSHIONEX SUPREME DUAL WHEEL									
2	13/16 ea.	150	Delrin	2-15/16	1-7/8	1-1/2	1F58027040001**	1F53027040001**	1F59027040001**
2-1/2	13/16 ea.	175	Delrin	3-1/2	2-7/32	1-3/4	1F58077040001**	1F53077040001**	1F59077040001**
3	13/16 ea.	250	Delrin	3-7/8	2-1/4	1-3/4	1F58037040001**	1F53037040001**	1F59037040001**
POLY II URETHANE SINGLE WHEEL (THREAD GUARDS)									
3	1-3/4	250	Standard Ball	3-7/8	2-1/4	2	1F5803A250011**	1F5303A250011**	1F5903A250011**
3	1-3/4	450	Precision Ball	3-7/8	2-1/4	2	1F5803K250011**	1F5303K250011**	1F5903K250011**
SPARTAN SUPREME DUAL WHEEL									
2	13/16 ea.	200	Delrin	2-15/16	1-7/8	1-1/2	1F58027090001**	1F53027090001**	1F59027090001**
2-1/2	13/16 ea.	300	Delrin	3-1/2	2-7/32	1-3/4	1F58077090001**	1F53077090001**	1F59077090001**
3	13/16 ea.	350	Delrin	3-7/8	2-1/4	1-3/4	1F58037090001**	1F53037090001**	1F59037090001**
DURAFOAM SINGLE WHEEL									
2-1/2	1-3/4	300	Plain	3-1/2	2-7/32	1-1/2	1F58070270001**	1F53070270001**	N/A
3	1-3/4	350	Sintered	3-7/8	2-1/4	1-1/2	1F58030270001**	1F53030270001**	1F59030270001**
3	1-3/4	350	Roller	3-7/8	2-1/4	1-1/2	1F58034270001**	1F53034270001**	1F59034270001**
DURATEX SINGLE WHEEL									
2-1/2	1-3/4	300	Roller	3-1/2	2-7/32	1-3/4	1F58074380001**	1F53074380001**	1F59074380001**
2-5/8	1-3/4	350	Roller	3-9/16	2-1/4	1-3/4	1F58014380001**	1F53014380001**	1F59014380001**
3	1-13/16	500	Roller	3-7/8	2-1/4	2-1/4	1F58034380001**	1F53034380001**	1F59034380001**

** NOTE: For your plate or stem choice, replace ** in part number with plate or stem code number shown in top plate or stem choices.

Note: Swivel stem caster heights are 1/8" shorter than heights listed.

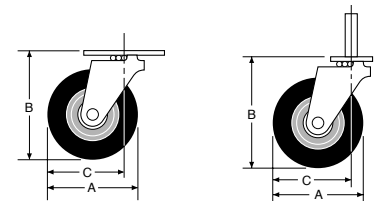

Medium-Heavy Duty Casters

300 to 700 lb.
capacity
2" wheel tread
width

Medium-Heavy Duty Total Lock Swivel, Swivel and Rigid Plate Casters

MADE IN U.S.A.



These casters offer a unique combination of high load capacity with a trailing edge total lock brake. Their load capacity is exceptional for a top plate with bolt hole spacing of 1-3/4" x 3."



SERIES 4F88
Swivel Caster
with Total Lock Brake
(shown with
optional thread
guards)
(4F8805C2500F190)



SERIES 4F88
Swivel Caster
(4F8805C26000190)

SERIES 4F83
Rigid Caster
(4F8305C27000190)

STANDARD FEATURES

- Ideal for food handling and processing equipment, mobile tool chests and work benches, platform and stock trucks, carts and dollies, laundry and refuse hampers and trucks, and more.
- Bright chromed zinc finish.
- High strength double ball, hardened swivel raceways for long caster service life.
- Roller bearing wheel and 1/2" nut and bolt axle with grease zerk fitting.
- All swivel casters have a unique upper race which also serves as a dust cover to block out contaminants.
- Swivel caster with total lock brake simultaneously locks brake and swivel.

** Plate Code
Number

Top Plate Choices

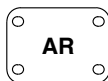

Overall Size 2-3/4" x 3-3/4"
Hole Spacing 1-3/4" x 2-7/8" to 3"
Hole Diameter 11/32" x 13/32" slots
Bolt Diameter 5/16"

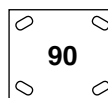

Overall Size 4" x 4-1/2"
Hole Spacing 2-5/8" x 3-5/8" to 3" x 3"
Hole Diameter 3/8" x 3/4" slots
Bolt Diameter 3/8"

OPTIONS

Other Wheel Colors

Wheel Type	Tread Color	Hub Color
Poly II Urethane	Blue	White
Poly II Rubber	Gray	White
Mold-On Polyurethane	Blue	Aluminum

Delrin Bearing Wheels



Wheel Thread Guards

NSF Certified Casters available

E.R. Wagner
CASTERS & WHEELS Manufacturing Co.

Wheel Types



Mold-On Rubber
Black soft rubber tread bonded to a cast aluminum core.



Poly II Poly
Black polypropylene tread molded to black polypropylene core.



Poly II Rubber
Black thermoplastic rubber tread molded to gray polypropylene core.



Mold-On Polyurethane
Red polyurethane tread molded to an aluminum core.



Poly II Urethane
Red polyurethane tread molded to gray polypropylene core.



Duratex
Black phenolic resin reinforced with macerated fabric.

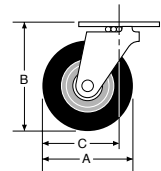

SERIES 4F88 SWIVEL AND 4F83 RIGID PLATE CASTERS

A Wheel Dia. (inches)	Approximate Tread Width (inches)	Caster Capacity (pounds)	Wheel Bearing Type	B Height (inches)	C Swivel Radius* (inches)	Approximate Weight (pounds)	Total Lock Swivel Caster Part No.	Swivel Caster Part No.	Rigid Caster Part No.
MOLD-ON RUBBER WHEEL									
5	2	350	Roller	6-1/2	5-1/2	5	4F88055140071**	4F88055140001**	4F83055140001**
6	2	400	Roller	7-1/2	5-1/2	5-1/2	4F88065140071**	4F88065140001**	4F83065140001**
POLY II RUBBER WHEEL									
4	2	300	Roller	5-5/8	5-1/2	3-3/4	4F8804C260071**	4F8804C260001**	4F8304C260001**
5	2	350	Roller	6-1/2	5-1/2	4-1/4	4F8805C260071**	4F8805C260001**	4F8305C260001**
6	2	400	Roller	7-1/2	5-1/2	4-3/4	4F8806C260071**	4F8806C260001**	4F8306C260001**
POLY II URETHANE WHEEL									
4	2	600	Roller	5-5/8	5-1/2	3-3/4	4F8804C250071**	4F8804C250001**	4F8304C250001**
5	2	650	Roller	6-1/2	5-1/2	4-1/4	4F8805C250071**	4F8805C250001**	4F8305C250001**
6	2	700	Roller	7-1/2	5-1/2	4-3/4	4F8806C250071**	4F8806C250001**	4F8306C250001**
POLY II POLY WHEEL									
4	2	400	Roller	5-5/8	5-1/2	3-3/4	4F8804C270071**	4F8804C270001**	4F8304C270001**
5	2	450	Roller	6-1/2	5-1/2	4-1/4	4F8805C270071**	4F8805C270001**	4F8305C270001**
6	2	560	Roller	7-1/2	5-1/2	4-3/4	4F8806C270071**	4F8806C270001**	4F8306C270001**
MOLD-ON POLYURETHANE WHEEL									
4	2	600	Roller	5-5/8	5-1/2	4-1/2	4F88045250071**	4F88045250001**	4F83045250001**
5	2	650	Roller	6-1/2	5-1/2	5	4F88055250071**	4F88055250001**	4F83055250001**
6	2	700	Roller	7-1/2	5-1/2	5-1/2	4F88065250071**	4F88065250001**	4F83065250001**
DURATEX (PHENOLIC) WHEEL									
4	2	600	Roller	5-5/8	5-1/2	4-1/2	4F88044380071**	4F88044380001**	4F83044380001**
5	2	650	Roller	6-1/2	5-1/2	5	4F88054380071**	4F88054380001**	4F83054380001**
6	2	700	Roller	7-1/2	5-1/2	6	4F88064380071**	4F88064380001**	4F83064380001**

* Swivel Radius represents a swivel caster with Total Lock Brake (Non Brake versions will be less). Weight represents a swivel caster with Total Lock Brake (Non Brake and Rigid Versions will be less).

** NOTE: For your plate choice, replace ** in part number with plate code number shown in top plate choices.

300 to 1200 lb. capacity 2" wheel tread width

Heavy Duty Swivel & Rigid Plate Casters with Total-Lock Brake or 4-Position Swivel Lock

STANDARD FEATURES

- Medium to heavy duty applications.
- Double row swivel construction with extra large raceways for long service life.
- 1/2" dia. nut & bolt grease fitting axle. (Powder coat finish casters have a stainless steel axle without grease zerk.)
- Chromed zinc-plated finish for corrosion resistance and appearance.
- Heat treat hardened and factory lubricated swivel raceways with swivel ease fitting.
- 1/4" thick steel top plate and welded leg construction.
- 3/4" dia. swivel kingpin rivet.



SERIES 1F83
Rigid Plate Caster

(1F8306C25000190)



SERIES 1F88
Swivel with Total-Lock Brake and optional yellow chromate zinc finish

(1F8806514007D90)



SERIES 1F88
Swivel Plate Caster

(1F8806438000190)



SERIES 1F88 Swivel with 4-Position Swivel Lock and optional yellow chromate zinc finish

(1F880662500DD90)

OPTIONS Consult Factory

Side Cam Type Wheel Brake



- Side mount wheel brake available for all swivel models.
- Standard size foot lever.

Finishes

Yellow Chromate Zinc

- Withstands 100 hrs. salt spray corrosion test.

Powder Coat

- Withstands 750 hrs. salt spray corrosion test.



Grease Seals



Upper and/or Lower Swivel Raceway

(Total lock and four-position lock available only with upper seal.)

Thread Guards



Delrin Bearings



SWIVEL WITH TOTAL-LOCK BRAKE

- Foot-operated lever simultaneously locks wheel and swivel.
- Castered equipment held firmly in place.
- Upward pressure on lever releases brakes.

SWIVEL WITH FOUR-POSITION SWIVEL LOCK

- Caster swivel locks in 90° increments.
- Downward pressure on lever engages lock; upward pressure releases lock.



Wheel Types



Mold-On Rubber
Black soft rubber tread bonded to a cast aluminum core.



Poly II Poly
Black polypropylene tread molded to black polypropylene core.



Mold-On Polyurethane
Red polyurethane tread molded to an aluminum core.



Poly II Rubber
Black thermoplastic rubber tread molded to light gray polypropylene core.

Other Wheel Colors		
Wheel Type	Tread Color	Hub Color
Poly II Urethane	Blue	White
Poly II Rubber	Light Gray	White
Mold-On Polyurethane	Blue	Aluminum



Duratex
Black phenolic resin reinforced with macerated fabric.



Poly II Urethane
Red polyurethane tread molded to light gray polypropylene core.



Semi-Steel
Cast iron enriched with steel.

**** Plate Code Number**

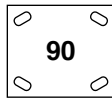
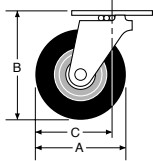

90 Top Plate
Overall Size 4" x 4-1/2"
Hole Spacing 2-5/8" x 3-5/8" to 3" x 3"
Hole Diameter 3/8" x 3/4" slots
Bolt Diameter 3/8"

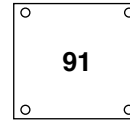

91 Top Plate
Overall Size 5" x 5-1/2"
Hole Spacing 4-1/8" x 4-1/2"
Hole Diameter 25/64"
Bolt Diameter 3/8"

SERIES 1F88, 1FA8 SWIVEL AND 1F83 RIGID PLATE CASTERS

A Wheel Dia. (inches)	Approximate Tread Width (inches)	Caster Capacity (pounds)	Wheel Bearing Type	B Height (inches)	C Swivel Radius* (inches)	Approximate Weight (pounds)†	Swivel Caster Part No.	Rigid Caster Part No.	Total Lock Swivel Part No.	4-Position Lock Swivel Part No.
MOLD-ON RUBBER WHEEL										
4	2	300	Roller	5-5/8	3-7/16	5-3/4	1F88045140001**	1F83045140001**	N/A	N/A
5	2	350	Roller	6-1/2	4-1/8	6-1/4	1F88055140001**	1F83055140001**	1F88055140071**	1F880551400D1**
6	2	410	Roller	7-1/2	4-7/8	6-3/4	1F88065140001**	1F83065140001**	1F88065140071**	1F880651400D1**
8	2	500	Roller	9-1/2	6-1/8	8-1/4	1FA8085140001**	1F83085140001**	1FA8085140071**	1FA80851400D1**
POLY II RUBBER WHEEL										
4	2	300	Roller	5-5/8	3-7/16	5	1F8804C260001**	1F8304C260001**	N/A	N/A
5	2	325	Roller	6-1/2	4-1/8	5-3/4	1F8805C260001**	1F8305C260001**	1F8805C260071**	1F8805C2600D1**
6	2	400	Roller	7-1/2	4-7/8	6-1/4	1F8806C260001**	1F8306C260001**	1F8806C260071**	1F8806C2600D1**
8	2	475	Roller	9-1/2	6-1/8	7-1/2	1FA808C260001**	1F8308C260001**	1FA808C260071**	1FA808C2600D1**
POLY II POLY WHEEL										
4	2	400	Roller	5-5/8	3-7/16	5	1F8804C270001**	1F8304C270001**	N/A	N/A
5	2	650	Roller	6-1/2	4-1/8	5-3/4	1F8805C270001**	1F8305C270001**	1F8805C270071**	1F8805C2700D1**
6	2	700	Roller	7-1/2	4-7/8	6-1/4	1F8806C270001**	1F8306C270001**	1F8806C270071**	1F8806C2700D1**
8	2	900	Roller	9-1/2	6-1/8	6-3/4	1FA808C270001**	1F8308C270001**	1FA808C270071**	1FA808C2700D1**
POLY II URETHANE WHEEL										
4	2	600	Roller	5-5/8	3-7/16	5	1F8804C250001**	1F8304C250001**	N/A	N/A
5	2	750	Roller	6-1/2	4-1/8	5-3/4	1F8805C250001**	1F8305C250001**	1F8805C250071**	1F8805C2500D1**
6	2	900	Roller	7-1/2	4-7/8	6-1/4	1F8806C250001**	1F8306C250001**	1F8806C250071**	1F8806C2500D1**
8	2	900	Roller	9-1/2	6-1/8	7-1/2	1FA808C250001**	1F8308C250001**	1FA808C250071**	1FA808C2500D1**
MOLD-ON POLYURETHANE WHEEL										
4	2	700	Roller	5-5/8	3-7/16	5-3/4	1F88045250001**	1F83045250001**	N/A	N/A
5	2	1050	Roller	6-1/2	4-1/8	7-1/2	1F88055250001**	1F83055250001**	1F88055250071**	1F880552500D1**
6	2	1200	Roller	7-1/2	4-7/8	8	1F88065250001**	1F83065250001**	1F88065250071**	1F880652500D1**
8	2	1200	Roller	9-1/2	6-1/8	8-3/4	1FA8085250001**	1F83085250001**	1FA8085250071**	1FA80852500D1**
DURATEX (PHENOLIC) WHEEL										
4	2	800	Roller	5-5/8	3-7/16	5-3/4	1F88044380001**	1F83044380001**	N/A	N/A
4 (H)	2	600	Roller	5-5/8	3-7/16	5-3/4	1F88044340001**	1F83044340001**	N/A	N/A
5	2	1000	Roller	6-1/2	4-1/8	6	1F88054380001**	1F83054380001**	1F88054380071**	1F880543800D1**
5 (H)	2	750	Roller	6-1/2	4-1/8	6	1F88054340001**	1F83054340001**	N/A	N/A
6	2	1200	Roller	7-1/2	4-7/8	7	1F88064380001**	1F83064380001**	1F88064380071**	1F880643800D1**
6 (H)	2	900	Roller	7-1/2	4-7/8	7	1F88064340001**	1F83064340001**	N/A	N/A
8	2	1200	Roller	9-1/2	6-1/8	9	1FA8084380001**	1F83084380001**	1FA8084380071**	1FA80843800D1**
SEMI-STEEL WHEEL										
4	2	1000	Roller	5-5/8	3-7/16	9	1F88044110001**	1F83044110001**	N/A	N/A
5	2	1000	Roller	6-1/2	4-1/8	9-1/2	1F88054110001**	1F83054110001**	1F88054110071**	1F880541100D1**
6	2	1200	Roller	7-1/2	4-7/8	10	1F88064110001**	1F83064110001**	1F88064110071**	1F880641100D1**
8	2	1200	Roller	9-1/2	6-1/8	14	1FA8084110001**	1F83084110001**	1FA8084110071**	1FA80841100D1**

* Swivel radius is for standard swivel. (Total Lock Brake and 4-Position Lock Swivel radius is greater.)

† Weight is standard swivel. (Rigid is lighter, Lock versions are heavier.)

(H) High temperature phenolic

**** NOTE:** For your plate choice, replace ** in part number with plate code number shown in top plate choices.

Heavy Duty Casters

300 to 1200 lb.
capacity 2" wheel
tread width

Heavy Duty Value Casters

Swivel Caster with Trailing End Brake
8W8808C2500T190



Swivel Caster with Over-the-Wheel Strap Brake
8W8805438005190



Swivel Caster
8W8805514000190



STANDARD FEATURES

- Heat treat hardened and factory lubricated swivel raceways with an upper raceway zerk grease fitting.
- All casters have 1/4" top plate and welded leg construction with a clear zinc chromate finish.
- All casters have 1/2" nut and bolt axle with a zerk grease fitting and a roller bearing wheel.
- Options: side cam brake, over-the-wheel strap brake, trailing end brake, field installed bolt-on 4-position swivel lock.

SERIES 8W88 SWIVEL AND 8W83 RIGID PLATE CASTERS

A	Approximate Tread Width (inches)	Caster Capacity (pounds)	Wheel Bearing Type	B	C	Approximate Weight (pounds)†	Swivel Part No.	Rigid Part No.
MOLD-ON RUBBER WHEEL								
5	2	350	Roller	6-1/2	4-1/8	6-1/4	8W8805514000190	8W8305514000190
6	2	410	Roller	7-1/2	4-7/8	6-3/4	8W8806514000190	8W8306514000190
8	2	500	Roller	9-1/2	6-3/16	8-1/4	8W8808514000190	8W8308514000190
POLY II RUBBER WHEEL								
4	2	300	Roller	5-5/8	3-7/16	5	8W8804C26000190	8W8304C26000190
5	2	325	Roller	6-1/2	4-1/8	5-3/4	8W8805C26000190	8W8305C26000190
6	2	400	Roller	7-1/2	4-7/8	6-1/4	8W8806C26000190	8W8306C26000190
8	2	475	Roller	9-1/2	6-3/16	7-1/2	8W8808C26000190	8W8308C26000190
POLY II URETHANE WHEEL								
4	2	600	Roller	5-5/8	3-7/16	5	8W8804C25000190	8W8304C25000190
5	2	750	Roller	6-1/2	4-1/8	5-3/4	8W8805C25000190	8W8305C25000190
6	2	900	Roller	7-1/2	4-7/8	6-1/4	8W8806C25000190	8W8306C25000190
8	2	900	Roller	9-1/2	6-3/16	7-1/2	8W8808C25000190	8W8308C25000190
POLY II POLY WHEEL								
4	2	400	Roller	5-5/8	3-7/16	5	8W8804C27000190	8W8304C27000190
5	2	650	Roller	6-1/2	4-1/8	5-3/4	8W8805C27000190	8W8305C27000190
6	2	700	Roller	7-1/2	4-7/8	6-1/4	8W8806C27000190	8W8306C27000190
8	2	800	Roller	9-1/2	6-3/16	7-1/2	8W8808C27000190	8W8308C27000190
DURATEX PHENOLIC WHEEL								
4	2	800	Roller	5-5/8	3-7/16	5-3/4	8W8804438000190	8W8304438000190
5	2	1000	Roller	6-1/2	4-1/8	6	8W8805438000190	8W8305438000190
6	2	1200	Roller	7-1/2	4-7/8	7	8W8806438000190	8W8306438000190
8	2	1200	Roller	9-1/2	6-3/16	9	8W8808438000190	8W8308438000190
SEMI-STEEL WHEEL								
4	2	1000	Roller	5-5/8	3-7/16	9	8W8804411000190	8W8304411000190
5	2	1000	Roller	6-1/2	4-1/8	9-1/2	8W8805411000190	8W8305411000190
6	2	1200	Roller	7-1/2	4-7/8	10	8W8806411000190	8W8306411000190
8	2	1200	Roller	9-1/2	6-3/16	14	8W8808411000190	8W8308411000190

† Weight is standard swivel. (Rigid is lighter.)

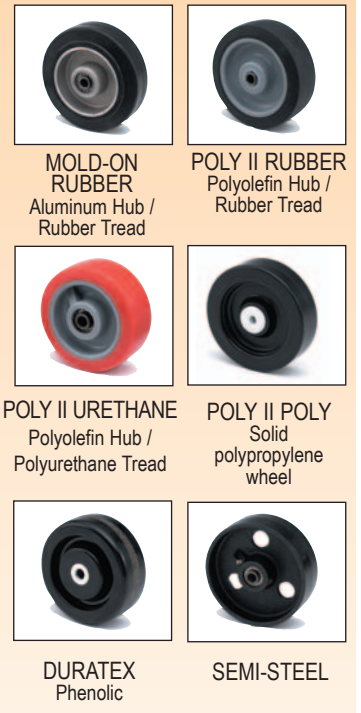

MOLD-ON RUBBER
Aluminum Hub / Rubber Tread

POLY II RUBBER
Polyolefin Hub / Rubber Tread

POLY II URETHANE
Polyolefin Hub / Polyurethane Tread

POLY II POLY
Solid polypropylene wheel

DURATEX
Phenolic

SEMI-STEEL

90 Plate Dimensions

Overall Size: 4 x 4-1/2"
Hole Spacing: 2-5/8 x 3-5/8
slotted to 3 x 3"
Bolt Dia: 3/8"

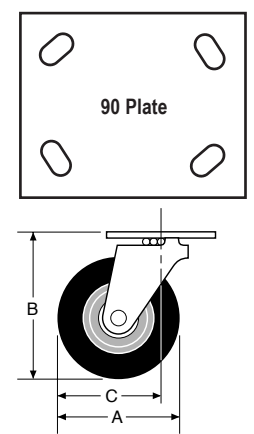

Heavy Duty Kingpinless Style Casters

1600 to 2000 lb.
capacity 2-1/2" wheel
tread width

Polyurethane on Cast Iron Hub Swivel Caster
8FXA06J250001AY



STANDARD FEATURES

- Clear zinc plated for corrosion resistance.
- 3/8" single row precision ball bearings in a high strength, through hardened 2-1/4" diameter raceway.
- Raceway has a zerk grease fitting for easy maintenance.
- 3/4" wheel axle with a lubrication fitting.
- Wheels have 1" straight roller bearing that rotates on a hardened spanner bushing.
- 4-Position bolt-on field installed swivel lock available.
- 1/4" Heavy duty legs welded both inside and out.
- Mounting plate thickness 1/4".
- Choice of wheels: Polyurethane on Cast Iron Hub, Phenolic, Cast Iron.



CAST IRON



DURATEX
Phenolic

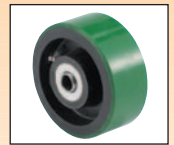

POLYURETHANE
ON CAST IRON
HUB

Polyurethane Tread/
Cast Iron Hub

Cross section of kingpinless style raceway

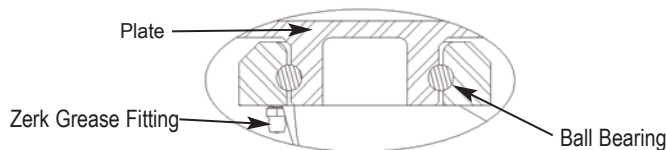

AY PLATE DIMENSIONS

Overall Size: 4-1/2 x 6-5/16"
Hole Spacing: 2-7/16 x 4-15/16
slotted to 3-3/8 x 5-1/4"
Bolt Dia: 1/2"

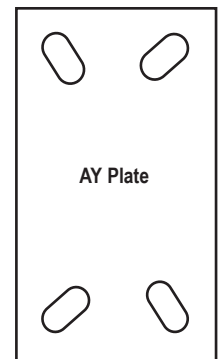

A Wheel Dia. (inches)	Approximate Tread Width (inches)	Caster Capacity (pounds)	Wheel Bearing Type	B Height (inches)	C Swivel Radius (inches)	Approximate Weight (pounds)†	Swivel Part No.	Rigid Part No.
POLYURETHANE ON CAST IRON HUB WHEEL								
6	2-1/2	1600	Roller	7-1/2	5-1/16	16-1/2	8FXA06J250001AY	8FX306J250001AY
8	2-1/2	1800	Roller	10-1/8	6-5/16	18-1/2	8FXA08J250001AY	8FX308J250001AY
10	2-1/2	2000	Roller	11-1/2	7-9/16	21-1/2	8FXA0TJ250001AY	8FX30TJ250001AY
DURATEX PHENOLIC WHEEL								
6	2-1/2	1600	Roller	7-1/2	5-1/16	12-1/2	8WXA064380001AY	8WX3064380001AY
8	2-1/2	2000	Roller	10-1/8	6-5/16	15	8WXA084380001AY	8WX3084380001AY
10	2-1/2	2000	Roller	11-1/2	7-9/16	16-1/2	8WXA0T4380001AY	8WX30T4380001AY
CAST IRON WHEEL								
5	2-1/2	2000	Roller	6-1/2	4-5/16	18	8FXA054110001AY	8FX3054110001AY
6	2-1/2	2000	Roller	7-1/2	5-1/16	17	8FXA064110001AY	8FX3064110001AY
8	2-1/2	2000	Roller	10-1/8	6-5/16	23	8FXA084110001AY	8FX3084110001AY
10	2-1/2	2000	Roller	11-1/2	7-9/16	25-1/2	8FXA0T4110001AY	8FX30T4110001AY

† Weight is standard swivel. (Rigid is lighter.)

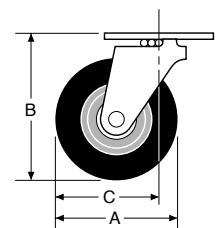

Twin Wheel Casters



STANDARD FEATURES

- Center Bar type casters.
- Nylon wheel tread.
- Load capacities from 125 to 150 lbs.
- Easy rolling and modern design.
- Brake caster has a lever. Push lever down to engage, pull up to disengage.
- All mounting top plates use 5/16" mounting bolt.
- Special sizes and colors may be available based on quantity, contact your E.R. Wagner sales representative for details.



Threaded Stem
1/2-13 x 1"

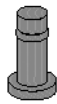

Friction Ring Stem
7/16 x 1-1/4"

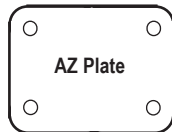

AZ Plate

AZ Plate Dimensions

Overall Size: 2-5/16" x 2-9/16"
Hole Spacing: 1-5/8" x 2"
Bolt Diameter: 5/16"

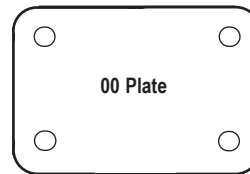

00 Plate

00 Plate Dimensions

Overall Size: 2-3/4" x 3-3/4"
Hole Spacing: 1-3/4" x 3"
Hole Diameter: 11/32"
Bolt Diameter: 5/16"

Wheel Diameter (mm/inches)	Overall Width (mm/inches)	Caster Capacity (pounds)	Overall Height (inches)	Approximate Weight (pounds)	Mounting Dimensions	Swivel Caster Part No.	Swivel Caster with Brake Part No.
STANDARD CASTER HAS BLACK NYLON BODY AND TREAD							
75 MM 3"	62.5 MM 2-15/32"	125	3-3/16	1.4	Friction Ring Stem	8FTS75111110030	8FTS75111120030
			3-17/64	1.4	Threaded Stem	8FTS75111110061	8FTS75111120061
			3-33/64	1.8	AZ Top Plate	8FTP751111100AZ	8FTP751111200AZ
100 MM 4"	73.5 MM 2-57/64"	140	4-1/4	1.6	Friction Ring Stem	8FTS10111110030	8FTS10111120030
			4-21/64	1.6	Threaded Stem	8FTS10111110061	8FTS10111120061
			4-19/32	2.0	AZ Top Plate	8FTP101111100AZ	8FTP101111200AZ
			4-19/32	2.0	00 Top Plate	8FTP10111110000	8FTP10111120000
125 MM 5"	86.5 MM 3-13/32"	150	5-23/64	1.8	Friction Ring Stem	8FTS25111110030	8FTS25111120030
			5-7/16	1.8	Threaded Stem	8FTS25111110061	8FTS25111120061
			5-23/32	2.2	AZ Top Plate	8FTP251111100AZ	8FTP251111200AZ
			5-23/32	2.2	00 Top Plate	8FTP25111110000	8FTP25111120000

Special Thread Guard Casters

MADE IN U.S.A.



Special Thread Guard Caster
(2F6853027081100)



Special Thread Guard Caster

Threads are teed-up away from the axle by the thread guard deflectors. Just snip away the thread accumulation.



Conventional Caster

Thread build-up jams casters, causing loss of cart use and costly maintenance or replacement.

STANDARD FEATURES

- Thread deflector prevents threads from tangling around the axle. Keeps wheels operating smoothly and helps with thread removal.
- Light duty applications.
- Double row swivel construction.
- 5/16" diameter rivet axle.
- Zinc-plated finish for corrosion resistance and appearance.
- Heat treat hardened and factory lubricated swivel raceways.

Stem Choices

Friction Ring Stems

Stem Size Dia. x Length (D) (L)	** Stem Code Number
7/16 x 1-3/8	01

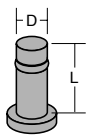

Other stem sizes available on request.

Threaded Stems

Stem Size Dia. x TPI x Length (D) (TPI) (L)	** Stem Code Number
3/8 - 16 x 1	04
3/8 - 24 x 1	89
1/2 - 13 x 1-1/2	10

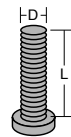

Wheel Type



Durafoam (Solid)
Black molded polypropylene.

Top Plate

Overall Size 2-3/4" x 3-3/4"
Hole Spacing 1-3/4" x 3"
Hole Diameter 11/32"
Bolt Diameter 5/16"



Other top plate sizes available on request.

A Wheel Dia. (inches)	Approximate Tread Width (inches)	Caster Capacity (pounds)	Wheel Bearing Type	B Height (inches)	C Swivel Radius (inches)	Approximate Weight (pounds)	Swivel Caster Part No.	Rigid Caster Part No.
SWIVEL AND RIGID PLATE CASTERS (DURAFOAM WHEEL)								
3	1	125	Plain	3-3/4	2-3/4	1	2F6853027081100	1F6353027081100
4	1	140	Plain	4-13/16	3-1/4	1-1/4	2F6854027081100	1F6354027081100
5	1	145	Plain	5-13/16	4	1-1/2	2F6855027081100	1F6355027081100
SWIVEL STEM CASTERS (DURAFOAM WHEEL)								
3	1	125	Plain	3-5/8	2-3/4	3/4	2F69530270811**	-
4	1	140	Plain	4-11/16	3-1/4	1	2F69540270811**	-
5	1	145	Plain	5-11/16	4	1-1/4	2F69546270811**	-

** NOTE: For your stem choice, replace ** in part number with stem code number shown in stem choices.

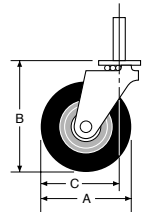
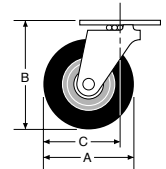

One-Piece Rigid Plate Casters

MADE IN U.S.A.



STANDARD FEATURES

- Zinc-plated finish for corrosion resistance and appearance.
- 3/8" diameter nut and bolt axle.
- Available with or without wheel thread guards.
- For use on canvas hampers and general institutional and industrial applications.
- Can be used with Americaster, Series 1F28 or Series 2F98 swivel plate casters.
- Check wheel charts for specifications on the Cushionex Supreme and Spartan Supreme wheels



3 1/2" x 1 1/4" WHEEL
155 to 250 lb. capacity

Top Plate Specifications

Overall Size 2-1/2" x 5"
Hole Spacing 1-3/16" x 4"
Hole Diameter .318"
Bolt Diameter 5/16"



4" x 1 5/8" WHEEL
240 to 400 lb. capacity

Top Plate Specifications

Overall Size 3-3/16" x 6-5/32"
Hole Spacing 1-3/4" to 2" x 5"
Hole Diameter .376" slotted to .500"
Bolt Diameter 3/8"

Wheel Diameter (inches)	Approximate Tread Width (inches)	Caster Capacity (pounds)	Wheel Bearing Type	Overall Height (inches)	Approximate Weight (pounds)	Part Number with Wheel Thread Guard	Part Number without Wheel Thread Guard
CUSHIONEX SUPREME WHEEL							
3-1/2	1-1/4	155	Delrin*	4-5/8	2	1FP0090040011AP	1FP0090040001AP
4	1-5/8	240	Delrin	5	2-1/2	1FPR040040011AQ	1FPR040040001AQ
SPARTAN SUPREME WHEEL							
3-1/2	1-1/4	250	Delrin*	4-5/8	2	1FP0090090011AP	1FP0090090001AP
4	1-5/8	400	Delrin	5	2-1/2	1FPR040090011AQ	1FPR040090001AQ

* Thread guard wheel has a sintered bearing.

Light-Medium Duty Total Lock Swivel, Swivel and Rigid Plate Casters

110 to 220 lb. capacity
1 1/4" wheel tread width



Swivel Caster with Total Lock Brake
(stainless steel caster shown)



Swivel Caster



Rigid Caster

These rugged casters roll smoothly and clean easily for all types of food handling, health care and commercial/ industrial applications. The foot-operated total lock brake is available on all swivel casters.

Stainless steel casters are available in all sizes. Contact factory for ordering information.

STANDARD FEATURES

- Two independent rows of hardened, polished ball bearings roll freely in lubricated raceways.
- Corrosion-resistant zinc finish.
- Total lock swivel caster is ideal for institutional racks, laundry trucks, packaging equipment and more; locks both wheel and swivel.
- Brake lever is easy to access and operate.

Wheel Types

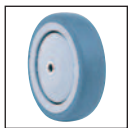

Rubber
Thermoplastic non-marking rubber tread on plastic hub with ball bearings and threadguards.

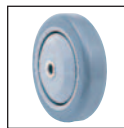

Urethane
Thermoplastic non-marking polyurethane tread on plastic hub with ball bearings and threadguards.

Top Plate Specifications

Bolt Hole Spacing 1.77" x 2.95" slotted to 2.05" x 2.84"
Mounting Bolt Size 5/16" dia.
Overall Plate Size 2-3/4" x 3-3/4"



A Wheel Dia. (inches)	Approximate Tread Width (inches)	Caster Capacity (pounds)	Wheel Bearing Type	B Height (inches)	C Swivel Radius* (inches)	Approximate Weight (pounds)	Total Lock Swivel Caster Part No.	Swivel Caster Part No.	Rigid Caster Part No.
THERMOPLASTIC RUBBER TREAD WHEEL									
3	1-1/4	110	Ball	4-3/16	4-1/4	1-3/4	8FC803H2600F1AV	8FC803H260011AV	8FC003H260011AV
4	1-1/4	175	Ball	5-5/16	4-1/4	2	8FC804H2600F1AV	8FC804H260011AV	8FC004H260011AV
5	1-1/4	220	Ball	6-5/16	4-1/4	2-1/8	8FC805H2600F1AV	8FC805H260011AV	8FC005H260011AV
POLYURETHANE TREAD WHEEL									
3	1-1/4	110	Ball	4-3/16	4-1/4	1-3/4	8FC803H2500F1AV	8FC803H250011AV	8FC003H250011AV
4	1-1/4	175	Ball	5-5/16	4-1/4	2	8FC804H2500F1AV	8FC804H250011AV	8FC004H250011AV
5	1-1/4	220	Ball	6-5/16	4-1/4	2-1/8	8FC805H2500F1AV	8FC805H250011AV	8FC005H250011AV

* Swivel Radius represents a swivel caster with Total Lock Brake (Non Brake versions will be less). Weight represents a swivel caster with Total Lock Brake (Non Brake and Rigid versions will be less).

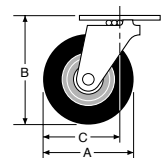

Five-Inch Wheel Diameter Cart Casters



STANDARD FEATURES

SERIES 1F08 AND 1F00

- Light-medium duty applications.
- Double row swivel construction.
- Zinc-plated finish for corrosion resistance and appearance.
- Heat treat hardened and factory lubricated swivel raceways.
- 5/16" diameter rivet axle.

SERIES 1F38 AND 1F30

- Medium duty applications.
- Double row swivel construction.
- Zinc-plated finish for corrosion resistance and appearance.
- Heat treat hardened and factory lubricated swivel raceways.
- 3/8" diameter nut and bolt axle.

190 to 280 lb. capacity
 1 3/4" wheel tread width



SERIES 1F08
 Double Row Swivel Plate Caster

SERIES 1F00
 One-piece Rigid Plate Caster

Top Plate Size
 Overall Size 2-3/4" x 3-3/4"
 Hole Spacing 1-3/4" x 3"
 Hole Diameter 11/32"
 Bolt Diameter 5/16"

OPTIONS: Consult Factory
 Side mount pinch type wheel brake.
 5/16" diameter nut and bolt axle.

350 to 375 lb. capacity
 2" wheel tread width



SERIES 1F38
 Double Row Swivel Plate Caster

SERIES 1F30
 One-piece Rigid Plate Caster

Top Plate Size
 Overall Size 2-3/4" x 3-3/4"
 Hole Spacing 1-3/4" x 3"
 Hole Diameter 11/32"
 Bolt Diameter 5/16"

OPTIONS: Consult Factory
 Side mount pinch type wheel brake.
 Economical 3/8" diameter rivet axle.
 Stainless steel casters.

Wheel Types



Cushionex Supreme
 Black soft rubber tread molded to black hard rubber core.



Spartan Supreme
 Black hard rubber tread molded to black hard rubber core.



Poly II Urethane
 Red polyurethane tread molded to light gray polypropylene core.



Poly II Rubber
 Black thermoplastic rubber tread molded to light gray polypropylene core.



Durafoam (Solid)
 Black molded polypropylene.



Duratex
 Black phenolic resin reinforced with macerated fabric.

A Wheel Dia. (inches)	Approximate Tread Width (inches)	Caster Capacity (pounds)	Wheel Bearing Type	B Height (inches)	C Swivel Radius (inches)	Approximate Weight (pounds)	Swivel Caster Part No.	Rigid Caster Part No.
CUSHIONEX SUPREME WHEEL								
5	1-1/4	190	Delrin	6	3-7/8	2-1/2	1F0855004000100	1F0055004000100
5	2	350	Delrin	6	4-3-16	4	1F3805004000100	1F3005004000100
5	2	350	Roller	6	4-3-16	3-3/4	1F3805404000100	1F3005404000100
POLY II RUBBER WHEEL								
5	2	350	Delrin	6	4-3-16	2-3/4	1F3805B26000100	1F3005B26000100
SPARTAN SUPREME WHEEL								
5	1-1/4	280	Delrin	6	3-7/8	2-1/2	1F0855009000100	1F0055009000100
5	2	375	Delrin	6	4-3-16	3-3/4	1F3805009000100	1F3005009000100
DURAFOAM WHEEL								
5	1-1/4	280	Plain	6	3-7/8	2	1F0855027000100	1F0055027000100
5	2	375	Plain	6	4-3-16	2-3/4	1F3805027000100	1F3005027000100
POLY II URETHANE WHEEL								
5	2	375	Delrin	6	4-3-16	2-3/4	1F3805B25000100	1F3005B25000100
DURATEX WHEEL								
5	2	375	Roller	6	4-3-16	3-3/4	1F3805438000100	1F3005438000100

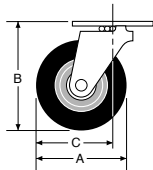

Shock Absorbing Casters

STANDARD FEATURES

SHOCK ABSORBING CASTERS

- The shock-absorbing mechanism protects loads from shock impact and vibrations and reduces bounce.
- Foot activated tread contact brake.
- Thread guard on wheels prevents threads, hair, tape, and other floor debris from accumulating on caster, restricting wheel rotation.

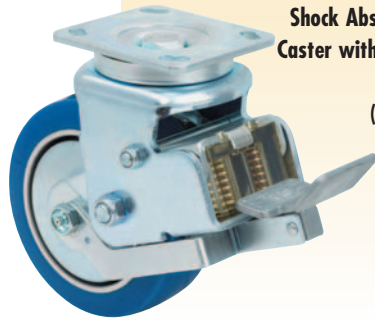

Shock Absorbing Swivel Caster with Leading Edge Tread Brake (8W000328897)

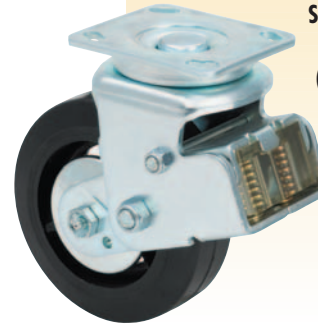

Shock Absorbing Rigid Caster (8W000328697)

A	Approximate Wheel Dia. (inches)	Caster Tread Width (inches)	Caster Capacity (pounds)	Wheel Bearing Type	B Height (inches)	C Swivel Radius (inches)*	Approximate Weight (pounds)†	Swivel Caster Part No.	Swivel Caster with Tread Lock Brake Part No.	Rigid Caster Part No.
RUBBER SOFT TREAD WHEEL/IRON CORE (BLACK HUB/BLACK TREAD)										
	6	2	410	Roller	7-15/16	6-1/8	11-1/2	8W000328497	8W000328597	8W000328697
POLYURETHANE SOFT TREAD WHEEL/ALUMINUM CORE (SILVER HUB/BLUE TREAD)										
	6	2	900	Roller	7-15/16	6-1/8	11-1/2	8W000328797	8W000328897	8W000328997

(*) Swivel Radius represents a swivel caster with Tread Lock Brake (Non Brake versions will be less).

† Weight represents a swivel caster with Tread Lock Brake (Non Brake and Rigid will be less).

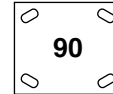

90 Plate Dimensions

Overall Size: 4" x 4-1/2"
 Hole Spacing: 2-5/8" x 3-5/8" to 3" x 3"
 Hole Diameter: 3/8" x 3/4" slots
 Bolt Diameter: 3/8"

Pneumatic Wheel Casters

STANDARD FEATURES

PNEUMATIC WHEEL CASTERS

- Double row swivel construction with extra large raceways for long service life.
- Heat treat hardened and factory lubricated swivel raceways with swivel grease fittings.
- Full pneumatic wheel gives a cushioned ride to protect delicate loads. Provides very quiet operation and superior protection for floors.



Swivel Caster with Total-Lock Brake 4FN8062540071AR



Swivel Caster with Strap Brake (8FN808254005190)

Top Plate Choices



AR Plate Dimensions

Overall Size: 2-3/4" x 3-3/4"
 Hole Spacing: 1-3/4" x 2-7/8" to 3"
 Hole Diameter: 11/32" x 13/32" slots
 Bolt Diameter: 5/16"

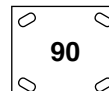

90 Plate Dimensions

Overall Size: 4" x 4-1/2"
 Hole Spacing: 2-5/8" x 3-5/8" to 3" x 3"
 Hole Diameter: 3/8" x 3/4" slots
 Bolt Diameter: 3/8"

A	Approximate Wheel Dia. (inches)	Caster Tread Width (inches)	Caster Capacity (pounds)	Wheel Bearing Type	B Height (inches)	C Swivel Radius (inches)	Approximate Weight (pounds)†	Swivel Caster Part No.	Swivel w / Brake Part No. Total-Lock (6") Strap Brake (8")	Rigid Caster Part No.
FULLY PNEUMATIC SOFT TREAD WHEEL/STEEL HUB (SILVER HUB/GRAY TREAD)										
	6	2	200	Ball	7-1/2	5-1/2*	4-1/2	4FN8062540001AR	4FN8062540071AR	4FN3062120001AR
	6	2	200	Ball	7-1/2	5-1/2*	5	4FN806254000190	4FN806254007190	4FN306212000190
	8	2.80/2.50-4	300	Ball	9-11/16	6-1/2	7	8FN808254000190	8FN808254005190	8FN308212000190
	10	4.10/3.10-4	350	Ball	11-13/16	7-5/8	7-1/2	8FN80T254000190	N/A	8FN30T212000190
FULLY PNEUMATIC SOFT TREAD WHEEL/STEEL HUB (SILVER HUB/BLACK TREAD)										
	6	2	200	Ball	7-1/2	5-1/2*	4-1/2	4FN8062120001AR	4FN8062120071AR	4FN3062120001AR
	6	2	200	Ball	7-1/2	5-1/2*	5	4FN806212000190	4FN806212007190	4FN306212000190
	8	2.80/2.50-4	300	Ball	9-11/16	6-1/2	7	8FN808212000190	8FN808212005190	8FN308212000190
	10	4.10/3.10-4	350	Ball	11-13/16	7-5/8	7-1/2	8FN80T212000190	N/A	8FN30T212000190

(*) Swivel Radius on the 6" represents a swivel caster with Total-Lock Brake (Non Brake versions will be less).

† Weight represents a swivel caster (Brake version will be 1/2 lb. more and Rigid will be 1/2 lb. less).

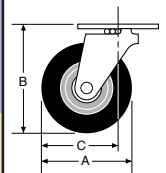

Drum Dollies

STANDARD FEATURES

- Heavy duty steel construction.
- Spotwelded for extra strength.
- Gray powder coat enamel finish. Other colors available when ordered in quantities of 100 or more.
- The five outrigger casters provide a wider stance and shorter distance between wheels for extra stability.
- Polypropylene and semi-steel wheels are impervious to fat, acid, and grease.
- Double row ball bearing swivel casters provide easy maneuverability, even under heavy loads.
- Center plate mounting holes available for a sixth caster for point load applications on five wheel dollies.
- Overall height 6-1/2"
- Optional sixth caster part numbers:
Polypropylene: 2F9803027000100
Semi-steel: 2F9803011000100



Four Wheel Drum Dolly

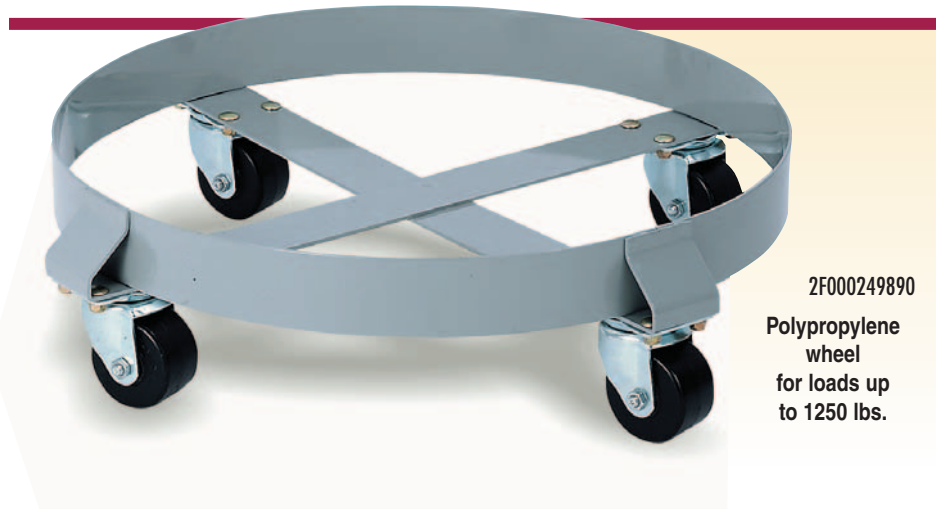

2F000249890
Polypropylene wheel for loads up to 1250 lbs.

Five Wheel Drum Dolly

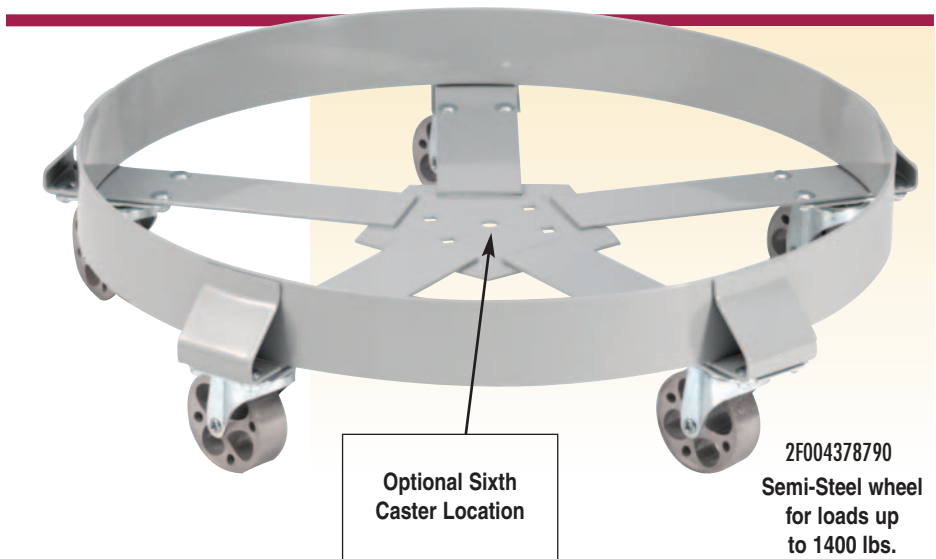

2F004378790
Semi-Steel wheel for loads up to 1400 lbs.

Drum Size	Dolly Model Number	Dolly Capacity (pounds)	Wheel Type	Wheel Size (inches)	Wheel Bearing	Replacement Caster Pack Number
FOUR WHEEL DRUM DOLLIES						
30 Gallons	2F000249990	1000	Polypropylene	3 x 1-1/4	Plain	2J000247894
55 Gallons	2F000249890	1000	Polypropylene	3 x 1-1/4	Plain	2J000247894
55 Gallons	1F000249790	1400	Polypropylene	3 x 1-3/4	Roller	1J000247794
FIVE WHEEL DRUM DOLLIES						
55 Gallons	2F004378690	1250	Polypropylene	3 x 1-1/4	Plain	2J000273294
55 Gallons	2F004378790	1400	Semi-Steel	3 x 1	Plain	2J000270294

Cushionex Supreme Wheels



Cushionex Supreme all rubber wheels consist of a black soft rubber tread molded to a black hard rubber core. Recommended for light to medium loads on hard surfaced floors, Cushionex wheels provide

excellent load protection, quiet operation, and absorb shock and vibration. Recommended operating temperature range is -20°F to 125°F. Tread Durometer: 70-85 Shore A.

Wheel Diameter (inches)	Tread Width (inches)	Load Capacity (pounds)	Caster Series Used In	Bearing Type	Hub Width (inches)	Bearing Bore Size (inches)	Spanner Bushing Required	Fits Axle Size (inches)	Wheel Part No.
CUSHIONEX SUPREME WHEEL									
2	Ball	75	9F78, 79	Sintered	—	1/4	No	1/4	1G003136794
2	13/16	75	1F40, / 9F48, 49	Delrin	15/16	1/4	No	1/4	1G003109994
2	13/16	75	9F48, 49	Delrin	15/16	3/8	Yes*	1/4	1G003110394
2	13/16	75	1F53, 58, 59	Delrin	15/16	3/8	No	3/8	1G003110394
2-1/2	13/16	90	9F48, 49	Delrin	15/16	1/4	No	1/4	1G003111394
2-1/2	13/16	90	9F48, 49	Delrin	15/16	3/8	Yes*	1/4	1G003111794
2-1/2	13/16	90	1F53, 58, 59	Delrin	15/16	3/8	No	3/8	1G003111794
2-1/2	1-1/8	120	1F90, 93 / 2F98, 99	Sintered	1-1/4	5/16	No	5/16	1G003105094
2-1/2	1-1/8	120	1F90, 93 / 2F98, 99	Sintered	1-1/4	7/16	Yes*	5/16	1G003105494
3	13/16	100	9F48, 49	Delrin	15/16	1/4	No	1/4	1G003102694
3	13/16	100	9F48, 49	Delrin	15/16	3/8	Yes*	1/4	1G003103494
3	13/16	100	1F53, 58, 59	Delrin	15/16	3/8	No	3/8	1G003103494
3	1	100	1F60, 63 / 2F68, 69	Delrin	1-1/8	5/16	No	5/16	1G003146194
3	1	100	1F60, 63 / 2F68, 69	Sintered	1-1/8	7/16	Yes*	5/16	1G003146494
3	1-1/4	125	1F90, 93 / 2F98, 99	Delrin	1-27/64	5/16	No	5/16	1G003106294
3	1-1/4	125	1F90, 93 / 2F98, 99	Sintered	1-27/64	7/16	Yes*	5/16	1G003106694
3-1/2	1-1/4	155	Americaster	Delrin	1-1/2	3/8	No	3/8	1G003182194
3-1/2	1-1/4	155	Americaster	Sintered	1-1/2	5/8	Yes*	3/8	1G003187394
4	1	115	1F60, 63 / 2F68, 69	Delrin	1-1/8	5/16	No	5/16	1G003100294
4	1	115	1F60, 63 / 2F68, 69	Sintered	1-1/8	7/16	Yes*	5/16	1G003100694
4	1-1/4	165	1F90, 93 / 2F98, 99	Delrin	1-27/64	5/16	No	5/16	1G003107494
4	1-1/4	165	1F90, 93 / 2F98, 99	Sintered	1-27/64	7/16	Yes*	5/16	1G003107894
4	1-1/4	165	Americaster	Delrin	1-27/64	3/8	No	3/8	1G003182294
4	1-3/8	200	1F23, 28, 29 / AC	Delrin	1-1/2	3/8	No	3/8	1G003124094
4	1-3/8	200	1F23, 28, 29 / AC	Sintered	1-1/2	5/8	Yes*	3/8	1G003131294
4	1-3/8	200	1F23, 28, 29 / AC	Roller	1-1/2	3/8	No	3/8	1J003125294
4	1-5/8	240	1FPO, PR	Delrin	1-27/32	5/8	Yes*	3/8	1G003193994
4	2	300	1F83, 88 / 4F83, 88	Delrin	2-1/16	1/2	No	1/2	1G003199694
5	1	125	1F60, 63 / 2F68, 69	Delrin	1-1/8	5/16	No	5/16	1G003101494
5	1	125	1F60, 63 / 2F68, 69	Sintered	1-1/8	7/16	Yes*	5/16	1G003101894
5	1-1/4	190	1F00, 08, 90, 93 / 2F98, 99	Delrin	1-27/64	5/16	No	5/16	1G003108694
5	1-1/4	190	1F00, 08, 90, 93 / 2F98, 99	Sintered	1-27/64	7/16	Yes*	5/16	1G003109094
5	1-1/4	200	Americaster	Delrin	1-1/2	3/8	No	3/8	1G003182394
5	1-1/4	190	1F00, 08	Delrin	1-1/2	5/16	No	5/16	1G003164894
5	1-3/8	240	1F23, 28, 29 / AC	Delrin	1-1/2	3/8	No	3/8	1G003124494
5	1-3/8	240	1F23, 28, 29 / AC	Sintered	1-1/2	5/8	Yes*	3/8	1G003130394
5	1-3/8	240	1F23, 28, 29 / AC	Roller	1-1/2	3/8	No	3/8	1J003124894
5	2	350	1F30, 38	Delrin	2-1/4	3/8	No	3/8	1G003169494
5	2	350	1F30, 38	Roller	2-1/4	3/8	No	3/8	1J003176394
6	1-3/8	280	1F23, 28, 29 / AC	Delrin	1-1/2	3/8	No	3/8	1G003126594
6	1-3/8	280	1F23, 28, 29 / AC	Sintered	1-1/2	5/8	Yes*	3/8	1G003131694
6	1-3/8	280	1F23, 28, 29 / AC	Roller	1-1/2	3/8	No	3/8	1J003126994

AC = Americaster Series

* Consult factory for spanner required to match axle size.

Poly II Rubber Wheels



Poly II Rubber wheels are injection co-molded from a dark gray thermo-plastic soft rubber tread molded and mechanically locked to a light gray polypropylene plastic core (13/16" wide wheels have a black core). Two-inch tread width wheels have a black tread and light gray core. Recommended for light to medium loads on carpeted and hard surfaced floors. Poly II Rubber wheels provide excellent floor protection, abrasion resistance, good impact strength, quiet operation, and rolling ease. They are non-marking, and resistant to water, oil, and most acids and

chemicals. Recommended operating temperature range is -20°F to 160°F. Poly II Rubber wheels are available with plain, delrin, ball or roller bearing. Available with optional black color decorative wheel hub caps. Special colors available in quantity. Tread Durometer: 90-100 Shore A.

Wheel Diameter (inches)	Tread Width (inches)	Load Capacity (pounds)	Caster Series Used In	Bearing Type	Hub Width (inches)	Bearing Bore Size (inches)	Spanner Bushing Required	Fits Axle Size (inches)	Wheel Part No.
POLY II RUBBER WHEEL									
3	1	100	1F60, 63 / 2F68, 69	Plain	1-1/8	5/16	No	5/16	1G003188594
3	1	100	1F60, 63 / 2F68, 69	Delrin	1-1/8	5/16	No	5/16	1G003188694
3	1-1/4	125	1F90, 93 / 2F98, 99	Delrin	1-27/64	5/16	No	5/16	1G003191294
3	1-1/4	125	Americaster	Delrin	1-1/2	3/8	No	3/8	1G003191394
3-1/2	1-1/4	155	1F90, 93 / 2F98, 99	Delrin	1-27/64	5/16	No	5/16	1G003186194
3-1/2	1-1/4	155	Americaster	Delrin	1-1/2	3/8	No	3/8	1G003182894
3-1/2	1-1/4	155	Americaster	Ball	1-1/2	3/8	No	3/8	1J003182994
4	1	115	1F60, 63 / 2F68, 69	Plain	1-1/8	5/16	No	5/16	1G003189494
4	1	115	1F60, 63 / 2F68, 69	Delrin	1-1/8	5/16	No	5/16	1G003189594
4	1-1/4	165	1F90, 93 / 2F98, 99	Delrin	1-27/64	5/16	No	5/16	1G003186494
4	1-1/4	165	Americaster	Delrin	1-1/2	3/8	No	3/8	1G003184194
4	1-1/4	165	Americaster	Ball	1-1/2	3/8	No	3/8	1J003184294
4	1-1/4	165	Americaster	Roller	1-1/2	3/8	No	3/8	1J003184394
4	1-1/2	200	1F23, 28, 29 / AC	Delrin	1-1/2	3/8	No	3/8	1G003179894
4	1-1/2	200	1F23, 28, 29 / AC	Ball	1-1/2	3/8	No	3/8	1J003179994
4	1-1/2	200	1F23, 28, 29 / AC	Roller	1-1/2	3/8	No	3/8	1J003180094
4	1-1/2	200	1F23, 28, 29 / AC	Delrin	1-1/2	5/8	Yes*	3/8	1G003180194
4	2	300	1F83,88 / 4F83, 88	Roller	2-1/8	3/4	Yes*	1/2	1J003198094
4	2	300	1F83,88 / 4F83, 88	Delrin	2-1/8	1/2	No	1/2	1G003198194
5	1	125	1F60, 63 / 2F68, 69	Plain	1-1/8	5/16	No	5/16	1G003190394
5	1	125	1F60, 63 / 2F68, 69	Delrin	1-1/8	5/16	No	5/16	1G003190494
5	1-1/4	200	1F90, 93 / 2F98, 99	Delrin	1-27/64	5/16	No	5/16	1G003186794
5	1-1/4	200	Americaster	Delrin	1-1/2	3/8	No	3/8	1G003178394
5	1-1/4	200	Americaster	Ball	1-1/2	3/8	No	3/8	1J003178494
5	1-1/4	200	Americaster	Roller	1-1/2	3/8	No	3/8	1J003178594
5	1-1/2	240	1F23, 28, 29 / AC	Delrin	1-1/2	3/8	No	3/8	1G003177194
5	1-1/2	240	1F23, 28, 29 / AC	Ball	1-1/2	3/8	No	3/8	1J003177294
5	1-1/2	240	1F23, 28, 29 / AC	Roller	1-1/2	3/8	No	3/8	1J003177394
5	1-1/2	240	1F23, 28, 29 / AC	Delrin	1-1/2	5/8	Yes*	3/8	1G003177494
5	2	325	1F83, 88 / 4F83, 88	Delrin	2-1/8	1/2	No	1/2	1G003195194
5	2	325	1F83, 88 / 4F83, 88	Delrin	2-1/8	3/4	Yes*	1/2	1G003195394
5	2	325	1F83, 88 / 4F83, 88	Roller	2-1/8	3/4	Yes*	1/2	1J003192594
6	1-1/2	250	1F23, 28, 29 / AC	Ball	1-1/2	3/8	No	3/8	1J003181194
6	1-1/2	280	1F23, 28, 29 / AC	Delrin	1-1/2	3/8	No	3/8	1G003181094
6	1-1/2	280	1F23, 28, 29 / AC	Roller	1-1/2	3/8	No	3/8	1J003181294
6	1-1/2	280	1F23, 28, 29 / AC	Delrin	1-1/2	5/8	Yes*	3/8	1G003181394
6	2	400	1F83, 88 / 4F83, 88	Delrin	2-1/8	1/2	No	1/2	1G003195794
6	2	400	1F83, 88 / 4F83, 88	Delrin	2-1/8	3/4	Yes*	1/2	1G003195994
6	2	400	1F83, 88 / 4F83, 88	Roller	2-1/8	3/4	Yes*	1/2	1J003192794
8	2	475	1F83, A8	Roller	2-3/16	3/4	Yes*	1/2	1J003192994

AC = Americaster Series

* Consult factory for spanner required to match axle size.

Mold-On Rubber Wheels

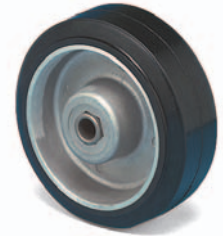

Mold-on rubber wheels consist of a soft black rubber tread permanently bonded to an aluminum core. Recommended for light to medium loads on hard surfaced floors. Mold-on rubber wheels provide excellent floor and load protection, quiet operation, and

absorb shock and vibration. Recommended operating temperature range is -20°F to 160°F. Tread Durometer: 70-85 Shore A.

Wheel Diameter (inches)	Tread Width (inches)	Load Capacity (pounds)	Caster Series Used In	Bearing Type	Hub Width (inches)	Bearing Bore Size (inches)	Spanner Bushing Required	Fits Axle Size (inches)	Wheel Part No.
MOLD-ON RUBBER WHEEL									
4	2	300	1F83, 88 / 4F83, 88	Roller	2-1/4	3/4	Yes*	1/2	1J003144194
5	2	350	1F83, 88 / 4F83, 88	Roller	2-1/4	3/4	Yes*	1/2	1J003164094
6	2	410	1F83, 88 / 4F83, 88	Roller	2-1/4	3/4	Yes*	1/2	1J003163994
8	2	500	1F83, A8	Roller	2-1/4	3/4	Yes*	1/2	1J003163894

Mold-On Polyurethane Wheels



Mold-on polyurethane wheels consist of a red or blue polyurethane tread molded and mechanically locked to an aluminum core. Recommended for medium to heavy loads on carpeted and hard surfaced floors. Mold-on polyurethane wheels provide good floor

protection, quiet operation, abrasion resistance, rolling ease, impact resistance, and are non-marking. Recommended operating temperature range is -20°F to 180°F. Tread Durometer: 55 Shore D.

Wheel Diameter (inches)	Tread Width (inches)	Load Capacity (pounds)	Wheel Color Tread/Hub	Caster Series Used In	Bearing Type	Hub Width (inches)	Bearing Bore Size (inches)	Spanner Bushing Required	Fits Axle Size (inches)	Wheel Part No.
MOLD-ON POLYURETHANE WHEEL										
4	2	750	Red/Aluminum	1F83, 88 / 4F83, 88	Roller	2-3/16	3/4	Yes*	1/2	1J003205494
4	2	750	Blue/Aluminum	1F83, 88 / 4F83, 88	Roller	2-3/16	3/4	Yes*	1/2	1J003205594
5	2	1050	Red/Aluminum	1F83, 88 / 4F83, 88	Roller	2-3/16	3/4	Yes*	1/2	1J003185794
5	2	1050	Blue/Aluminum	1F83, 88 / 4F83, 88	Roller	2-3/16	3/4	Yes*	1/2	1J003200794
6	2	1200	Red/Aluminum	1F83, 88 / 4F83, 88	Roller	2-3/16	3/4	Yes*	1/2	1J003185694
6	2	1200	Blue/Aluminum	1F83, 88 / 4F83, 88	Roller	2-3/16	3/4	Yes*	1/2	1J003200894
8	2	1350	Red/Aluminum	1F83, A8	Roller	2-3/16	3/4	Yes*	1/2	1J003142794
8	2	1350	Blue/Aluminum	1F83, A8	Roller	2-3/16	3/4	Yes*	1/2	1J003200994

* Consult factory for spanner required to match axle size.



Poly II Urethane Wheels

Poly II Urethane wheels are injection co-molded from a dark blue polyurethane tread molded and mechanically locked to light gray polypropylene plastic core. Two-inch tread width wheels have a red tread and light gray core. Recommended for light to heavy loads on carpeted and hard surfaced floors. Poly II Urethane wheels provide excellent floor protection, abrasion resistance, rolling ease, good impact strength, and quiet operation. They are non-marking, and resistant to water, oil, and most acids and chemicals. Recommended

operating temperature range is -20°F to 180°F. Poly II Urethane wheels are available with plain, delrin, ball, or roller bearing. Available with optional black color decorative wheel hub caps. Special colors available in quantity. Tread Durometer: 50-60 Shore D.

Wheel Diameter (inches)	Tread Width (inches)	Load Capacity (pounds)	Caster Series Used In	Bearing Type	Hub Width (inches)	Bearing Bore Size (inches)	Spanner Bushing Required	Fits Axle Size (inches)	Wheel Part No.
POLY II URETHANE WHEEL									
3	1	125	1F60, 63 / 2F68, 69	Plain	1-1/8	5/16	No	5/16	1G003188294
3	1	125	1F60, 63 / 2F68, 69	Delrin	1-1/8	5/16	No	5/16	1G003188394
3	1-1/4	210	1F90, 93 / 2F98, 99	Delrin	1-27/64	5/16	No	5/16	1G003190994
3	1-1/4	210	Americaster	Delrin	1-1/2	3/8	No	3/8	1G003191094
3-1/2	1-1/4	250	1F90, 93 / 2F98, 99	Delrin	1-27/64	5/16	No	5/16	1G003186094
3-1/2	1-1/4	250	Americaster	Delrin	1-1/2	3/8	No	3/8	1G003182494
3-1/2	1-1/4	250	Americaster	Ball	1-1/2	3/8	No	3/8	1J003182594
3-1/2	1-1/4	250	Americaster	Roller	1-1/2	3/8	No	3/8	1J003182694
4	1	140	1F60, 63 / 2F68, 69	Plain	1-1/8	5/16	No	5/16	1G003189194
4	1	140	1F60, 63 / 2F68, 69	Delrin	1-1/8	5/16	No	5/16	1G003189294
4	1-1/4	250	Americaster	Ball	1-1/2	3/8	No	3/8	1J003183894
4	1-1/4	275	1F90, 93 / 2F98, 99	Delrin	1-27/64	5/16	No	5/16	1G003186394
4	1-1/4	275	Americaster	Delrin	1-1/2	3/8	No	3/8	1G003183794
4	1-1/4	275	Americaster	Roller	1-1/2	3/8	No	3/8	1J003183994
4	1-1/2	250	1F23, 28, 29 / AC	Ball	1-1/2	3/8	No	3/8	1J003179594
4	1-1/2	375	1F23, 28, 29 / AC	Delrin	1-1/2	3/8	No	3/8	1G003179494
4	1-1/2	375	1F23, 28, 29 / AC	Roller	1-1/2	3/8	No	3/8	1J003179694
4	1-1/2	375	1F23, 28, 29 / AC	Delrin	1-1/2	5/8	Yes*	3/8	1G003179794
4	2	600	1F83, 88 / 4F83, 88	Roller	2-1/8	3/4	Yes*	1/2	1J003198394
4	2	600	1F83, 88 / 4F83, 88	Delrin	2-1/8	1/2	No	1/2	1G003198494
5	1	145	1F60, 63 / 2F68, 69	Plain	1-1/8	5/16	No	5/16	1G003190094
5	1	145	1F60, 63 / 2F68, 69	Delrin	1-1/8	5/16	No	5/16	1G003190194
5	1-1/4	250	Americaster	Ball	1-1/2	3/8	No	3/8	1J003178094
5	1-1/4	280	1F90, 93 / 2F98, 99	Delrin	1-27/64	5/16	No	5/16	1G003186694
5	1-1/4	300	Americaster	Delrin	1-1/2	3/8	No	3/8	1G003177994
5	1-1/4	300	Americaster	Roller	1-1/2	3/8	No	3/8	1J003178194
5	1-1/2	250	1F23, 28, 29 / AC	Ball	1-1/2	3/8	No	3/8	1J003176894
5	1-1/2	450	1F23, 28, 29 / AC	Delrin	1-1/2	3/8	No	3/8	1G003176794
5	1-1/2	450	1F23, 28, 29 / AC	Roller	1-1/2	3/8	No	3/8	1J003176994
5	1-1/2	450	1F23, 28, 29 / AC	Delrin	1-1/2	5/8	Yes*	3/8	1G003177094
5	2	750	1F83, 88 / 4F83, 88	Delrin	2-1/8	1/2	No	1/2	1G003195294
5	2	750	1F83, 88 / 4F83, 88	Delrin	2-1/8	3/4	Yes*	1/2	1G003195494
5	2	750	1F83, 88 / 4F83, 88	Roller	2-1/8	3/4	Yes*	1/2	1J003192694
6	1-1/2	250	1F23, 28, 29 / AC	Ball	1-1/2	3/8	No	3/8	1J003180794
6	1-1/2	450	1F23, 28, 29 / AC	Delrin	1-1/2	3/8	No	3/8	1G003180694
6	1-1/2	450	1F23, 28, 29 / AC	Roller	1-1/2	3/8	No	3/8	1J003180894
6	1-1/2	450	1F23, 28, 29 / AC	Delrin	1-1/2	5/8	Yes*	3/8	1G003180994
6	2	900	1F83, 88 / 4F83, 88	Delrin	2-1/8	1/2	No	1/2	1G003195894
6	2	900	1F83, 88 / 4F83, 88	Delrin	2-1/8	3/4	Yes*	1/2	1G003196094
6	2	900	1F83, 88 / 4F83, 88	Roller	2-1/8	3/4	Yes*	1/2	1J003192894
8	2	900	1F83, A8	Roller	2-3/16	3/4	Yes*	1/2	1J003193094

AC = Americaster Series

* Consult factory for spanner required to match axle size.

Durafoam Wheels

Durafoam wheels are one-piece injection molded from black polypropylene plastic. Recommended for light to heavy loads on carpeted and hard surfaced floors. Durafoam wheels provide good floor protection and impact strength, excellent rolling ease, are non-marking, and resistant to water, oil, and most acids and chemicals. Recommended operating temperature range is 10°F to

180°F. Durafoam wheels require no bearing and are ideal for corrosive applications which cause continual bearing replacement. Tread Durometer: 60-75 Shore D.



Dished



Solid

Wheel Diameter (inches)	Tread Width (inches)	Load Capacity (pounds)	Wheel Design	Caster Series Used In	Bearing Type	Hub Width (inches)	Bearing Bore Size (inches)	Spanner Bushing Required	Fits Axle Size (inches)	Wheel Part No.
DURAFOAM WHEEL										
2	3/4	100	Dished	1F40 / 9F48, 49	Plain	15/16	1/4	No	1/4	1G003168594
2	3/4	100	Dished	1F53, 58, 59	Plain	15/16	3/8	No	3/8	1G003170394
2-1/2	13/16	115	Dished	9F48, 49	Plain	15/16	1/4	No	1/4	1G003185294
2-1/2	1-1/4	175	Dished	1F93 / 2F98, 99	Plain	1-7/16	5/16	No	5/16	1G003164294
3	3/4	125	Dished	1F53, 58, 59	Plain	15/16	3/8	No	3/8	1G003170694
3	3/4	125	Dished	9F48, 49	Plain	15/16	1/4	No	1/4	1G003170594
3	1	125	Solid	1F60, 63 / 2F68, 69	Plain	1-1/8	5/16	No	5/16	1G003159394
3	1	125	Solid	1F60, 63 / 2F68, 69	Plain	1-1/8	7/16	Yes*	5/16	1G003159494
3	1-1/4	210	Solid	1F90, 93 / 2F98, 99	Plain	1-7/16	5/16	No	5/16	1G003145294
3	1-1/4	210	Solid	1F90, 93 / 2F98, 99	Plain	1-7/16	7/16	Yes*	5/16	1G003162894
3	1-3/4	350	Solid	1F53, 58, 59	Roller	1-7/8	3/8	No	3/8	1J003161494
3	1-3/4	350	Solid	1F53, 58, 59	Sintered	1-7/8	3/8	No	3/8	1J003148794
4	1	140	Solid	1F60, 63 / 2F68, 69	Plain	1-1/8	5/16	No	5/16	1G003144694
4	1	140	Solid	1F60, 63 / 2F68, 69	Plain	1-1/8	7/16	Yes*	5/16	1G003164394
4	1-1/4	255	Solid	1F90, 93 / 2F98, 99	Plain	1-7/16	5/16	No	5/16	1G003144494
4	1-1/4	255	Solid	1F90, 93 / 2F98, 99	Plain	1-7/16	7/16	Yes*	5/16	1G003161394
4	1-3/8	300	Solid	1F23, 28, 29	Plain	1-1/2	3/8	No	3/8	1G003147094
4	1-1/2	300	Dished	1F23, 28, 29	Roller	1-5/8	3/8	No	3/8	1J003161694
5	1	145	Solid	1F60, 63 / 2F68, 69	Plain	1-1/8	5/16	No	5/16	1G003170794
5	1 1/4	280	Solid	1F00, 08, 90, 93 / 2F98, 99	Plain	1-1/2	5/16	No	5/16	1G003169594
5	1 1/4	280	Solid	1F90, 93 / 2F98, 99	Plain	1-7/16	5/16	No	5/16	1G003146094
5	1 1/4	280	Solid	1F90, 93 / 2F98, 99	Sintered	1-1/2	5/16	No	5/16	1G003170494
5	1-3/8	350	Solid	1F23, 28, 29	Plain	1-1/2	3/8	No	3/8	1G003147194
5	1-1/2	350	Dished	1F23, 28, 29	Roller	1-5/8	3/8	No	3/8	1J003195094
5	2	450	Solid	1F30, 38	Plain	2-1/4	3/8	No	3/8	1G003185194
5	2	450	Dished	1F30, 38	Roller	2-3/16	3/8	No	3/8	1J003167094
6	1-3/8	400	Solid	1F23, 28, 29	Roller	1-1/2	3/8	No	3/8	1J003148194
6	1-3/8	400	Solid	1F23, 28, 29	Plain	1-1/2	3/8	No	3/8	1G003147294
6	1-1/2	400	Dished	1F23, 28, 29	Plain	1-5/8	3/8	No	3/8	1G003174494
6	1-1/2	400	Dished	1F23, 28, 29	Roller	1-5/8	3/8	No	3/8	1J003161994

* Consult Factory for spanner required to match axle size.

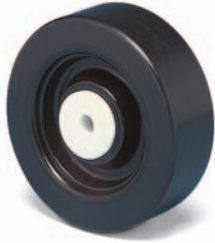

Poly II Poly Wheels

Poly II Poly wheels are injection co-molded from a black polypropylene tread molded and mechanically locked to a black polypropylene plastic core. Two-inch tread width wheels have a black tread and light gray core. Recommended for light to heavy loads on carpeted and hard surfaced floors. Poly II Poly wheels provide good floor protection, abrasion resistance, rolling ease, good impact strength and quiet operation. They are non-marking, are resistant to water, oil, and most acids and chemicals.

Recommended operating temperature range is -20°F to 180°F. Poly II Poly wheels are available with a choice of plain, delrin, ball, or roller bearings. Available with optional black color decorative wheel hub caps. Special colors available in quantity. Tread Durometer: 60-75 Shore D.

Wheel Diameter (inches)	Tread Width (inches)	Load Capacity (pounds)	Caster Series Used In	Bearing Type	Hub Width (inches)	Bearing Bore Size (inches)	Spanner Bushing Required	Fits Axle Size (inches)	Wheel Part No.
POLY II POLY WHEEL									
3	1	125	1F60, 63 / 2F68, 69	Plain	1-1/8	5/16	No	5/16	1G003188894
3	1	125	1F60, 63 / 2F68, 69	Delrin	1-1/8	5/16	No	5/16	1G003188994
3	1-1/4	210	1F90, 93 / 2F98, 99	Delrin	1-27/64	5/16	No	5/16	1G003191594
3	1-1/4	210	Americaster	Delrin	1-1/2	3/8	No	3/8	1G003191694
3-1/2	1-1/4	250	1F90, 93 / 2F98, 99	Delrin	1-27/64	5/16	No	5/16	1G003186294
3-1/2	1-1/4	250	Americaster	Delrin	1-1/2	3/8	No	3/8	1G003183294
3-1/2	1-1/4	250	Americaster	Ball	1-1/2	3/8	No	3/8	1J003183394
3-1/2	1-1/4	250	Americaster	Roller	1-1/2	3/8	No	3/8	1J003183494
3-1/2	1-1/4	250	Americaster	Delrin	1-1/2	5/8	Yes	3/8	1G003183594
4	1	140	1F60, 63 / 2F68, 69	Plain	1-1/8	5/16	No	5/16	1G003189794
4	1	140	1F60, 63 / 2F68, 69	Delrin	1-1/8	5/16	No	5/16	1G003189894
4	1-3/8	275	1F90, 93 / 2F98, 99	Delrin	1-27/64	5/16	No	5/16	1G003211794
4	1-3/8	375	1F23, 28, 29 / AC	Delrin	1-1/2	3/8	No	3/8	1G003211894
4	1-3/8	250	1F23, 28, 29 / AC	Ball	1-1/2	3/8	No	3/8	1J003216894
4	1-3/8	375	1F23, 28, 29 / AC	Roller	1-1/2	3/8	No	3/8	1J003211994
4	1-3/8	375	1F23, 28, 29 / AC	Delrin	1-1/2	5/8	Yes	3/8	1G003212094
4	2	400	1F83, 88 / 4F83, 88	Roller	2-1/8	3/4	Yes	1/2	1J003198694
4	2	400	1F83, 88 / 4F83, 88	Delrin	2-1/8	1/2	No	1/2	1G003198794
5	1	145	1F60, 63 / 2F68, 69	Plain	1-1/8	5/16	No	5/16	1G003190694
5	1	145	1F60, 63 / 2F68, 69	Delrin	1-1/8	5/16	No	5/16	1G003190794
5	1	145	1F60, 63 / 2F68, 69	Plain	1-1/8	7/16	Yes	5/16	1G003190894
5	1-3/8	280	1F90, 93 / 2F98, 99	Delrin	1-27/64	5/16	No	5/16	1G003212194
5	1-3/8	450	1F23, 28, 29 / AC	Delrin	1-1/2	3/8	No	3/8	1G003212294
5	1-3/8	250	1F23, 28, 29 / AC	Ball	1-1/2	3/8	No	3/8	1J003216994
5	1-3/8	450	1F23, 28, 29 / AC	Roller	1-1/2	3/8	No	3/8	1J003212394
5	1-3/8	450	1F23, 28, 29 / AC	Delrin	1-1/2	5/8	Yes	3/8	1G003212494
5	2	750	1F83, 88 / 4F83, 88	Delrin	2-1/8	1/2	No	1/2	1G003196794
5	2	750	1F83, 88 / 4F83, 88	Delrin	2-1/8	3/4	Yes	1/2	1G003196894
5	2	750	1F83, 88 / 4F83, 88	Roller	2-1/8	3/4	Yes	1/2	1J003196694
6	1-3/8	450	1F23, 28, 29 / AC	Delrin	1-1/2	3/8	No	3/8	1G003212594
6	1-3/8	250	1F23, 28, 29 / AC	Ball	1-1/2	3/8	No	3/8	1J003217094
6	1-3/8	450	1F23, 28, 29 / AC	Roller	1-1/2	3/8	No	3/8	1J003212694
6	1-3/8	450	1F23, 28, 29 / AC	Delrin	1-1/2	5/8	Yes	3/8	1G003212794
6	2	900	1F83, 88 / 4F83, 88	Delrin	2-1/8	1/2	No	1/2	1G003197194
6	2	900	1F83, 88 / 4F83, 88	Delrin	2-1/8	3/4	Yes	1/2	1G003197294
6	2	900	1F83, 88 / 4F83, 88	Roller	2-1/8	3/4	Yes	1/2	1J003197094
8	2	900	1F83, A8	Roller	2-1/8	3/4	Yes	1/2	8G003219894

AC = Americaster Series

Spartan Supreme Wheels



Spartan Supreme all rubber wheels consist of all black solid hard rubber material. Recommended for light to heavy loads on carpeted and hard surfaced floors. Spartan Supreme wheels

provide good rolling ease, are non-sparking, and resistant to water, oil, and most acids. Recommended operating temperature range is -20°F to 125°F. Tread Durometer: 70-85 Shore D.

Wheel Diameter (inches)	Tread Width (inches)	Load Capacity (pounds)	Caster Series Used In	Bearing Type	Hub Width (inches)	Bearing Bore Size (inches)	Spanner Bushing Required	Fits Axle Size (inches)	Wheel Part No.
SPARTAN SUPREME WHEEL									
2	Ball	100	9F78, 79	Sintered	—	1/4	No	1/4	1G003137994
2	13/16	100	1F40, / 9F48, 49	Delrin	15/16	1/4	No	1/4	1G003110894
2	13/16	100	9F48, 49	Delrin	15/16	3/8	Yes*	1/4	1G003111094
2	13/16	100	1F53, 58, 59	Delrin	15/16	3/8	No	3/8	1G003111094
2-1/2	13/16	115	9F48, 49	Delrin	15/16	1/4	No	1/4	1G003112294
2-1/2	13/16	115	9F48, 49	Delrin	15/16	3/8	Yes*	1/4	1G003112494
2-1/2	13/16	115	1F53, 58, 59	Delrin	15/16	3/8	No	3/8	1G003112494
2-1/2	1-1/8	175	1F90, 93 / 2F98, 99	Sintered	1-1/4	5/16	No	5/16	1G003105894
2-1/2	1-1/8	175	1F90, 93 / 2F98, 99	Sintered	1-1/4	7/16	Yes*	5/16	1G003106094
3	13/16	125	9F48, 49	Delrin	15/16	1/4	No	1/4	1G003104294
3	13/16	125	9F48, 49	Delrin	15/16	3/8	Yes*	1/4	1G003104694
3	13/16	125	1F53, 58, 59	Delrin	15/16	3/8	No	3/8	1G003104694
3	1	125	1F60, 63 / 2F68, 69	Delrin	1-1/8	5/16	No	5/16	1G003146794
3	1	125	1F60, 63 / 2F68, 69	Sintered	1-1/8	7/16	Yes*	5/16	1G003146894
3	1-1/4	210	1F90, 93 / 2F98, 99	Delrin	1-27/64	5/16	No	5/16	1G003107094
3	1-1/4	210	1F90, 93 / 2F98, 99	Sintered	1-27/64	7/16	Yes*	5/16	1G003107294
3-1/2	1-1/4	250	Americaster	Delrin	1-1/2	3/8	No	3/8	1G003192194
3-1/2	1-1/4	250	Americaster	Sintered	1-1/2	5/8	Yes*	3/8	1G003187494
4	1	140	1F60, 63 / 2F68, 69	Delrin	1-1/8	5/16	No	5/16	1G003101094
4	1	140	1F60, 63 / 2F68, 69	Sintered	1-1/8	7/16	Yes*	5/16	1G003101294
4	1-1/4	255	1F90, 93 / 2F98, 99	Delrin	1-27/64	5/16	No	5/16	1G003108294
4	1-1/4	255	1F90, 93 / 2F98, 99	Sintered	1-27/64	7/16	Yes*	5/16	1G003108494
4	1-1/4	255	Americaster	Delrin	1-27/64	3/8	No	3/8	1G003192294
4	1-3/8	300	1F23, 28, 29 / AC	Delrin	1-1/2	3/8	No	3/8	1G003124294
4	1-3/8	300	1F23, 28, 29 / AC	Sintered	1-1/2	5/8	Yes*	3/8	1G003131494
4	1-3/8	300	1F23, 28, 29 / AC	Roller	1-1/2	3/8	No	3/8	1J003129294
4	1-5/8	400	1FPO, PR	Delrin	1-27/32	5/8	Yes*	3/8	1G003194194
4	2	400	1F83, 88 / 4F83, 88	Delrin	2-1/16	1/2	No	1/2	1G003199894
5	1	145	1F60, 63 / 2F68, 69	Delrin	1-1/8	5/16	No	5/16	1G003102294
5	1	145	1F60, 63 / 2F68, 69	Sintered	1-1/8	7/16	Yes*	5/16	1G003102494
5	1-1/4	280	1F00, 08, 90, 93 / 2F98, 99	Delrin	1-27/64	5/16	No	5/16	1G003109494
5	1-1/4	280	1F00, 08, 90, 93 / 2F98, 99	Sintered	1-27/64	7/16	Yes*	5/16	1G003109694
5	1-1/4	280	Americaster	Delrin	1-1/2	3/8	No	3/8	1G003192394
5	1-1/4	280	1F00, 08	Delrin	1-1/2	5/16	No	5/16	1G003165794
5	1-3/8	350	1F23, 28, 29 / AC	Delrin	1-1/2	3/8	No	3/8	1G003124694
5	1-3/8	350	1F23, 28, 29 / AC	Sintered	1-1/2	5/8	Yes*	3/8	1G003130594
5	1-3/8	350	1F23, 28, 29 / AC	Roller	1-1/2	3/8	No	3/8	1J003125094
5	2	450	1F30, 38	Delrin	2-1/4	3/8	No	3/8	1G003166094
5	2	450	1F30, 38	Roller	2-1/4	3/8	No	3/8	1J003174894
5	2	450	1F83, 88 / 4F83, 88	Sintered	2-1/4	1/2	No	1/2	1G003140194
6	1-3/8	400	1F23, 28, 29 / AC	Delrin	1-1/2	3/8	No	3/8	1G003126794
6	1-3/8	400	1F23, 28, 29 / AC	Sintered	1-1/2	5/8	Yes*	3/8	1G003131894
6	1-3/8	400	1F23, 28, 29 / AC	Roller	1-1/2	3/8	No	3/8	1J003129694
6	2	560	1F83, 88 / 4F83, 88	Sintered	2-3/16	1/2	No	1/2	1G003140294

AC = Americaster Series

* Consult Factory for spanner required to match axle size.



Duratex Phenolic Wheels

Duratex wheels consist of a black phenolic resin impregnated and reinforced with macerated fabric to provide a very hard tread and high capacity wheel. Recommended for medium to heavy loads on carpeted and hard surfaced floors. Duratex wheels provide good floor protection,

are quieter than steel wheels, have excellent rolling ease, high impact resistance, and are resistant to most chemicals and acids. Recommended operating temperature range is -45°F to 300°F.

Wheel Diameter (inches)	Tread Width (inches)	Load Capacity (pounds)	Caster Series Used In	Bearing Type	Hub Width (inches)	Bearing Bore Size (inches)	Spanner Bushing Required	Fits Axle Size (inches)	Wheel Part No.
DURATEX PHENOLIC WHEEL									
2-1/2	1-3/4	300	1F53, 58, 59	Roller	1-29/32	3/8	No	3/8	1J003219994
2-5/8	1-3/4	350	1F53, 58, 59	Roller	1-7/8	3/8	No	3/8	1J003220094
3(H)	1-1/2	300**	Americaster	Roller	1-5/8	1/2	Yes*	3/8	1J003218894
3	1-1/2	500**	Americaster	Plain	1-5/8	1/2	Yes*	3/8	1G003197394
3	1-1/2	500**	Americaster	Roller	1-5/8	5/8	Yes*	3/8	1J003193794
3	1-13/16	500	1F53, 58, 59	Roller	1-7/8	3/8	No	3/8	1J003172894
4(H)	1-1/2	375	1F23, 28, 29	Roller	1-5/8	1/2	Yes*	3/8	1J003220894
4	1-1/2	500**	Americaster	Plain	1-5/8	1/2	Yes*	3/8	1G003197494
4	1-1/2	500**	Americaster	Roller	1-5/8	3/8	No	3/8	1J003196494
4(H)	2	600**	1F83, 88	Roller	2-3/16	3/4	Yes*	1/2	1J003221094
4	2	800	1F83, 88 / 4F83, 88	Roller	2-3/16	3/4	Yes*	1/2	1J003175494
5(H)	1-1/2	400**	1F23, 28, 29	Roller	1-5/8	1/2	Yes*	3/8	1G003218994
5	1-1/2	500**	Americaster	Plain	1-5/8	1/2	Yes*	3/8	1G003197594
5	1-1/2	500**	Americaster	Roller	1-5/8	1/2	Yes*	3/8	1J003127394
5(H)	2	750**	1F83, 88	Roller	2-3/16	3/4	Yes*	1/2	1J003218794
5	2	500**	1F30, 38	Roller	2-3/16	3/8	No	3/8	1J003174394
5	2	1000	1F83, 88 / 4F83, 88	Roller	2-3/16	3/4	Yes*	1/2	1J003169094
6	1-1/2	500**	Americaster	Plain	1-5/8	1/2	Yes*	3/8	1G003197694
6	1-1/2	500**	Americaster	Roller	1-5/8	1/2	Yes*	3/8	1J003185394
6(H)	2	900	1F83, 88	Roller	2-3/16	3/4	Yes*	1/2	1J003217294
6	2	1200	1F83, 88 / 4F83, 88	Roller	2-3/16	3/4	Yes*	1/2	1J003167994
8	2	1200	1F83, A8	Roller	2-3/16	3/4	Yes*	1/2	1J003171994

(H) Wheel is high temperature phenolic with an operative range of 475°F continuous, 525°F intermittent.



Semi-Steel Wheels

Semi-steel wheels consist of cast iron enriched with steel. Recommended for medium to heavy loads on rough and metal debris littered floors and where floor protection and noise are not critical. Semi-steel wheels provide long service life, high load capacity, excellent impact resistance, easy

rolling, and superior performance and durability in extreme high and low temperature conditions. Recommended operating temperature range is -50°F to 500°F.

Wheel Diameter (inches)	Tread Width (inches)	Load Capacity (pounds)	Caster Series Used In	Bearing Type	Hub Width (inches)	Bearing Bore Size (inches)	Spanner Bushing Required	Fits Axle Size (inches)	Wheel Part No.
SEMI-STEEL WHEEL									
3	1-1/4	450	Americaster	Plain	1-1/2	1/2	Yes*	3/8	1G003197790
3	1-1/4	450	Americaster	Roller	1-1/2	1/2	Yes*	3/8	1G003193690
4	1-1/4	500**	Americaster	Plain	1-1/2	1/2	Yes*	3/8	1G003197890
4	1-1/2	650	1F23, 28, 29 / AC	Roller	1-11/16	1/2	Yes*	3/8	1G003193590
4	2	1000	1F83, 88 / 4F83, 88	Roller	2-3/16	3/4	Yes*	1/2	1J003188190
5	2	1000	1F83, 88 / 4F83, 88	Roller	2-3/16	3/4	Yes*	1/2	1J003157290
6	2	1200	1F83, 88 / 4F83, 88	Roller	2-3/16	3/4	Yes*	1/2	1J003157390
8	2	1400	1F83, A8	Roller	2-3/16	3/4	Yes*	1/2	1J003157490

AC = Americaster Series

* Consult factory for spanner required to match axle size.

** Maximum recommended load capacity when used with a 3/8" diameter axle.

Round Tube



Square Tube



Hole in Wood



Stem Types

- 01 – 7/16" diameter x 1-3/8" long friction ring stem
- 02 – 7/16" diameter x 1-29/32" long round stem
- 03 – 7/16" diameter x 1-29/32" long friction ring stem

TUBE TYPE			Hole O.D. (inches)	Minimum Hole Depth	Socket Material	Use with Stem Type	Socket Part No.
O.D. (inches)	Gauge	I.D. (inches)					
ROUND TUBE							
0.750	18	0.652	—	—	Plastic	01, 03	1G000112094
1.000	18	0.902	—	—	Plastic	01, 03	1G000125694
1.000	18	0.902	—	—	Metal	02	1G000212797
1.000	16	0.870	—	—	Plastic	01, 03	1G000125594
1.000	16	0.870	—	—	Metal	02	1G000222697
1.250	14	1.084	—	—	Plastic	01, 03	1G000186994
SQUARE TUBE							
1.000	18	0.902	—	—	Plastic	01	1G000491494
1.000	16	0.870	—	—	Plastic	01	1G000277294
HOLE IN WOOD							
—	—	—	0.563	1.75	Plastic	01	1G000207494
—	—	—	0.563	1.94	Metal	01, 03	1J000227797

Brackets (for use with Type 01 Stem)

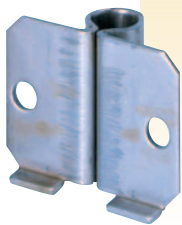

Flat Surface Welded or Bolted
(1G000187094)
Raw (unplated) finish

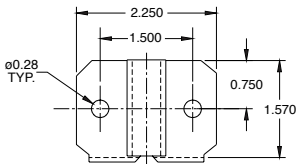

Outside Angle Bolted
(1G000248897)
Zinc-plated finish

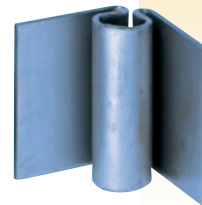
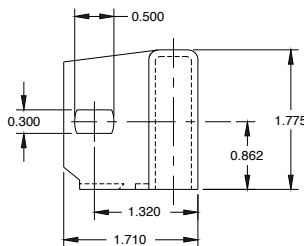

Inside Angle Welded
(1G000241294)
Raw (unplated) finish

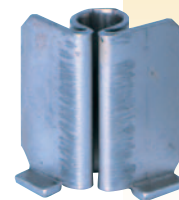
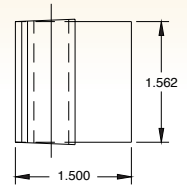

Inside Angle Welded
(1G000220694)
Raw (unplated) finish

