

The PT Polytech Caster is a highly stylized engineering plastic castor whose sturdiness comes from fiberglass reinforced plastic body. Firm and easy steering is a result of precision ball bearing being embedded into the swivel head during injection process, a procedure that secure the bearing and adding extra strength to the yoke at the same time. Total water proofing can be achieved by using stainless steel metal components and washable lubricant.



While stainless steel castor is the best choice to use around moisture prone areas, it is often less desirable for its obtrusive metallic effect, especially used with health care equipment. When conditions demand for a human touch and subtleness, our plastic PT castor would be the best choice without debate.

Application:

Rehabilitating trolleys/carts; medical cabinets; food carts; infant carriages; business machines.

Size Available:

100x25, 125x32mm

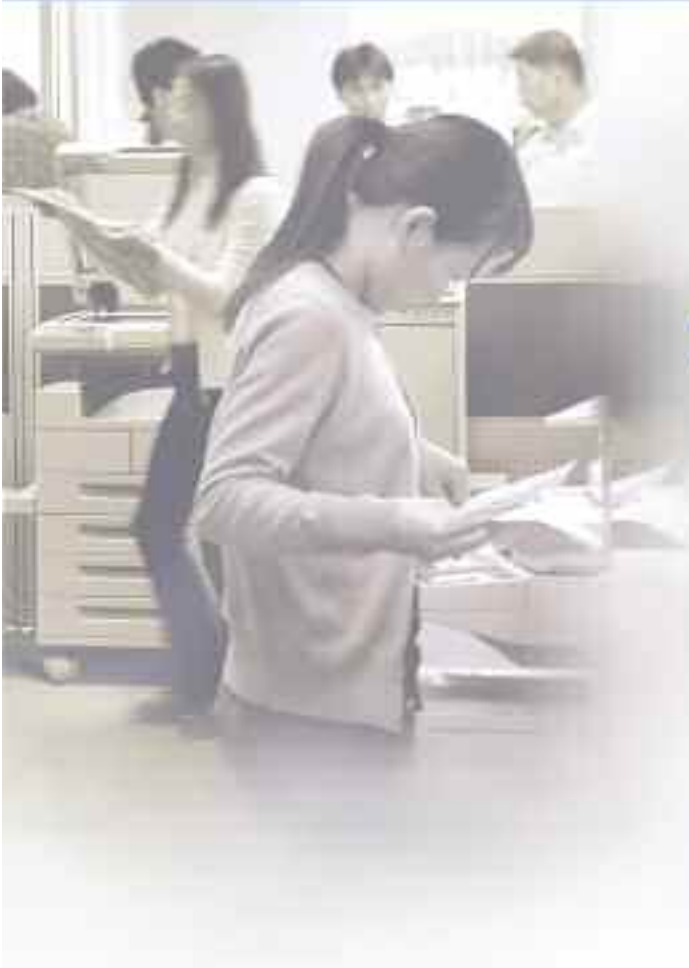

Nylon 6 with fiber-glass reinforced body, precision ball bearing swivel head, thermoplastic rubber wheel with ball bearings.



TB Total locking brake
Total Lock system locks both swivel head and wheel simultaneously for a secure parking. Grey color Nylon brake pedal. Available for Polytech series only.



DB Directional locking brake
Directional Lock permits free wheel rotation while swivel head remains locked, an easy way to keep equipment traveling straight. Green color Nylon brake pedal. Available for Polytech series only.

P Top Plate Fitting

TPR Wheel Plastic hub, grey color thermoplastic rubber tire

Brake type:	100	125	150	175	200	225	250	275	300	kg	Code:
TB Total locking brake	100	25	32	95 x 70	75 x 52 / 72 x 45	8.0	35.0	142.0	60		PT120E11W402
	125	32	40	95 x 70	75 x 52 / 72 x 45	8.0	44.0	165.0	100		PT125E11W302
DB Dir. locking brake	125	32	40	95 x 70	75 x 52 / 72 x 45	8.0	44.0	165.0	100		PT125DB11W302
	150	38	48	95 x 70	75 x 52 / 72 x 45	8.0	44.0	165.0	100		PT150E11W502
Non brake Free swivel	100	25	32	95 x 70	75 x 52 / 72 x 45	8.0	35.0	142.0	60		PT100F11W402
	125	32	40	95 x 70	75 x 52 / 72 x 45	8.0	44.0	165.0	100		PT125F11W302

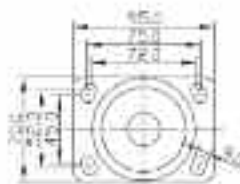

P1

