



Description

A 5 figure medium duty counter designed for applications where a rotary counter with a quick reset is desirable. When a 1' circumference measuring wheel is used with our standard counter, the counter will display feet and inches. Consult the factory if you have custom applications.

Features

- Counter will add and subtract
- Push button reset
- Versatile mounting
- 1,000 revolutions per minute (100 feet per minute)

Options

- Double shaft
- Wheel color
- Figure color
- Ratios
- Mounting
- Case color
- 98WF - Measuring Wheel - 12" circumference

Specifications

Figures: 5 figures, 0.20" [5mm] high
Reset: Push-button
Rotation: Top going
Shaft Extension: 0.250" diameter, left hand or right hand

Speed: 1,000 revolutions/minute (100 feet/minute)
Operation Life: Beyond 50 million
Temp. Range: -15°F to 140°F [-26°C to +60°C]
Weight: 10 oz. [283g]

Models Description

11-0825 Left-hand, top-going, add & subtract

Models Description

11-0845 Right-hand, top-going, add & subtract

Dimensions

Left - Hand Shaft

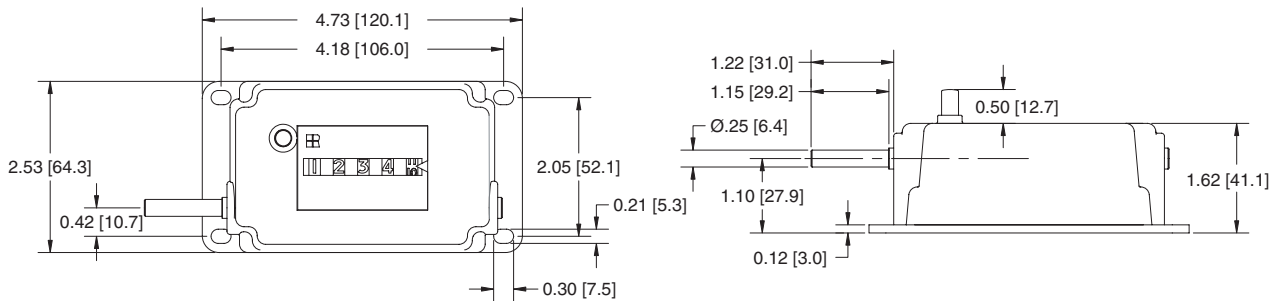

Applications

Linear measuring

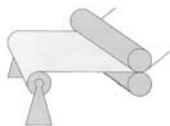

Machine revolutions

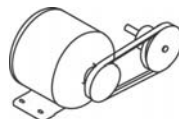

Positioning

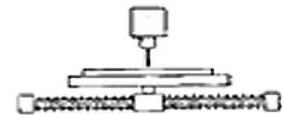

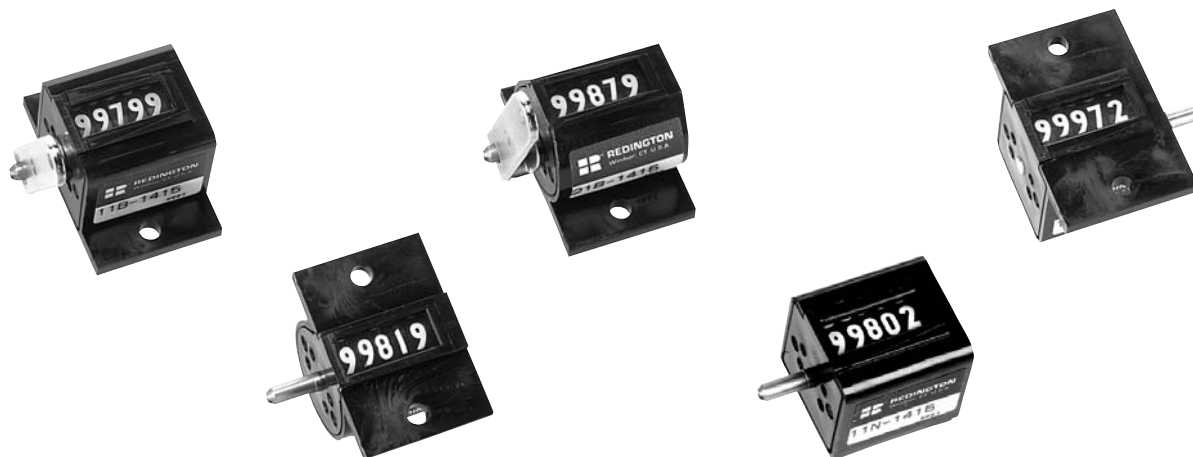

Description

The Model 14 is a compact, 5 figure, non-reset totalizer in a molded case with stainless steel shaft. Four types of drives are available and five case configurations. An ideal solution when application requirements call for a low cost and compact totalizer.

Features

- Four types of drives
- Choice of five case configurations
- Built-in non-overthrow mechanism on stroke counters
- Built-in internal stops on stroke counters
- 5 Figure: white on black background

Options

- Mounting
- Double shafts
- Figure background and case colors
- Sealed

Specifications

Figures: 5 figures, white on black, 0.16" [4mm] high
Reset: Non-reset
Rotation: Top-coming or top-going
Shaft Extension: Right-hand or left-hand
Shaft Diameter: 0.125" [3.2mm]
Speed: Stroke: 1,000 counts/minute
 Revolution: 3,000 counts/minute
 Direct: 15,000 counts/minute
 Rotary Ratchet:
 3,000 counts/minute rotary mode
 1,500 counts/minute in oscillating mode
Weight: 0.5 oz. [14g]
Temp: -40°F to +160°F [-40°C to +71°C]
Operating Torque: Stroke; 0.8 to 2.0 in/oz
 at 75°F Revolution; 0.15 in/oz
 Direct; 0.15 in/oz
 Rotary Ratchet; 0.3 to 1.0 in/oz

Case Types: Square base mount
 Square panel mount
 Square - no flange
 Cylindrical base mount
 Cylindrical panel mount
Drive Types:
 Stroke: typical count stroke 39° to 48°
 typical total stroke 50° to 52°
 Revolution: adds or subtracts one(1) count per revolution.
 Direct: adds or subtracts ten (10) counts per revolution
 Rotary Ratchet: adds ten (10) counts per revolution
 adds only one (1) count per 36° to 60° oscillation.

Models	Description	Models	Description
11B-1415	lh, top coming, stroke, sq case, base mt	11B-1435	rh, top coming, stroke, sq case, base mt
11B-1515	lh, top coming, rev. drive, sq case, base mt	11B-1535	rh, top coming, rev. drive, sq case, base mt
11B-1615	lh, top coming, direct drive, sq case, base mt	11B-1635	rh, top coming, direct drive, sq case, base mt
11B-1715	lh, top coming, rotary rat., sq case, base mt	11B-1735	rh, top coming, rotary rat., sq case, base mt
11B-1425	lh, top going, stroke, sq case, base mt	11B-1445	rh, top going, stroke, sq case, base mt
11B-1525	lh, top going, rev. drive, sq case, base mt	11B-1545	rh, top going, rev drive, sq case, base mt
11B-1625	lh, top going, direct drive, sq case, base mt	11B-1645	rh, top going, direct drive, sq case, base mt
11B-1725	lh, top going, rotary rat., sq case, base mt	11B-1745	rh, top going, rotary rat., sq case, base mt

rat = ratchet
 rev = revolution
 lh = left hand
 rh = right hand
 sq = square
 mt = mount

Similar products are also available in the following configurations:
 Square case - panel mount change 11B to 11P
 Square case - without flange change 11B to 11N
 Cylindrical case - base mount change 11B to 21B
 Cylindrical case - panel mount change 11B to 21P



Dimensions

Square Case Base Mount

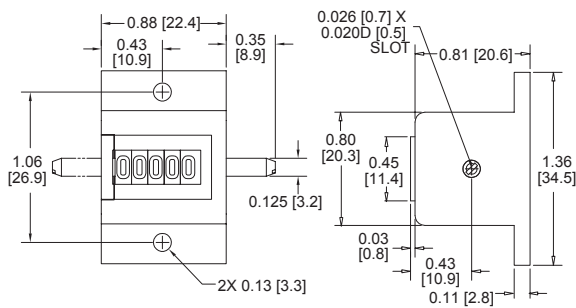

Square Case Without Flange

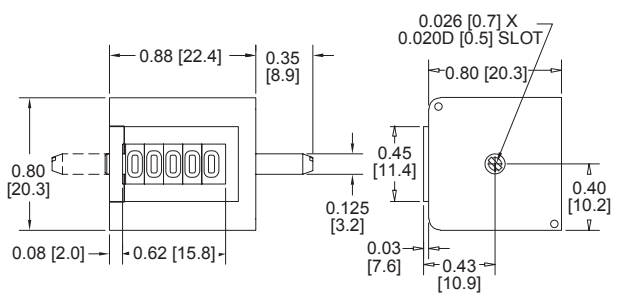

Square Case Panel Mount

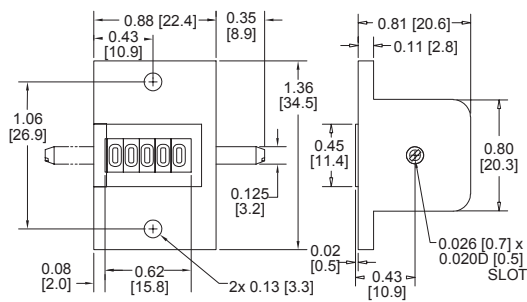

Cylindrical Case Base Mount

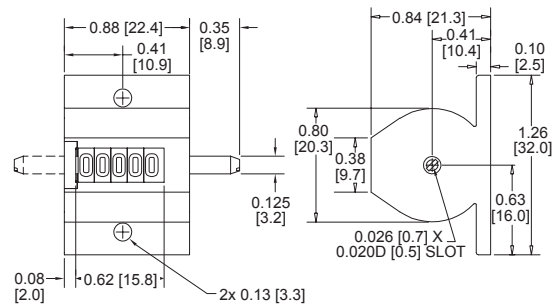

Cylindrical Case Panel Mount

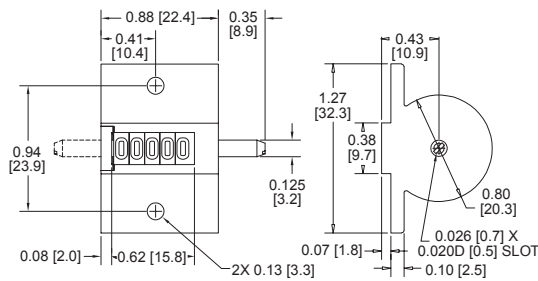

Short Lever (10006-028S)

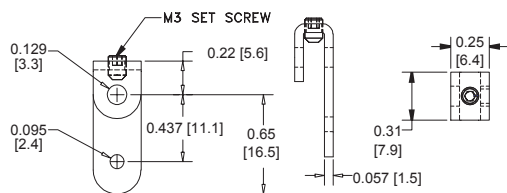

Standard Lever (10006-027S)

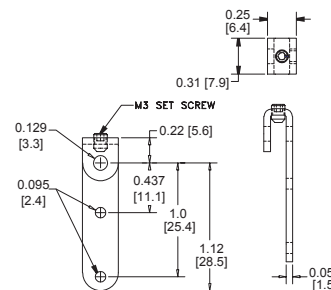

Applications

Circuit breakers



Vending machines



Gaming machines



Business and office equipment



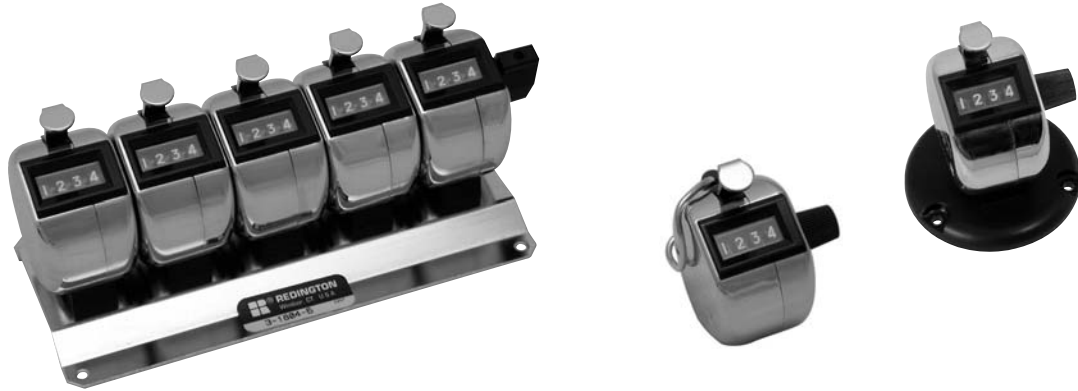

Description

A 4 figure, hand-held or desk mounted reset counter with push-button actuator. Case is chrome plated steel. Hand-held model comes with thumb ring for ease of use. Single desk mounted style has plastic base with mounting holes. Multiple desk units, from 2 to 10, mounted on a single base with a common reset. These tallies are a convenient way to count inventory, attendance, traffic, blood cells, or food portions.

Features

- Chrome plated steel housing
- Long life

Options

- Multiple units

Specifications

Figures: 4 figures, white on black, 0.16" [4mm] high
Reset: Knob
Operating Life: Beyond 5 million counts

Temp. Range: -15°F to +140°F [-26°C to +60°C]
Weight: 3.5 oz. [99g]

Models	Description	Models	Description
12-1804	Hand Tally with finger ring	3-1804-6	Versa Tally: 6 units, common reset and base
13-1804	Desk Tally with mousing base	3-1804-7	Versa Tally: 7 units, common reset and base
3-1804-2	Versa Tally: 2 units, common reset and base	3-1804-8	Versa Tally: 8 units, common reset and base
3-1804-3	Versa Tally: 3 units, common reset and base	3-1804-9	Versa Tally: 9 units, common reset and base
3-1804-4	Versa Tally: 4 units, common reset and base	3-1804-10	Versa Tally: 10 units, common reset and base
3-1804-5	Versa Tally: 5 units, common reset and base		

* Items in bold are normally in factory stock.

Dimensions

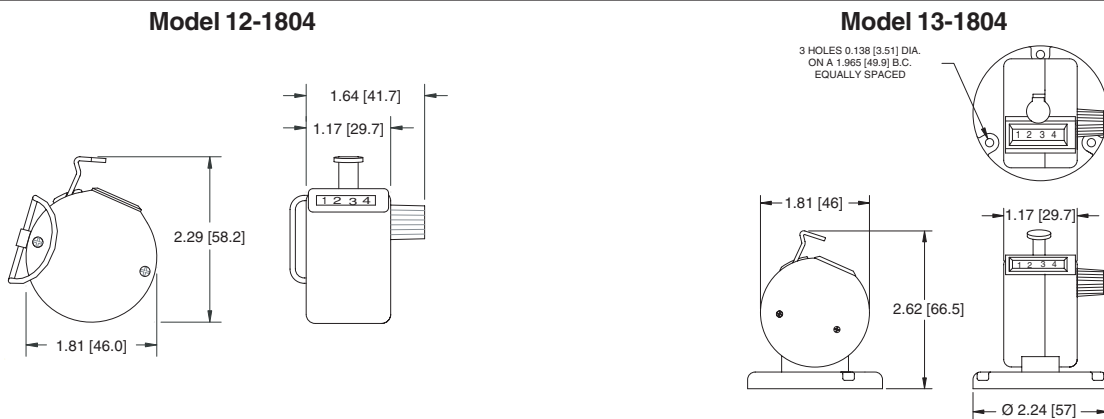

Applications

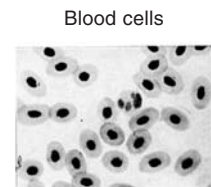



Description

The Redington "Victor" counters are manually operated mechanical totalizers ideal for use when you need to count more than one item at the same time. Models are available from a single counter to a maximum of 20 units (4 wide X 5 high). All modules have 4-figure counters and a common rotary reset for the entire row. Each unit can be easily labeled using removable paper tabs. Applications include Lab Counters, Traffic Surveys, Inventory Control, Inspection Tallies, QC Counters, Bus Counters and Point-of-Sale Records.

Features

- Paper tabs for labeling
- Common reset for each row
- Positive action pushbutton
- Lubrication not required
- Quick, simple to operate and accurate

Options

- Multiple units - up to 20 counters

Specifications

Figures: 4 figures, white on black, 0.12" [3mm] high
Reset: Knob

Weight: ~3.0oz. [85g] per unit

Models	Description	Models	Description
11-1904	Modular Tally, single unit	14-1904	Modular Tally, 1 unit wide x 4 units high
21-1904	Modular Tally, 2 units wide x 1 unit high	24-1904	Modular Tally, 2 units wide x 4 units high
31-1904	Modular Tally, 3 units wide x 1 unit high	34-1904	Modular Tally, 3 units wide x 4 units high
41-1904	Modular Tally, 4 units wide x 1 unit high	44-1904	Modular Tally, 4 units wide x 4 units high
12-1904	Modular Tally, 1 unit wide x 2 units high	15-1904	Modular Tally, 1 unit wide x 5 units high
22-1904	Modular Tally, 2 units wide x 2 units high	25-1904	Modular Tally, 2 units wide x 5 units high
32-1904	Modular Tally, 3 units wide x 2 units high	35-1904	Modular Tally, 3 units wide x 5 units high
42-1904	Modular Tally, 4 units wide x 2 units high	45-1904	Modular Tally, 4 units wide x 5 units high
13-1904	Modular Tally, 1 unit wide x 3 units high		
23-1904	Modular Tally, 2 units wide x 3 units high		
33-1904	Modular Tally, 3 units wide x 3 units high		
43-1904	Modular Tally, 4 units wide x 3 units high		

Dimensions

Dimensions for a single unit are shown to the right. To calculate the approximate size of an assembled unit, add 1.5" [37] to the width for each additional unit in a row, and add 2.6" [66] to the depth and 1.5" [37] to the height, for each additional row.

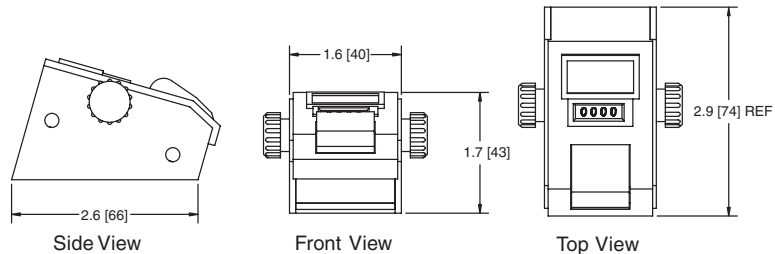

Applications

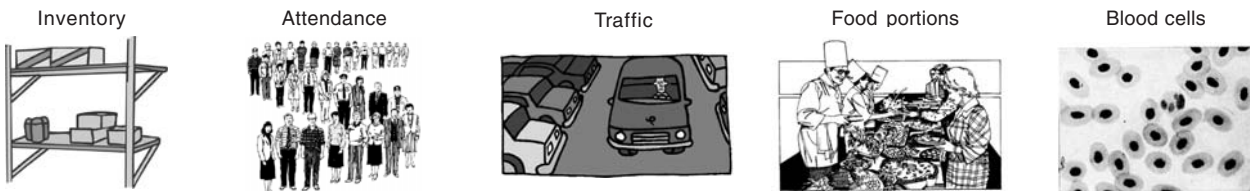



Description

A highly versatile, 5 figure stroke counter. Numbers are large and distinctive for easy viewing even when above or below eye level. Ruggedly built for years of trouble-free use. An excellent choice for counting parts produced.

Features

- Durable
- Large figures
- Reliable

Options

- Non-reset
- Large reset knob
- Right or left-hand shaft extension
- 10007-010S - additional lever and spring

Specifications

Figures: 5 figures, white on black, 0.19" [5mm] high
Reset: Knob
Speed: 1,000 counts/minute
Rotation: Top-coming or top-going
Count Stroke: 49° Min. - 60° Max.

Shaft Extension: Right-hand or left-hand
Shaft Diameter: 0.125" [3.2mm]
Operating Life: Beyond 50 million counts
Temp. Range: -15°F to +140°F [-26°C to +60°C]
Weight: 5 oz. [142g]

Models	Description	Models	Description
1-2015	Left-hand, top-coming, standard reset knob	1-2035	Right-hand, top-coming, standard reset knob
1-2025	Left-hand, top-going, standard reset knob	1-2045	Right-hand, top-going, standard reset knob

* Items in bold are normally in factory stock.

Dimensions

Right-Hand Shaft

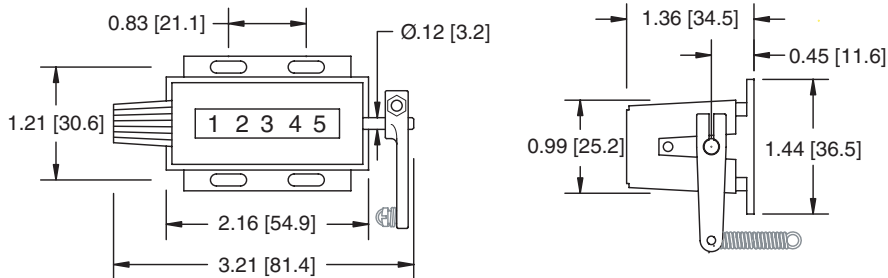

Mounting holes: 0.13" x 0.38" [3.3 x 9.7mm] slots

Applications

Punch press

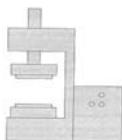

Machine cycles

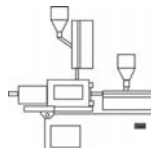

Secondary machines





Description

A compact, 5 figure, rotary counter, indicating 10 counts/revolution. Design and compact size make it ideally suited for office and test equipment, coin counting and other direct reading instruments.

Features

- Compact size
- 5 figures
- Long life

Options

- Large reset knob
- Special shaft

Specifications

Figures:	5 figures, white on black, 0.19" [5mm] high	Shaft Diameter:	0.125" [3.2mm]
Reset:	Knob	Ratio:	10 counts/revolution
Speed:	1,000 revolutions/minute	Operating Life:	Beyond 50 million counts
Rotation:	Top-coming or top-going	Temp. Range:	-15°F to +140°F [-26°C to +60°C]
Shaft Extension:	Right-hand or left-hand	Weight:	4 oz. [113g]

Models	Description	Models	Description
1-2215	Left-hand, top-coming, add only	7-2225	Left-hand, top-going, add and subtract
1-2225	Left-hand, top-going, add only	7-2235	Right-hand, top-coming, add and subtract
1-2235	Right-hand, top-coming, add only	7-2245	Right-hand, top-going, add and subtract
1-2245	Right-hand, top-going, add only	1-2315	Left-hand, top-coming, add and subtract, non-reset
7-2215	Left-hand, top-coming, add and subtract	1-2325	Left-hand, top-going, add and subtract, non-reset

* Items in bold are normally in factory stock.

Dimensions

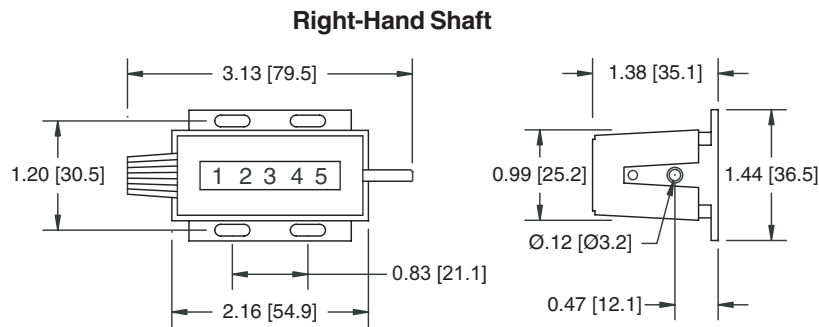

Mounting holes: 0.13" x 0.38" [3.3 x 9.7] slots

Applications

Production equipment

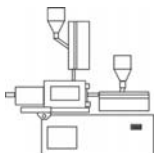

Spooling



Positioning





Description

A heavy-duty, 5 figure, internal reset, stroke counter. Available in either right-hand or left-hand shaft extension.

Features

- Heavy-duty
- Internal reset

Options

- Right or left-hand shaft extension
- 1022-006S - additional spring

Specifications

Figures: 5 figures, white on black, 0.31" [8mm] high
Reset: Internal - lift cover, reset wheels
Speed: 750 counts/minute
Rotation: Top-coming
Count Stroke: 36° Min. - 45° Max.

Shaft Extension: Right-hand or left-hand
Operating Life: Beyond 200 million counts
Temp. Range: -15°F to +140°F [-26°C to +60°C]
Weight: 24 oz. [680g]

Models

Description

1-2715 Left-hand, top-coming

Models

Description

1-2735 Right-hand, top-coming

* Items in bold are normally in factory stock.

Dimensions

Right-Hand Shaft

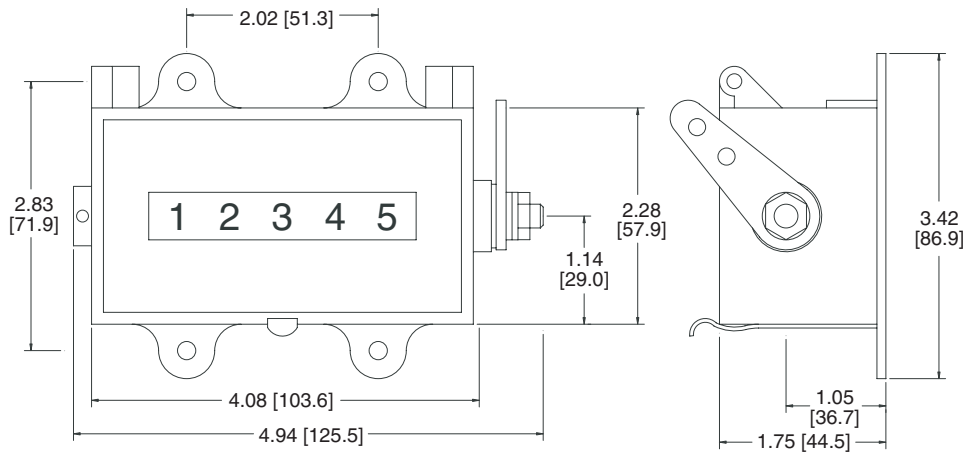

Mounting holes: 0.19" [4.8mm] Dia.

Applications

Punch press

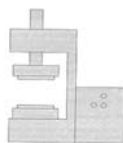

Secondary Machines



Machine cycles

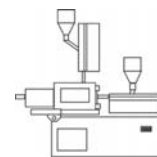



Description

A 5 figure, rugged stroke counter, with right-hand shaft extension, operating lever and attached spring. Rated at 600 counts per minute, this heavy-duty model is well suited for most industrial applications.

Features

- Heavy-duty
- 600 CPM
- 5 Figures

Options

- Lever modifications
- 1022-006S - additional spring

Specifications

Figures: 5 figures, white on black, 0.27" [7mm] high
Reset: Knob, internal, or lock and key
Speed: 600 counts/minute
Rotation: Top-coming
Count Stroke: 36° Min. - 45° Max.

Shaft Extension: Right-hand
Operating Life: Beyond 200 million counts
Temp. Range: -15°F to +140°F [-26°C to +60°C]
Weight: 20 oz. [567g]

Models

Description

3-2835 Right-hand, top-coming, internal reset
4-2835 Right-hand, top-coming, knob reset

Models

Description

5-2835 Right-hand, top-coming, lock and key reset

* Items in bold are normally in factory stock.

Dimensions

Right - Hand Shaft

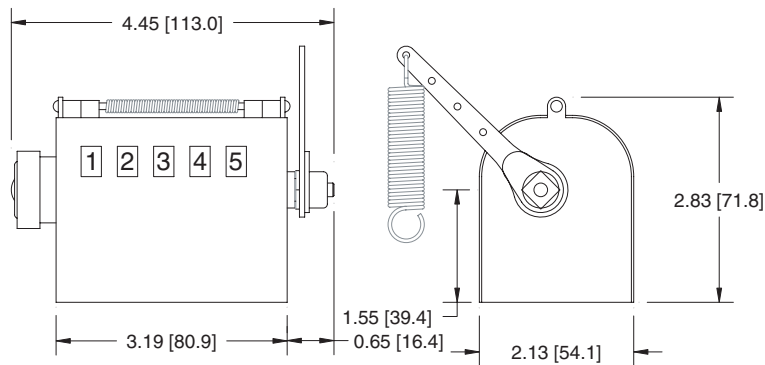

Mounting holes: 0.18" [4.6mm] Dia.

Applications

Punch press

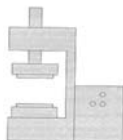

Machine cycles

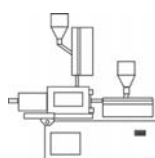

Shears

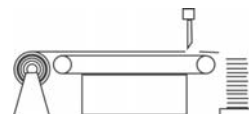



Description

A 6 figure, general purpose heavy duty industrial stroke counter designed for high count rates and continuous operation even under the most adverse operating conditions. Corrosion resistant material and finishes. Large, easy-to-read numbers.

Features

- Heavy duty
- High count rates
- Corrosion resistant

Options

- Non-reset
- Double shaft extensions
- Special mounting bases
- Weatherized versions
- 1022-006S - additional spring
- 1255-004S - additional lever

Specifications

Figures: 6 figures, white on black, 0.30" [7.6mm] high
Reset: Knob or lock and key
Speed: 1,000 counts/minute
Rotation: Top-coming or top-going
Count Stroke: 40° Min. - 70° Max.

Shaft Extension: Right-hand or left-hand
Shaft Diameter: 0.25" [6.4mm]
Operating Life: Beyond 100 million counts
Temp. Range: -15°F to +140°F [-26°C to +60°C]
Weight: 18 oz. [510g]

Models	Description	Models	Description
1-2916	Left-hand, top-coming, standard reset knob	1-2946	Right-hand, top-going, standard reset knob
1-2926	Left-hand, top-going, standard reset knob	2-2936	Right-hand, top-coming, lock and key reset
1-2936	Right-hand, top-coming, standard reset knob	V1-2936	Right-hand, top-coming, standard reset knob, V-base

* Items in bold are normally in factory stock.

Dimensions

Right - Hand Shaft

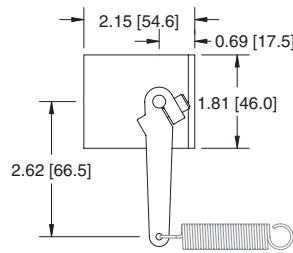
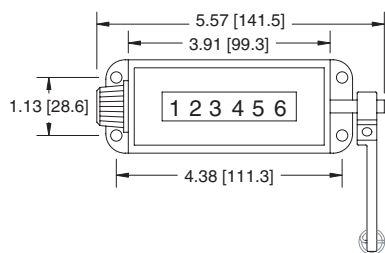

V - Mount

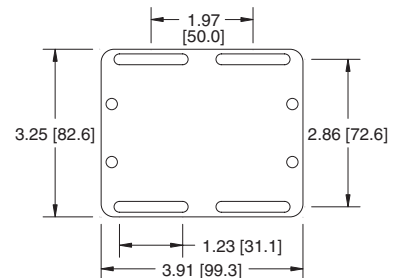

Mounting holes: 0.22" [5.6mm] Dia.

Applications

Punch presses

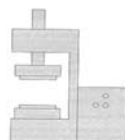

Shears

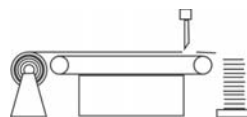

Cement trucks





Description

A 6 figure, general purpose, industrial rotary counter designed for use on equipment where environmental conditions are far from ideal. Various count ratios make it suitable for winding equipment, measuring devices and direct reading instruments.

Features

- Heavy duty
- High count rates
- Corrosion resistant

Options

- Non-reset
- Subtractive
- Double shaft extensions
- Special mounting bases
- Weatherized versions
- 98WF - Measuring Wheel - 12" circumference

Specifications

Figures:	6 figures, white on black, 0.30" [7.6mm] high	Shaft Extension:	Right-hand or left-hand
Reset:	Knob or lock and key	Shaft Diameter:	0.25" [6.4mm]
Speed:	2,500 counts/minute or revolutions/minute, whichever is lower	Ratio:	1 count/revolution or 10 counts/revolution
Rotation:	Top-coming or top-going, to add. Will not subtract if rotation is reversed	Operating Life:	Beyond 100 million counts
		Temp. Range:	-15°F to +140°F [-26°C to +60°C]
		Weight:	18 oz. [510g]

Models	Description	Models	Description
11-2916	Left-hand, top-coming, 10 counts/revolution	21-2936	Right-hand, top-coming, 1 count/revolution
11-2936	Right-hand, top-coming, 10 counts/revolution	21-2946	Right-hand, top-going, 1 count/revolution
21-2916	Left-hand, top-coming, 1 count/revolution	22-2936	Right-hand, top-coming, 1 count/revolution, lock & key reset,
21-2926	Left-hand, top-going, 1 count/revolution		

Dimensions

Right - Hand Shaft

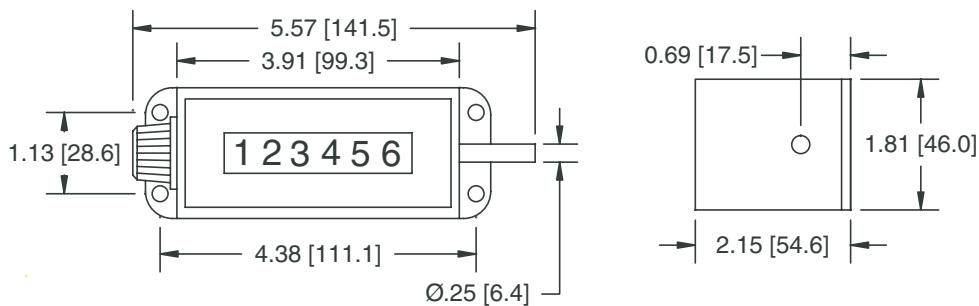

Mounting holes: 0.22" [5.6mm] Dia.

Applications

Winding equipment

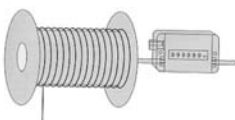

Spooling

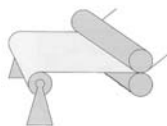

Positioning

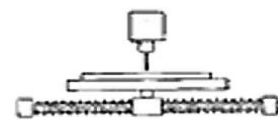

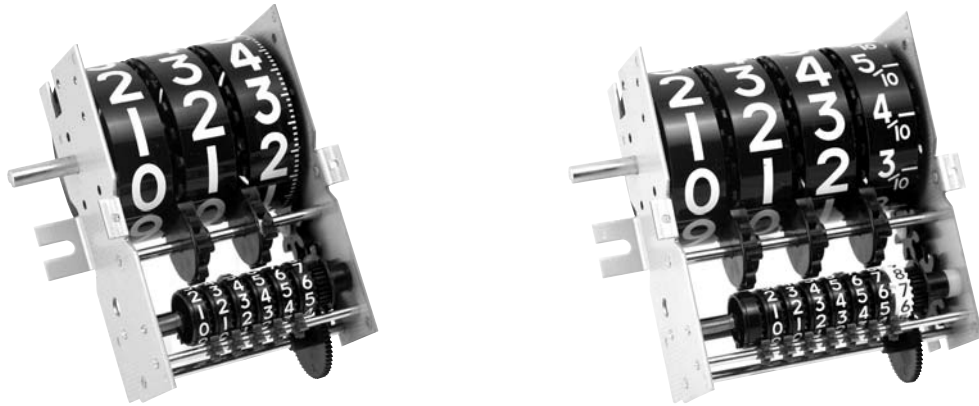

Description

The Model 41 is a 3-figure or 4-figure mechanical register and is used to display gallons or liters output from a dispenser or pump. The large figure display can be reset with the rotary reset shaft. A smaller, non-reset, mechanical totalizer is also included to record total product dispensed.

Features

- Large easy to read figures
- Time tested, reliable and durable
- Wide operating temperature range
- All non-corrosive parts
- Spring loaded totalizer is pre-settable
- No lubrication required

Options

- Gallons or liters
- Reset shaft configuration
- Reset shaft: right hand, left hand, or both

Specifications

Figures:

Main Display: 3 or 4 figures, white on black, 0.65" [16.5mm] high

Totalizer: 0.19" [5mm] white on black

Reset: Rotary reset. Reset knob supplied by customer

Reset Shaft: 0.25" [6.4mm] diameter

Speed:

40 gallons per/minute, 400 liters per/minute

Operation Life:

1 million gallons, 10 million liters

Temp. Range:

-40°F to +150°F [-40°C to +65°C]

Weight:

3-figure - 9oz [255g], 4-figure - 11oz [312g]

Models

Description

1-4103 3-figures, gallon display
 2-4104 4-figures, gallon display

Models

Description

2-4103 3-figures, liter display
 3-4104 4-figures, liter display

Dimensions

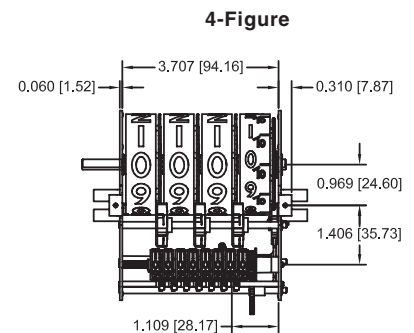
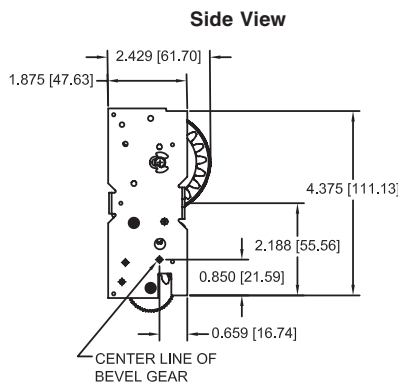
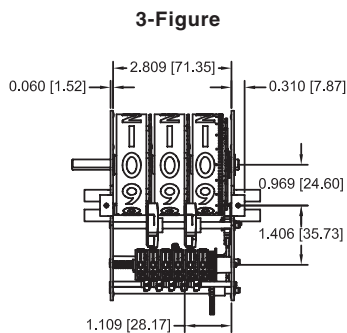

Applications

Pumps and Flow Meters





With Lever & Spring



With Thumb Lever

Description

These 5 figure stroke counters are especially designed for limited space and high count life applications. The advanced drive system translates into exceptionally high operating speeds, extended operating life, for fast and accurate readings. Ideal for copiers, printing presses, cut-off machines, and piece-part counting applications. Also available with a thumb lever for use as a tally counter.

Features

- Compact size
- Reliability
- Low cost

Options

- Special levers
- 10011-001S - additional spring
- 10007-009S - lever and spring

Specifications

Figures: 5 figures, white on black, 0.19" [5mm] high
Reset: Standard or large knob, non-reset
Speed: 500 counts/minute
Rotation: Top-coming or top-going
Count Stroke: 40° Min. - 45° Max.

Shaft Extension: Right-hand or left-hand
Shaft Diameter: 0.156" [4.0mm]
Operating Life: Beyond 5 million counts
Temp. Range: -15°F to +140°F [-25°C to +60°C]
Weight: 2 oz. [57g]

Models	Description	Models	Description
1-4615	Left-hand, top-coming, standard reset knob	2-4615	Left-hand, top-coming, large reset knob
1-4625	Left-hand, top-going, standard reset knob	2-4625	Left-hand, top-going, large reset knob
1-4635	Right-hand, top-coming, standard reset knob	2-4635	Right-hand, top-coming, large reset knob
1-4645	Right-hand, top-going, standard reset knob	2-4645	Right-hand, top-going, large reset knob
1-4635T	Right-hand, top-coming, std. reset knob, with thumb lever	5-4645	Right-hand, top-going, non-reset

* Items in bold are normally in factory stock.

Dimensions

Right - Hand Shaft

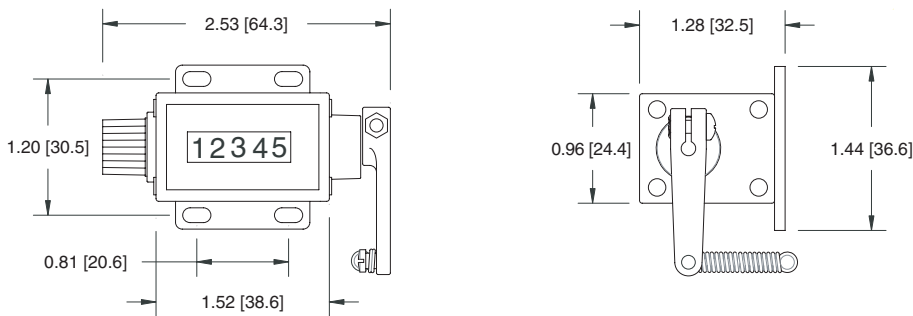

Mounting holes: 0.13" x 0.24" [3.3 x 6.1mm] slots

Applications

Copiers



Printing presses

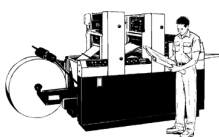

Farm equipment

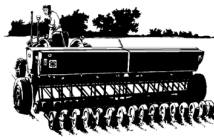

Piece-part counting

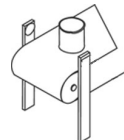

Cut-off machines





Description

These rugged revolution counters are completely sealed, tamper resistant, and maintenance-free. They can be mounted on a rotating shaft or wheel. Adds in either direction, and records revolutions, miles, kilometers, or acres. They are used on material handling equipment, farm machinery, rapid transit vehicles, street sweepers, golf carts, and construction equipment.

Features

- Sealed
- Tamper resistant
- Bi-directional

Options

- Face plate
- Custom calibrations

Specifications

Figures: 7 figures, 0.19" [5mm] high
Temp. Range: -50°F to +180°F [-45°C to +82°C]
Weight: 1.5 Lbs. [0.7kg]

Models	Description	Models	Description
750-0002	Reading x 10 = Total Revolutions (Revolutions)	750-0114	Reading x 100 = Revolutions (Revolutions)
750-0007	(9.5L - 15) x 15' (Acres)	750-0156	798 Revolutions per Acre (Acres)
750-0016	364 Revolutions per Acre (Acres)		

Consult factory for a counter to meet your specific needs.

Dimensions

Hubodometer

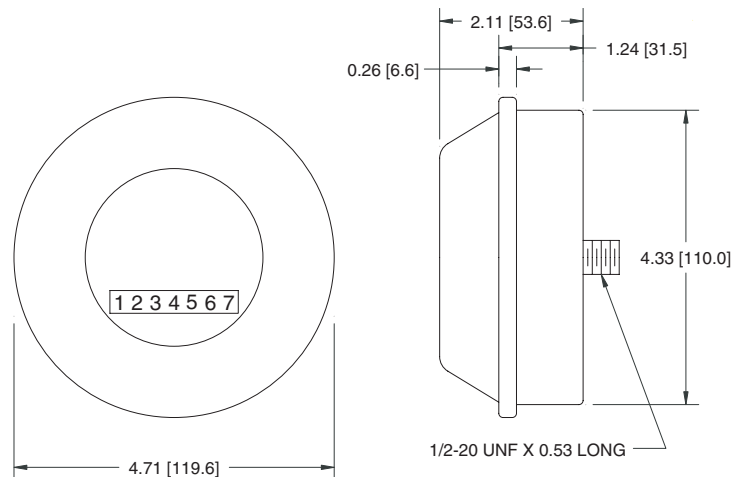

Applications

Rapid transit vehicles



Farm machinery

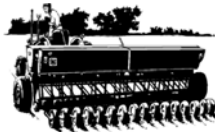

Golf carts



Construction equipment





Description

The Redington Model E45-1804 provides the user with an economical upgrade from the traditional mechanical modular tally counters and at a lower cost. A single module displays five 4-digit LCD's counters, internal 5-digits (99999), total counter is 6-digits (999999), and provides RS-232C serial communications. All of the stored data, maximum of 99 records, (count data, sum data) on the E45-1804 can be read and viewed on a PC through serial communications. The 4 least significant digits of the counter can be viewed on the display. To view all 5 digits, please use the communications feature of the unit to recall the complete internal counter data. Free software is available from our web site, redingtoncounters.com. The Model E45-1804 is self powered by 4 AAA batteries, which makes it ideal for field use.

Features

- Communications functions to PC; convenient for totalizing and analyzing
- Battery life - 200 hours (low battery indicator)
- 7 segment LCD (digit size: 0.2" [5mm] height)
- Memory storage for 99 data records
- Internal 5-digit counter and 6-digit total counter
- Strap hole for lanyard
- Classification sticker
- Light weight (1/3 of a traditional metal type)
- Excellent tactile feel buttons
- Modular construction allows connecting multiple counters

Specifications

Display:	LCD 4 digits height 0.2" [5mm] counters (x5) 6 digits total counter & record number
Reset:	Push button
Memory:	Maximum of 99 records
Dimensions:	2.44" (H) x 5.5" (W) x 0.83" (D) [62 (H) x 140 (W) x 21 (D) mm]
Accessories:	Instruction manual, batteries (4), stickers (5)
Approvals:	CE compliant
Weight:	5oz [130g] (batteries included)
Data Output:	RS-232 PC Serial Interface
Battery Operating Life:	200 hours, power off when not in use (4) AAA (1.5) alkaline type batteries
Software/Operating Instructions:	Download from Redington web site
Communications Cable:	Use any market available RS 232 cable (straight) to connect to the PC and a D-SUB 9 pin (female) connector for connection to the E45-1804
Data Output:	RS-232 PC Serial Interface
Operating Temperature:	14°F to 122°F [-10°C to 50°C] 85% RH max.

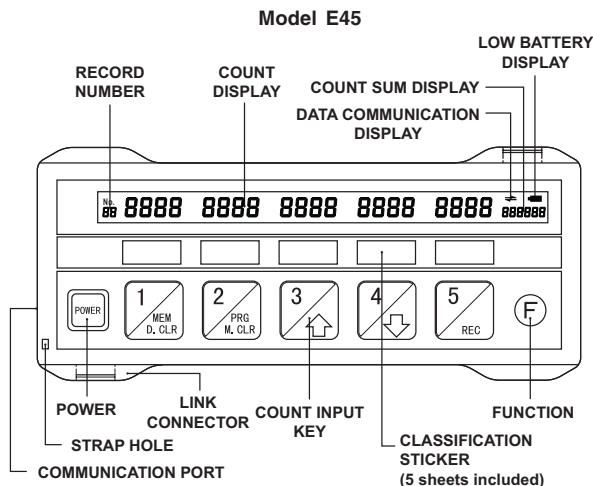

Models Description

E45-1804 Electronic Multi Tally (x5 LCD) with serial communications

* Item is normally in factory stock.

Applications

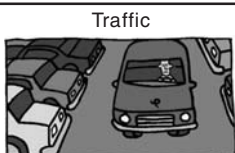

Traffic

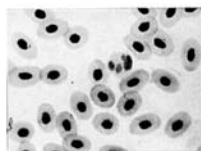

Lab Counter

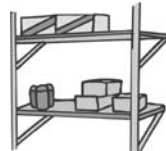

Inventory



Attendance

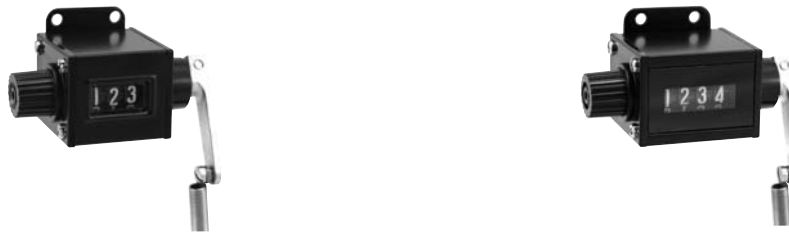

Description

This 3 or 4 figure stroke counter with operating lever, spring assembly and reset knob, requires minimal space for mounting plus offers a high count rate and long life. The Model PCU can be reset during operation without damage. All PCU's are designed to minimize internal contamination, making them an excellent choice for outdoor use.

Features

- 3 or 4 figure
- Compact size
- Suitable for outdoor use

Options

- Non-reset
- Large reset knob

Specifications

Figures: 3 or 4 figures, white on black, 0.19" [5mm] high
Reset: Knob
Speed: 600 counts/minute
Rotation: Top-coming or top-going
Count Stroke: 40° Min. - 45° Max.

Shaft Extension: Right-hand or left-hand
Shaft Diameter: 0.156" [4mm]
Operating Life: Beyond 50 million counts
Temp. Range: -15°F to +140°F [-26°C to +60°C]
Weight: 2 oz. [57g]

Models

Description

- 1-PCU-13 Left-hand, top-coming, 3 figure
- 1-PCU-33 Right-hand, top-coming, 3 figure
- 1-PCU-33T Right-hand, top-coming, 3 figure, with thumb lever
- 1-PCU-43 Right-hand, top-going, 3 figure

Models

Description

- 1-PCU-14 Left-hand, top-coming, 4 figure
- 1-PCU-24 Left-hand, top-going, 4 figure
- 1-PCU-34 Right-hand, top-coming, 4 figure
- 1-PCU-44 Right-hand, top-going, 4 figure

Dimensions

1-PCU-13

1-PCU-14

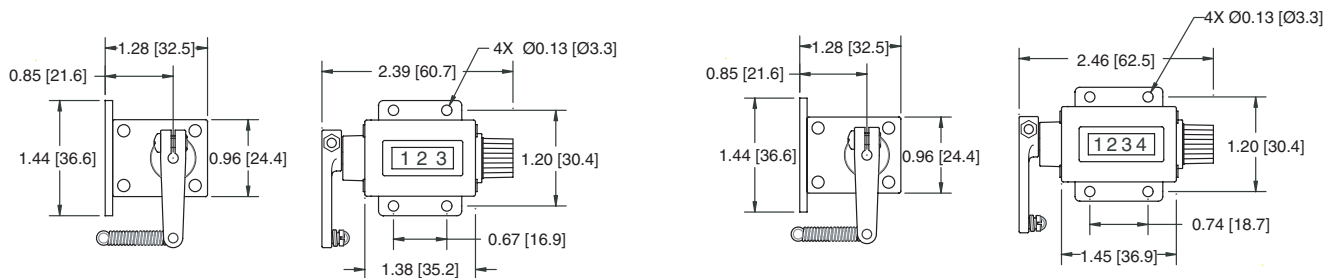

Applications

Secondary Machines



Shears



Farm Machinery

