

<u>Item</u>	<u>Page #</u>
Dolly Casters	2
Stage / Scene Shifting Casters	3
Gate & Ladder Casters	4
Leveling Casters	5-6
High-Temp Bakery Casters	7
Glass Handling Casters	8-9
Sanitary Casters	10-11
V-Groove Casters	12-13
Kingpinless Pneumatic Casters	14-15
Semi-Pneumatic Casters	16
Pneumatic Casters	17-18
Polished Brass Pneumatic Casters	19
Pneumatic Cantilever-Style Dual Wheel Casters	20
Scaffold Casters	21



**Scene Shifting
Dolly
(Kingpinless Swivel
Section & Nylacron™
Wheels with Precision
Bearings Recommended)**

Acorn™ can supply any size and type caster rig with any type wheel with proper size precision ball bearings. Call, fax or e-mail for application assistance, or visit our website to view our complete catalog in PDF format.

Visit our Web site for new products
www.acornindprod.com

**Kingpinless
V-Groove Caster**



**Kingpinless
Pneumatic
Caster**



LOW WEIGHT TWIN WHEEL CASTERS

Designed for special applications where heavy equipment is moved over level surfaces. Low Height dual wheel casters (type LL) have high load capacity in relation to its overall height. This is due to the center line of the wheels being within the circumference of the large diameter swivel bearing and the benefits of the differential action of dual wheels. Best suited for use on hard / smooth floors.

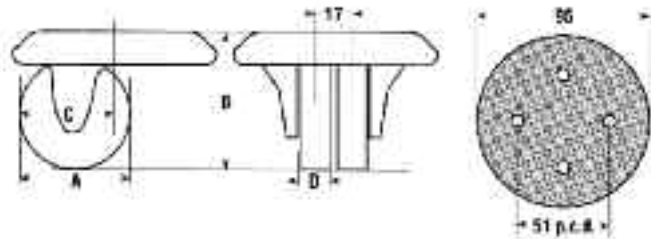

LOW HEIGHT TWIN WHEEL CASTERS

Dia. (A)	OAH (B)	Swl. Rad. (C)	Tread (D)	Wheel Type (Wheel Code)	Cap. (lb)	Part Number (Plain Bore)
50 mm	64	50	14	Nylacron™ (NY)	350	LHTW-NY/050/14/PB
(2 in)	64	50	14	Vulkollan/CI Core (VY)	350	LHTW-VY/050/14/PB
	64	50	14	Steel (ST)	600	LHTW-ST/050/14/PB

*All wheels are available with Precision Bearings for easier rolling under load. To specify, replace "Plain Bore" in part number with "26PB" (ex: LHTW-NY/050/14-26PB)



LOW WEIGHT DOLLY CASTERS

Designed for special applications where heavy equipment is moved over level surfaces. These casters have high load capacity in relation to its overall height. This is due to the kingpinless construction with a large diameter caster ball race and the wide wheel.

LOW HEIGHT DOLLY CASTERS

Dia. (A)	OAH (B)	Swl. Rad. (C)	Tread (D)	Wheel Type (Wheel Code)	Cap. (lb)	Part Number (Plain Bore)
85 mm	144	100	75	Urethane/CI Core (UY)	1100	05/72V-UY/085/75/PB
(3-3/8 in)	144	100	75	Vulkollan/CI Core (VY)	1100	05/72V-VY/085/75/PB
	144	100	75	Nylacron™ (NY)	1300	05/72V-NY/085/75/PB

*All wheels are available with Precision Bearings for easier rolling under load. To specify, replace "Plain Bore" in part number with "26PB" (ex: LHTW-NY/050/14-26PB)

OPTIONAL:

Four Position Swivel Lock - SL4 converts the swivel caster to a fixed position for straight line travel. Add SL4 to caster number.

Optional Top Plates Available

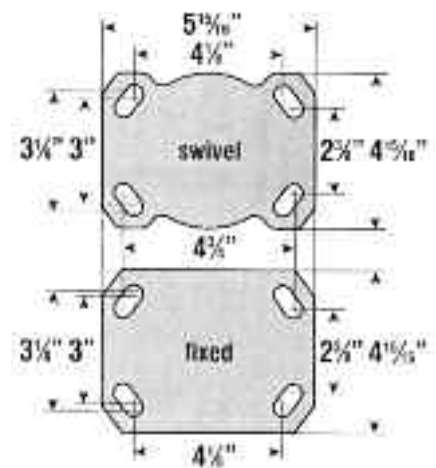
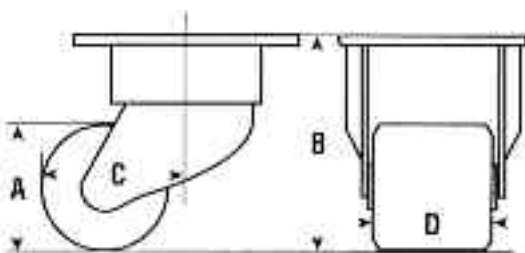

STAGE / SCENE SHIFTING CASTERS

Primarily used in the theatrical and movie making industries for moving scenery, props and stage equipment. StageMaster incorporates three swiveling casters attached to a heavy-duty swiveling platform base that easily mounts to the item to be moved. The swiveling action of the casters combined with the swiveling action of the platform base allows to operator to easily maneuver heavy, awkward devices in tight quarters with relative ease.

DESIGN CHARACTERISTICS

Single or Dual Wheel Caster Design: Dual wheel caster version with 2" or 2-1/2" diameter wheels. Single caster version with 2-1/2" or 3" diameter wheels.

Four-Sided Double Ball raceway: Hardened steel ball bearings in the load bearing and secondary thrust bearing tough the swivel raceway "on all four sides." This protects the central kingpin from shock loading for free swiveling under heavy loads.

Heat Treated Moving Parts: All moving parts are heat treated to a precise molecular depth and Rockwell hardness. This extends StageMaster life under rugged conditions and shock loads.

Raceway Dust Caps on Casters / Underbody Seal on Platform Base: Dust caps and underbody seals protect raceways from contamination by dust, dirt, moisture and other debris.

Thread Guards: Single-Wheel version only. Keeps unwanted materials out of wheel bearings thus increasing the life of the StageMaster assembly.

SWIVEL RIG OPTIONS

- Increased Capacities, Diameter and Sizes for any load capacity with Nylacron™ Wheels
- Kingpinless swivel section and Kingpinless casters recommended for heavy duty applications
- Black Oxide Finish. Other finishes available, consult Acorn™
- Wheel Brakes (Consult Acorn™)
- Wheel Materials & Diameters



**Scene Shifting Dollies
(Kingpinless Swivel Section & Nylacron™
Wheels with Precision Bearings
Recommended)**

OPTIONAL TOP PLATE

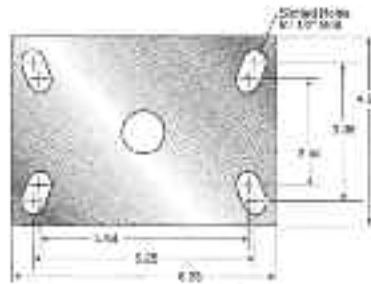

BOLT HOLE CENTERS

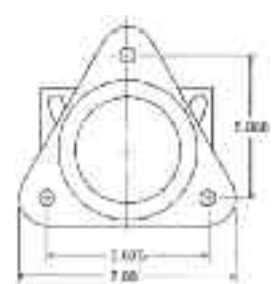

SWIVEL SECTION

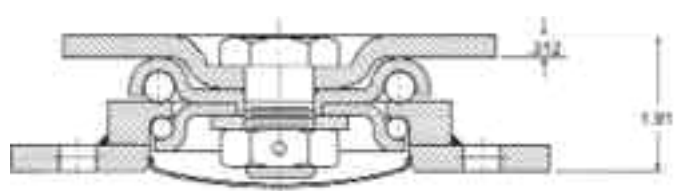

CASTER SPECIFICATIONS / NYLACRON™ WHEELS

Dia. (in)	Width (in)	Cap. (lb)	OAH (in.)	Wheels Per Caster	Wt. (lb)	Swivel Part Number Add B, P, PL, R or T*
2	7/8	1200	5	2	14	SM-NY-P*-0278-S
2-1/2	1-1/4	1200	5-1/2	1	13	SM-NY-P*-2512-S
3	2	1800	6-1/4	1	20	SM-NY-P*-0320-S

*Add "B" for Ball Bearing, "P" for Precision Bearing, "PL" for Plain Bearing, "R" for Roller Bearing or "D" for Delrin Bearing

**CAD DRAWINGS FOR STAGE / SCENE SHIFTING CASTERS & DOLLIES AVAILABLE
CUSTOM DOLLIES AVAILABLE**

GATE & LADDER CASTERS

Load Capacity Up to 210 lbs.



**Custom Gate & Ladder
Casters Available
in Stainless Steel
with Nylacron™ Wheels**

Dia. (in.)	Width (in.)	Capacity (lbs.)	OAH (in.)	Swivel Lead (in.)	Part Number
LC Series Ladder Caster					
Solid Rubber (41 Plain Bearing)					
4	1	125	10-1/2	3.2	LCRN04041S007
GC Series Gate Caster					
Pneumatic (27 Radial Ball Bearing)					
8	2-1/2	210	18-1/2	6.5	GCSF08427S008

Casters are designed to make gate opening and closing easy. Casters feature gate mounts and spring loaded shock absorption.

Features

- Gate mount integrated in caster
- Spring loaded design provides shock absorption

**LC Series Ladder Caster****GC Series Gate Caster**



- Built-in stabilizer is adjustable
- Rubber stabilizer "post" helps absorb shaking and shock
- Excellent low-profile caster for workstations that only occasionally move
- Stabilizer acts as a miniature "lock" when fully engaged—prevents caster from moving
- Strong nylon wheel is non-marking
- Double race swivel design
- Available in top plate and stemless fastenings

- Corrosion-resistant zinc plated finishing, sleek chrome plating or Ivory powder coating for extra style
- Extra load capacity with stabilizer engaged

- Application include : Computer workstations
Work tables
Printer and electronic stands

Wheel Dia.	Hub Length	Wheel Type with Plain Bearing	Capacity (lb.) Rolling / Stabilized	OAH	Swivel Lead	Part Number	Type
1-3/4"	1-1/16"	NYL-Nylon	220 / 550	2-3/4"	2-13/32"	9320-00-NYL	Stemless
1-3/4"	1-1/16"	NYL-Nylon	220 / 550	2-3/4"	2-13/32"	9320-01-NYL	Square Plate
1-3/4"	1-1/16"	NYL-Nylon	220 / 550	2-3/4"	2-13/32"	9320-02-NYL	Hexagon Plate
2-1/2"	1-3/8"	NYL-Nylon	320 / 1,000	4-1/32"	3-3/32"	9330-00-NYL	Stemless
2-1/2"	1-3/8"	NYL-Nylon	320 / 1,000	4-1/32"	3-3/32"	9330-01-NYL	Square Plate

Dia.	Type	Size	Code
1-3/4"	Stemless	M12 x 1.75P Tap Depth 9/32"	00
1-3/4"	Hexagon Plate	Overall: 2-3/4" x 2-3/4" Hole Spacing: Center dia. 65mm x 6 holes Attaching Bolt Size: M6 x 1.0P	02
1-3/4"	Square Plate	Overall: 2-7/8" x 2-7/8" Hole Spacing: 2-9/32" x 2-9/32" Attaching Bolt Size: M6 (1/4")	01
2-1/2"	Stemless	M12 x 1.75P Tap Depth 25/32"	00
1-3/4"	Square Plate	Overall: 3-35/64" x 3-35/64" Hole Spacing: 2-3/4" x 2-3/4" Attaching Bolt Size: M8 (5/16")	01

Code	Finish
IPC	Ivory Power Coating (Standard)
ZN	Zinc Plating
CR	Chrome Plating

See our
Specialty Products Section
for Saginaw Leveling Jacks.

LC/SS Stem Type



LC/SS Plate Type



Stainless Steel Leveling Casters

Available in the following sizes:

Model #	Load per Unit	Recommended Total Load / 4 Units
LC/40/SS	150 lbs	370 lbs
LC/60/SS	800 lbs	1650 lbs
LC/40/SS	1700 lbs	3500 lbs

Available in plate and stem sizes.

Call Acorn™ for complete specifications and dimensions.

LEVELING CASTERS

Load Capacity Up to 2200 lbs.

- Stabilizer acts as a miniature "total lock" when fully engaged – prevents caster/equipment from moving
- Excellent low-profile caster
- Double race swivel design
- Stylish ivory powder coating
- NSF Listed for food service industry

TYPICAL APPLICATIONS

- Computer Workstations
- Printer and Other Electronic Equipment Stands
- Work Tables
- Food Service
- Pharmaceutical

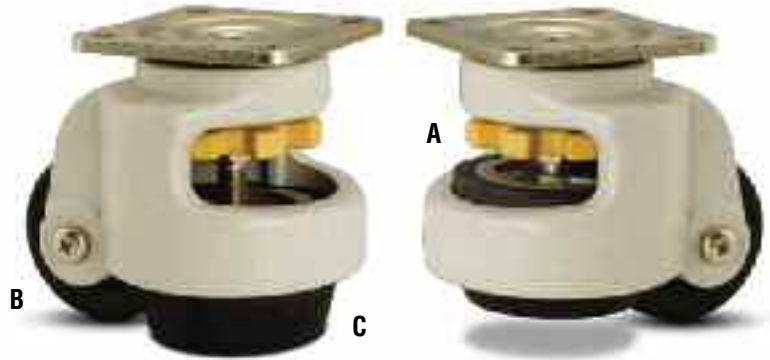

- A.** Built-in leveler is easily adjustable
- B.** Strong nylon wheel is non-marking
- C.** Rubber stabilizer "post" helps absorb equipment shaking and shock (turn yellow dial until caster is lifted off the ground)

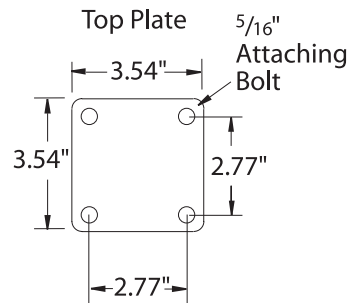
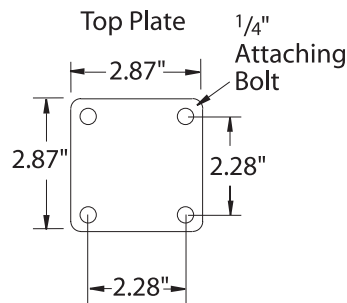
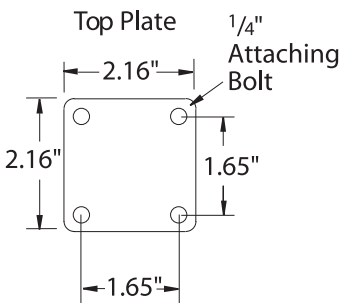

Dia. (in.)	Width (in.)	Hub (lbs.)	OAH (in.)	Max. OAH Using Leveler	Capacity (lb)	Swivel Lead (in.)	Weight (lb)	Part Number
1.68	.70	.80	2.80	3.27	110	3.40	.82	WSLC-NN-PL-0104-S
2.00	.88	.93	3.23	3.70	660	3.90	1.50	WSLC-NN-PL-0204-S
2.40	1.13	1.23	4.02	4.61	1320	5.30	3.00	WSLC-NN-PL-02X4-S
2.86	1.25	1.32	4.72	5.51	2200	5.60	3.70	WSLC-NN-PL-0304-S

Stainless Steel Leveling Casters available in the following sizes:

Model No.	Load per Unit	Recommended Total Load / 4 Units
LC/40/SS	150 lbs	370 lbs
LC/60/SS	800 lbs	1650 lbs
LC/40/SS	1700 lbs	3500 lbs

Available in plate and stem sizes.
Call Acorn™ for complete specifications and dimensions.



HIGH-TEMP BAKERY CASTERS

- Excellent Wheels for Bakery Racks
- Soft Tread Wheels Protect Your Floors
- Economical
- Handles the Heat
- Rolls quietly
- Temperature Range: -40° to 485°F intermittent (285°F continuous use)
- Typical applications include: Food Service, Pharmaceutical, Laboratories, Hospitals



Cross Section

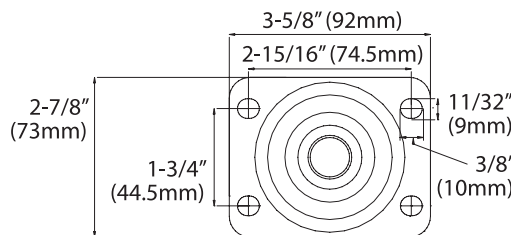
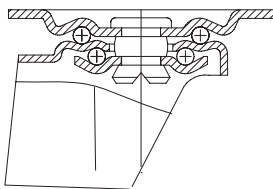

Swivel

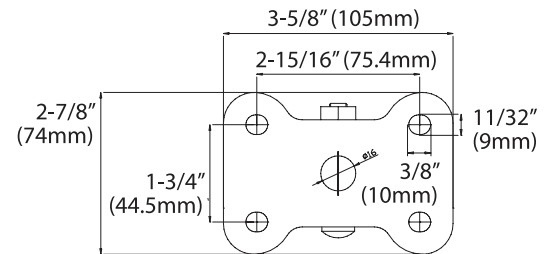

Rigid

HIGH-TEMP BAKERY CASTER SPECIFICATIONS

Diameter (in.)	Tread Width (in.)	Capacity (lbs.)	OAH (in.)	Swivel Lead (in.)	Part Number
ELASTIC RUBBER / ALUMINUM CORE (ER/AL)					
4	1-9/16	170	5-1/8	1-3/8	HTBC-ER/AL-P-0412-S
4	1-9/16	170	5-1/8	N/A	HTBC-ER/AL-P-0412-R
ELASTIC RUBBER / HIGH-TEMP PHENOLIC (ER/TM)					
4	1-3/16	185	5-1/8	1-3/8	HTBC-ER/TM-PL-0411-S
4	1-3/16	185	5-1/8	N/A	HTBC-ER/TM-PL-0411-R
ELASTIC RUBBER / ALUMINUM CORE (ER/AL)					
4	1-9/16	170	1.77	.320	ER/AL-P-0412805
Durometer: 73 Shore A Temperature Range: -40° to 485°F intermittent (285°F continuous use) Bearing: Precision ball. Stainless steel bearings available.					
ELASTIC RUBBER / HIGH-TEMP PHENOLIC (ER/TM)					
4	1-3/16	185	1.77	.412	ER/TM-0404105
Durometer: 85 Shore A Temperature Range: -40° to 485°F intermittent (285°F continuous use) Bearing: Plain bearing. Comes with spanner for 5/16" axles.					

Why the World's Largest Glass Processors Use Float-On™ Casters...

INSTANT DIRECTIONAL CHANGES



Ensures smooth movement of materials with delicate or polished surfaces.

DESIGNED FOR USE IN WET AND DRY CONDITIONS



BZP = Bright Zinc Plate can be used in most applications

S/S = Stainless Steel Inox for the most arduous of conditions

INSTANT DIRECTIONAL CHANGES



Ensures smooth movement of materials with delicate or polished surfaces.

LH Caster bias
moves toward
the Right



RH Caster bias
moves toward
the Left

Float-On™ Casters are used for easy handling of other flat sheet materials as well:

Granite • Wood • Plastic • Paper

Multi Choice Options to Suit All Applications

COMPLETE FLOAT-ON™ CASTERS

	Black Rubber
35mm BZP	ACR 35 R/H or L/H
35mm S/S	ACR 35 R/H or L/H S/S
50mm BZP	ACR 50 R/H or L/H
50mm S/S	ACR 50 R/H or L/H S/S



	Red Polyurethane
35mm BZP	ACP 35 R/H or L/H
35mm S/S	ACP 35 R/H or L/H S/S
50mm BZP	ACP 50 R/H or L/H
50mm S/S	ACP 50 R/H or L/H S/S



Easy to replace component parts below:

BALLS ONLY

	Black Rubber
35mm	ACR 35 B
50mm	ACR 50 B



	Red Polyurethane
35mm	ACP 35 B
50mm	ACP 50 B



STEM, CIRCLIP, WASHER AND BALL ONLY

	Bright Zinc Plated (BZP)
35mm	SCW 35 RB R/H or L/H
50mm	SCW 50 RB R/H or L/H
35mm	SCW 35 RP R/H or L/H
50mm	SCW 50 RP R/H or L/H



	Stainless Steel (S/S)
35mm	SCW 35 RB R/H or L/H S/S
50mm	SCW 50 RB R/H or L/H S/S
35mm	SCW 35 RP R/H or L/H S/S
50mm	SCW 50 RP R/H or L/H S/S

Note: When ordering stems / circlip / washers or complete casters, please state whether you require R/H (right hand) or L/H (left hand).

1 KG = 2.2 LBS
1 INCH = 25.4 MM

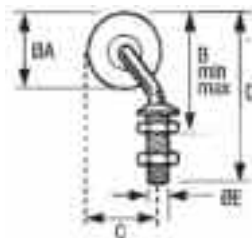

A Dia mm	B mm		C mm	D mm	Load Cap Kgs	E Dia mm
	min	max				
35	55	77	38	88	15	13.5
50	73	95	58	106	20	13.5

Developed specifically for food handling and processing industries where equipment sanitation is essential. Recommended for bakeries, bottling plants, cafeterias, canneries, candy plants, chemical plants, dairies, hotels, institutions, meat processing plants, pharmaceutical houses, restaurants, wholesale suppliers and supermarkets. Designed to reduce waste build-up which also facilitates complete clean-up. Designed to meet Food and Baking Industry Sanitation Standards.

SANITARY CASTERS

- Top Plate and Yoke Base - Forged Steel
- Swivel Bearing and Seal - Full ball bearing type with seals to prevent entry of foreign matter or moisture and to retain lubricant
- Wheel Bearing - Straight roller bearing held in position with sealed retaining washers. Hardened and ground spanner bushing provides precision inner race and strengthens fork.
- Wheel Spacers and Thrust Washers - Spacers between leg and wheel provide 1/2" clearance for cleaning. Thrust washers are recessed into side of wheel.
- Lubrication - Swivel and wheel bearings lubricated with high quality, waterproof, high temperature lubricant. Pressure fittings are provided for replenishing lubricant if necessary. USDA Approved.
- Finish - All metal parts zinc plated for corrosion resistance. For severe corrosive conditions, these casters can be Kanigen® Plated and equipped with stainless steel components. Other types of plating and components are available for your particular environmental conditions.

Wheel Features

Specially designed molded Texite wheels which affords floor protection. These wheels are straight sided with recess in hub for steel thrust washers and the straight roller bearings are completely sealed.

All Sanitary Casters can be supplied with:

MONOCAST MC 907 "NN" USDA Approved or KRYPTONIC "KR" wheels with Precision Wheel Bearings (28)

All food and bakery equipment should be equipped with Nylacron™ wheels (either white or dark gray) with dual sealed precision ball bearings for severe duty.



54-TS-06201-S
Swivel Sanitary

**Recommended
Kingpinless with
NYLACRON™**



54-TS-06201-R
Rigid Sanitary



NSF Approved Casters



Other wheel types available in this caster series.

SPECIFICATIONS

Diameter	WHEEL		★ Capacity	Overall Height	Wheel Hub Length		Swivel Lead	†† Approx. Weight	† Caster Number	REPLACEMENT WHEEL NUMBER	
	Width	★ Capacity			Hub Length	Swivel Lead				With Sealed Bearing‡	Less Bearing
Inches (MM)	Inches (MM)	Pounds (KG)	Inches (MM)	Inches (MM)	Inches (MM)	Inches (MM)	Pounds (KG)*				
4 (101.6)	1 1/2	500 (227.3)	5 1/2 (142.9)	1 3/8 (34.9)	1 1/2 (41.3)	4 1/4	50-TS-04101	TS-04101-12	TS-04100-19		
5 (127.0)		500 (227.3)	6 1/2 (165.1)	1 7/8 (46.8)	1 1/2 (44.5)	5	50-TS-05101	TS-05101-12	TS-05100-19		
6 (152.4)		500 (227.3)	7 1/2 (191.3)	2 (50.8)	1 1/2 (44.5)	5 1/2	50-TS-06101	TS-06101-12	TS-06100-19		
4 (101.6)	1 3/4	800 (363.6)	5 1/2 (142.9)	2 1/8 (52.1)	1 1/2 (41.3)	5 1/4	51-TS-04201	TS-04201-12	TS-04200-19		
5 (127.0)		900 (409.1)	6 1/2 (165.1)	2 1/4 (61.1)	2 1/4 (61.1)	5 1/2	51-TS-05201	TS-05201-12	TS-05200-19		
6 (152.4)		900 (409.1)	7 1/2 (191.3)	2 3/4 (69.3)	2 1/4 (61.1)	6 1/2	51-TS-06201	TS-06201-12	TS-06200-19		
8 (203.2)		900 (409.1)	10 (254.0)	3 (76.2)	2 1/4 (61.1)	2 1/4 (61.1)	9 1/4	51-TS-08201	TS-08201-12	TS-08200-19	
4 (101.6)	1 3/4	800 (363.6)	5 1/2 (142.9)	2 1/8 (52.1)	1 1/2 (41.3)	8 1/4	53-TS-04201	TS-04201-12	TS-04200-19		
5 (127.0)		1000 (454.5)	6 1/2 (165.1)	2 1/4 (61.1)	2 1/4 (61.1)	7 1/4	53-TS-05201	TS-05201-12	TS-05200-19		
6 (152.4)		1200 (545.4)	7 1/2 (191.3)	2 3/4 (69.3)	2 1/4 (61.1)	2 1/4 (61.1)	8 1/4	53-TS-06201	TS-06201-12	TS-06200-19	
8 (203.2)		1200 (545.4)	10 (254.0)	3 (76.2)	2 1/4 (61.1)	2 1/4 (61.1)	11 1/4	53-TS-08201	TS-08201-12	TS-08200-19	
4 (101.6)	1 3/4	800 (363.6)	5 1/2 (142.9)	2 1/8 (52.1)	1 1/2 (41.3)	8 1/4	54-TS-04201	TS-04201-12	TS-04200-19		
5 (127.0)		1000 (454.5)	6 1/2 (165.1)	2 1/4 (61.1)	2 1/4 (61.1)	9	54-TS-05201	TS-05201-12	TS-05200-19		
6 (152.4)		1200 (545.4)	7 1/2 (191.3)	2 3/4 (69.3)	2 1/4 (61.1)	2 1/4 (61.1)	10	54-TS-06201	TS-06201-12	TS-06200-19	
8 (203.2)		1400 (636.3)	10 (254.0)	3 (76.2)	2 1/4 (61.1)	2 1/4 (61.1)	12 1/4	54-TS-08201	TS-08201-12	TS-08200-19	

All Sanitary Casters can be supplied with **MONOCAST MC 907 “NN”** USDA Approved or **KRYPTONIC “KR”** wheels with **Stainless Steel or Standard Precision Wheel Bearings (28)**

- ★ Capacity rating is for manual operation.
- ‡‡ Hub length is measured over flush inserted steel thrust washers.
- †† Right caster weight is approximately 1 to 2% over left.
- † For swivel caster, add suffix “-S”; for rigid caster, add suffix “-R”.
- * Multiply pounds x .4545 = (kilograms).
- ‡ Wheels are furnished with straight roller bearing and with rubber tipped metal washer seals.

TOP PLATE AND BOLT HOLE SPECIFICATIONS

Series	Top Plate Size	Bolt Hole Centers	Attaching Bolt Size
50	Modified 16 Series		
51	Modified 16 Series		
53	Modified 71 Series		
54	Modified 72 Series		

For variation in bolt hole centers, see “OPTIONAL DIMENSIONAL TABLES”

Standard Sanitary casters are being replaced with Heavy Duty Sealed Kingpinless Casters and Nylacron™ wheels.



For bakery dough troughs or other equipment where Industry Sanitation Codes apply.



For proof or cooling racks. Or for animal cages in pharmaceutical laboratories.

Above: Dough troughs and proof / cooling racks should have kingpinless casters with NYLACRON™ wheels.

Designed for use on inverted angle track for any service requiring guidance of the truck or conveyor unit. Suggested uses include movement of production jigs or fixtures in straight line assembly, travel in and out of “blind alley” retorts or ovens, and in assembly or processing operations where rivets, bolts or other wheel stopping hazards might impede normal movement.

V-GROOVE CASTER FEATURES

- Complete flexibility either on the floor or track
- Wheel face and “V” groove fully machined
- Wheel Bearings - straight roller, with hardened and precision ground spanner bushing inner race for medium to heavy duty service. Tapered roller bearings for heavier duty or more rugged applications.
- Lubrication - full pressure type to all bearings.
- Finish - Rigs thru Series 90 are plated. Series 94 and 95 rigs and all wheels are finished in aluminum enamel.



Swivel Caster Model 72-VG-062001-S shown in position on angle iron track

OPTIONAL FEATURES AVAILABLE:

See appropriate caster series

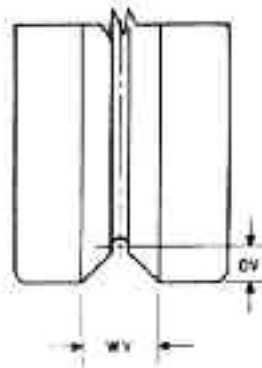

NYLACRON™ Wheels Available



95-VH-10709-R rigid caster with 10 x 4 V-Groove wheel 15,000 pound rating

Caster Height and Top Plate Mounting Dimensions

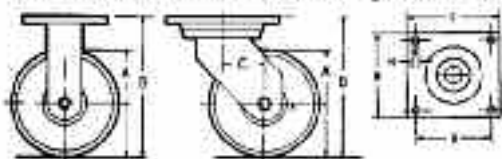

V-GROOVE CASTER SPECIFICATIONS with CAST IRON WHEELS

Dia. (mm)	Width (mm)	Cap. (R Brg)	Cap. (T Brg)	OAH (mm)	Hub Length	Swivel Lead	Bolt Hole Centers	Top Plate	Wt. (kg)	Part Number Roller Brg	Part Number Tapered Brg
4	1-3/4	800	-	5-5/8	2-3/16	1-7/16	2-5/8 x 3-5/8	4 x 4-1/2	7-1/2	16-VG-R-04201	-
4	1-3/4	800	-	5-5/8	2-3/16	1-5/16	3-3/8 x 5-1/4	4-1/2 x 6-1/4	9-1/4	62-VG-R-04201	-
4	1-3/4	800	-	5-5/8	2-3/16	1-7/16	2-5/8 x 3-5/8	4-1/2 x 6-1/4	9	71-VG-R-04201	-
4	1-3/4	800	-	5-5/8	2-3/16	1-7/16	2-7/16 x 4-15/16	S= 4-1/2 x 6-1/4	10-1/2	72-VG-R-04201	-
5	2	800	-	6-1/2	2-3/16	1-5/8	2-5/8 x 3-5/8	4 x 4-1/2	8-1/2	16-VG-R-05201	-
5	2	800	-	6-1/2	2-3/16	1-1/2	3-3/8 x 5-1/4	4-1/2 x 6-1/4	10-1/4	62-VG-R-05201	-
5	2	800	-	6-1/2	2-3/16	1-13/16	2-5/8 x 3-5/8	4-1/2 x 6-1/4	10	71-VG-R-05201	-
5	2	800	-	6-1/2	2-3/16	1-13/16	2-7/16 x 4-15/16	R= 4 x 6	11-1/2	72-VG-R-05201	-
6	2	900	-	7-1/4	2-3/16	1-3/4	2-5/8 x 3-5/8	4 x 4-1/2	11-3/4	16-VG-R-06201	-
6	2	1000	-	7-1/2	2-3/16	1-3/4	2-7/16 x 4-15/16	4-1/2 x 6-1/4	13-1/2	62-VG-R-06201	-
6	2	1000	-	7-1/2	2-3/16	2-1/4	2-5/8 x 3-5/8	4 x 5	13-1/4	71-VG-R-06201	-
6	2	1000	-	7-1/2	2-3/16	2-1/4	2-5/8 x 4-7/8	R= 4 x 6	14-3/4	72-VG-R-06201	-
6	2-1/2	2000	2000	7-5/8	3-1/4	1-1/2	3-3/8 x 5-1/4	4-1/2 x 6-1/4	21-3/4	81-VG-R-06401	81-VG-R-06409
6	2-1/2	2500	2500	8	3-1/4	2-1/4	3-3/8 x 5-1/4	S= 5-1/4 x 7-1/4	26-1/4	90-VG-R-06401	90-VG-R-06409
8	2-1/2	2000	2000	10-1/8	3-1/4	2-1/4	3-3/8 x 5-1/4	4-1/2 x 6-1/4	26-1/4	81-VG-R-08401	81-VG-R-08409
8	3	2500	2500	10-1/2	3-1/4	2-1/2	3-3/8 x 5-1/4	S= 5-1/4 x 7-1/4	31-3/4	90-VG-R-08401	90-VG-R-08409
8	3	4000	4000	10-1/2	3-1/4	2-1/2	4-1/2 x 6	S= 6-1/2 x 7-1/2	42-3/4	94-VG-R-08501	90-VG-R-08509
10	3	3000	3500	12-1/2	3-1/4	2-1/2	3-3/8 x 5-1/4	R= 5 x 7-1/4	42-1/2	90-VG-R-10501	90-VG-R-10509
10	3	3000	3500	12-1/2	3-1/4	2-1/2	3-3/8 x 5-1/4	R= 5 x 7-1/4	42-1/2	90-VG-R-10501	90-VG-R-10509
10	3	4000	4000	12-1/2	3-1/4	2-1/2	4-1/2 x 6	R= 6 x 7-1/2			
10	3	4000	4000	12-1/2	3-1/4	2-1/2	4-1/2 x 6	S= 6-1/2 x 7-1/2	53-1/2	94-VG-R-10501	90-VG-R-10509
								R= 6 x 7-1/2			

*Add "B" for Ball Bearing, "P" for Precision Bearing, "PL" for Plain Bearing, "R" for Roller Bearing or "T" for Tapered Bearing.

All Rig Options should be added to the end of the part number. (i.e. 72DW-PB-R*-0415-SL for Swivel Lock)

See Wheel Section for other premium wheels.

V-GROOVE CASTER SPECIFICATIONS with DROP FORGED WHEELS

Dia. (mm)	Width (mm)	Cap. (R Brg)	Cap. (T Brg)	OAH (mm)	Hub Length	Swivel Lead	Bolt Hole Centers	Top Plate	Wt. (kg)	Part Number Roller Brg	Part Number Tapered Brg
6	3	6000	6500	8-1/2	3-1/4	2-1/2	4-1/2 x 6	S= 6-1/2 x 7-1/2 R= 6 x 7-1/2	45	94-VF-R-06501	94-VF-R-06509
6	3	6000	10000	9	3-1/4	2-1/4	7 x 7	8-1/2 x 8-1/2	59-1/2	95-VF-R-06501	95-VH-R-06509
8	4	8350	10000	10-1/2	4-1/4	2-1/2	4-1/2 x 6	S= 6-1/2 x 7-1/2 R= 6 x 7-1/2	47	94-VF-R-08701	94-VF-R-08709
8	4	8350	15000	11	4-1/4	2-1/4	7 x 7	8-1/2 x 8-1/2	61-1/2	95-VF-R-08701	95-VH-R-08709
10	3	6000	6000	12-1/2	3-1/4	2-1/2	4-1/2 x 6	S= 6-1/2 x 7-1/2	63	94-VH-R-10501	94-VH-R-10509
10	4	8350	10000	12-1/2	4-1/4	2-1/2	4-1/2 x 6	S= 6-1/2 x 7-1/2	73-3/4	94-VF-R-10701	94-VF-R-10709
10	3	6000	6000	13	3-1/4	2-1/2	7 x 7	8-1/2 x 8-1/2	67-3/4	95-VH-R-10501	95-VH-R-10509
10	4	8350	15000	13	4-1/4	2-1/4	7 x 7	8-1/2 x 8-1/2	89-1/2	95-VF-R-10701	95-VH-R-10709

*Add "B" for Ball Bearing, "P" for Precision Bearing, "PL" for Plain Bearing, "R" for Roller Bearing or "T" for Tapered Bearing.

All Rig Options should be added to the end of the part number. (i.e. 72DW-PB-R*-0415-SL for Swivel Lock)

See Wheel Section for other premium wheels.

ALL V-GROOVE CASTERS ARE NOW AVAILABLE IN KINGPINLESS CONSTRUCTION.

KINGPINLESS PNEUMATIC CASTER FEATURES

16 Series/ Swivel Section: Cold forged top plate, yoke and button are all heat treated to prevent brinelling, improve swivel action and increase service life. Load and thrust bearings are hardened and ground and rotate on hardened raceways. All swivel sections are equipped with a lubrication fitting for field maintenance. Notched yokes are standard.

71K Series / Raceway Design: Patented Kingpinless™ single ball bearing precision machined raceway, to 53 Rockwell C minimum, lube fittings for swivel bearings and for wheel bearings. Swivel section features a 2-3/8" diameter raceway with 3/8" ball bearings. Notched yokes are standard.

90K Series / Raceway Design: Patented Kingpinless™ single ball bearing precision machined raceway, to 53 Rockwell C minimum. Swivel section features a 3" diameter raceway with 1/2" ball bearings. Lube fittings for swivel bearings and wheel bearings. Notched yokes are standard.

94K Series / Raceway Design: 4-1/2" diameter raceway with 3/4" diameter carbon steel balls. Precision machined and hardened to 53 Rockwell C minimum. Load and thrust are accommodated by our Patented Kingpinless™ design. Sealed raceway is standard. Swivel Top Plate - SAE 1045 hot steel forging. Swivel Yoke Base - SAE 1045 hot steel forging.

98K Series / Raceway Design: Patented Kingpinless™ single ball bearing precision machined raceway, to 53 Rockwell C minimum. 7" diameter raceway with 3/4" diameter ball bearings.



For best performance,
all pneumatic casters should be of
KINGPINLESS CONSTRUCTION.

Note: Maintain proper air pressure for best results. Capacity rating is for manual operation. For capacities of power moved loads, larger diameter or higher capacity wheels, please consult the factory.

Options

CWB: Cam Wheel Brake (8" & 10" only)

DSL: Demountable swivel lock (requires Notched yoke)

FCWB: Face Contact Wheel Brake for larger sizes

FF: Foam Filled Tire

HDSL: Heavy-Duty Threaded Swivel Lock

NY : Notched Yoke

SL: Swivel Lock

SR: Sealed Swivel Raceway

STANDARD TOP PLATES

Series / Top Plate	Mounting Plate (in)	Bolt Hole Spacing (in)	Bolt Size (in)
16 & 71K	4 x 4-1/2	2-5/8 x 3-5/8 slotted to 3 x 3	3/8
90K	5-1/4 x 7-1/4	3-3/8 x 5-1/4 slotted to 4-1/8 x 6-1/8	1/2
94K	6-1/4 x 4-1/2 (swl)	4-1/2 x 6 slotted to 4-1/8 x 6-1/8	1/2
98K	8-1/2 x 8-1/2	7 x 7	5/8

PNEUMATIC CASTER SPECIFICATIONS

Dia. (in.)	Width (in.)	Cap. (lbs.)	OAH (in.)	Swivel Caster with Straight Roller Bearing	Swivel Caster with Ball Bearing	Swivel Caster with Tapered Bearing	Swl. Lead (in.)	Wt. (lbs.)
8	2.80/4	300	11	4-16-SF-R-0828-S	4-16-SF-B-0828-S	–	2-5/8	9.5
8	2.80/4	300	11	5-72K-SF-R-0828-S	5-72K-SF-B-0828-S	–	2-5/8	13
8	2.80/4	600	11	5-72K/DW-SF-R-0828-S	5-72K/DW-SF-B-0828-S	–	2-5/8	20
10	4.10/4	480	13	4-16-SF-R-1041-S	4-16-SF-B-1041-S	–	3-1/4	11
10	4.10/4	480	13	5-72K-SF-R-1041-S	5-72K-SF-B-1041-S	5-72K-SF-T-1041-S	3-1/4	14
10	4.10/4	960	13	5-72K/DW-SF-R-1041-S	5-72K/DW-SF-B-1041-S	5-72K/DW-SF-T-1041-S	3-1/4	22
12	4.10/6	500	15-1/2	4-16-SF-R-1241-S	4-16-SF-B-1241-S	–	3-1/2	14.5
12	4.10/6	500	15-1/2	5-72K-SF-R-1241-S	5-72K-SF-B-1241-S	5-72K-SF-T-1241-S	3-1/2	15
12	4.10/6	1000	15-1/2	5-72K/DW-SF-R-1241-S	5-72K/DW-SF-B-1241-S	5-72K/DW-SF-T-1241-S	3-1/2	35
14	5.30/6	870	17-3/4	7-90K-SF-R-1448-S	7-90K-SF-B-1448-S	7-90K-SF-T-1448-S	4-1/2	28
14	5.30/6	1740	17-3/4	7-90K/DW-SF-R-1448-S	7-90K/DW-SF-B-1448-S	7-90K/DW-SF-T-1448-S	4-1/2	41
16	4.80/8	1000	19-1/8	7-90K-SF-R-1648-S	–	7-90K-SF-T-1648-S	4-1/2	35
16	4.80/8	1230	19-1/8	–	–	8-94K-SF-T-1648-S***	4	45
16	4.80/8	2000	19-1/8	7-90K/DW-SF-R-1648-S	–	7-90K/DW-SF-T-1648-S	4-1/2	53
16	4.80/8	2460	19-1/8	–	–	8-94K/DW-SF-T-1648-S***	4	45
18	5.70/8	1170	21-1/4	7-90K-SF-R-1857-S	–	7-90K-SF-T-1857-S	4-1/2	35
18	5.70/8	2340	21-1/4	7-90K/DW-SF-R-1857-S	–	7-90K/DW-SF-T-1857-S	4	45
18	5.70/8	1560	21-1/2	8-94K-SF-R-1857-S***	–	8-94K-SF-T-1857-S***	4-1/2	53
18	5.70/8	3120	21-1/2	8-94K/DW-SF-R-1857-S***	–	8-94K/DW-SF-T-1857-S***	4	45
21	6.90/9	2420	24-1/4	–	–	10-98K-SF-T-2169-S****	5	84.5
21	6.90/9	4840	24-1/4	–	–	10-98K/DW-SF-T-2169-S****	5	130
23	6.50/10	2775	26-1/4	–	–	10-98K-SF-T-2365-S****	5	87
23	6.50/10	5550	26-1/4	–	–	10-98K/DW-SF-T-2365-S****	5	135
25	7.50/10	3630	28-3/4	–	–	10-98K-SF-T-2575-S****	5	90.5
25	7.50/10	7260	28-3/4	–	–	10-98K/DW-SF-T-2575-S****	5	140

For rigid casters, change "S" to "R" (i.e. 72K/DW-SF-R*-1041-S becomes 72K/DW-SF-R*-1041-R)

All Rig Options should be added to the end of the part number. (i.e. 72K/DW-SF-R*-1041-SL for Swivel Lock)

ALL PNEUMATIC WHEELS ARE AVAILABLE WITH SEALED PRECISION BEARINGS

*Add 1/8" to caster overall height when using this top plate.

**Deduct 1/16" to caster overall height when using this top plate.

***6 ply

****10 ply

4 ply is standard

Maintain proper air pressure for best results. Capacity rating is for manual operation. For capacities of power moved loads, larger diameter or higher capacity wheels, please consult Acorn™.

OPTIONAL TOP PLATES

Series / Top Plate	Mounting Plate (in)	Bolt Hole Spacing (in)	Bolt Size (in)
16 & 71K Series Top Plates			
41	4x5	2-5/8 x 3-5/8 slotted to 3 x 4	3/8
42	4-1/2 x 6-1/2	2-7/16 x 4-15/16 slotted to 3-3/8 x 5-1/4	1/2
43	5 x 5-1/2	4-1/8 x 4-1/2	3/8
90K Series Top Plates			
90	6 x 7	4-5/8 x 5-1/2 slotted to 4-3/8 x 5-5/8	1/2
95	6 x 7-1/2	4-1/2 x 6 slotted to 4-1/8 x 6-1/8	1/2
42	4-1/2 x 6-1/2	2-7/16 x 4-15/16 slotted to 3-3/8 x 5-1/4	1/2
98K Series Top Plates			
91	8-1/2 x 11	7 x 9-3/4	5/8

SEMI-PNEUMATIC SERIES: 4-12 / 4-16 / 5-72

Recommended for light or medium duty dollies, bottlers trucks, hand trucks or other manually operated units. Semi-pneumatics are high profile, solid center cushion rubber tires mounted on stamped centers with lug base rims. For extra heavy service, kingpinless construction recommended.



FEATURES

- **Swivel Casters:** Double ball bearing raceway
- **Shock Absorbing:** Extra Heavy Duty Cushion wheel protects equipment
- **No inflation problems:** As these wheel are not pressurized
- **Pressure Lubrication:**
To all bearings 6" diameter wheels must be lubricated thru hollow axle as pressure fitting cannot be inserted in hub Bearings – Ball or roller bearings

OPTIONS

- Swivel lock specify **L**
- Face contact brake **F**
- Foot activated swivel lock specify **SL160001** (16 Series Model)
- Sealed swivel specify **NS**

4-12 SERIES / 4-16 SERIES / 5-72 SERIES (SEMI-PNEUMATIC)

Dia. (in.)	Width (in.)	Capacity (in.)	OAH (in.)	Swivel Lead (in.)	Wt. (lb.)	Caster # Ball Bearing	Caster # Roller Bearing
4-12 Series							
6	2.00EHS	200	7-3/8	1-3/4	6-3/4	4-12-SN-B-0620-S	4-12-SN-R-0620-S
8	2.50EHS	350	10	1-3/4	10-3/4	4-12-SN-B-0825-S	4-12-SN-R-0825-S
4-16 Series							
6	2.00EHS	200	7-3/8	1-3/4	6-1/4	4-16-SN-B-0620-S	4-16-SN-R-0620-S
5-72 Series							
10	2.75EHS	350	11-1/2	3-1/2	17	5-72-SN-B-1027-S	5-72-SN-R-1027-S
12	3.00EHS	540	14-1/2	3-1/2	22	5-72-SN-B-1230-S	5-72-SN-R-1230-S

Never-Flat Wheels available

in 8" and 10" diameters.

See section 11

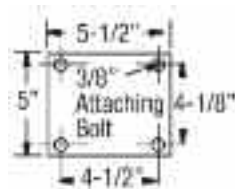

**4-12 Series
Top Plate**

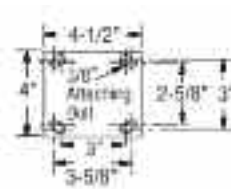

**4-16 Series
Top Plate**

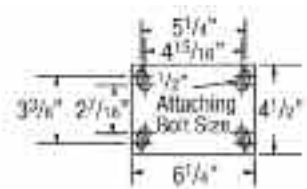

**5-72 Series
Top Plate**

SEMI-PNEUMATIC SERIES: 4-16 / 5-72 / 7-90

Recommended for the greatest possible protection to both load and floor, or for off-road application. If you transport fragile materials or parts – or if you move delicate instruments over rough floors, you should consider this product offering. Full pneumatics cushion the load on air as does automobile or truck wheels. For extra heavy service, kingpinless construction recommended.



FEATURES

- **Swivel Casters:** Double ball bearing raceway
- **Shock Absorbing:** Cushion wheel protects equipment
- **Bearings:** Ball or Roller Bearings

OPTIONS

- Swivel lock specify **L**
- Foot activated swivel lock specify **SL160002** (16 Series Models)
- Face contact brake specify **F**
- Sealed Swivel specify **NS**
- Foam fill available; consult Acorn™
- Precision bearings available; consult Acorn™
- For towed applications tapered bearings are recommended

4-16 SERIES / 5-72 SERIES / 7-90 SERIES (SEMI-PNEUMATIC)

Dia. (in.)	Width (in.)	Capacity (in.)	OAH (in.)	Swivel Lead (in.)	Wt. (lb.)	Caster # Ball Bearing	Caster # Roller Bearing
4-16 Series							
6	2.00/4	200	7-1/4	1-3/4	8-1/2	4-16-SF-B-0620-S	
8	2.00/4	210	9-1/2	1-3/4		4-16-SF-B-0820-S	
8	2.50/4	220	10-1/8	1-3/4	7	4-16-SF-B-0825-S	4-16-SF-R-0825-S
8	2.80/4	295	11	2-5/8	9-1/2	4-16-SF-B-0828-S	4-16-SF-R-0828-S
10	4.10/4	350	13	3-1/4	11	4-16-SF-B-1041-S	4-16-SF-R-1041-S
12	4.10/4	445	15-1/2	3-1/2	14-1/4	4-16-SF-B-1241-S	4-16-SF-R-1241-S
5-72 Series							
6	2.00/4	200	7-1/2	2-3/16	8-1/2	5-72-SF-B-0620-S	
8	2.00/4	210	11	2-5/8		5-72-SF-B-0820-S	
8	2.80/4	295	11	2-5/8	12-3/4	5-72-SF-B-0828-S	5-72-SF-R-0828-S
10	4.10/4	350	13	3-1/4	14-1/4	5-72-SF-B-1041-S	5-72-SF-R-1041-S
12	4.10/4	445	15-1/2	3-1/2	17-1/2	5-72-SF-B-1241-S	5-72-SF-R-1241-S
7-90 Series							
14	5.30/6	785	17-3/4	4	29-1/4	7-90-SF-B-1453-S	7-90-SF-R-1453-S
16	4.80/8	1000	19-1/8	4-1/2	35-1/2		7-90-SF-R-1648-S
18	5.70/8	1170	21-1/4	5	41		7-90-SF-R-1857-S

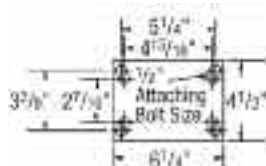

**4-16 Series
Top Plate**

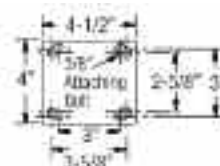

**5-72 Series
Top Plate**



**7-90 Series
Top Plate**

PNEUMATIC SERIES: 8-94BBL / 9-95BBL

These casters and wheels are deluxe models. Use them for very heavy duty service. They will handle any job that is practical to mount on pneumatics. The tires are mounted on wide base rims. This permits more air volume, more load capacity, stability and cushioning. Wheel bearings are tapered with dust seals. Note: model ordered may look different than photo above. For extra heavy service, kingpinless construction recommended.



FEATURES

- **Swivel Casters:** Hardened double ball bearing raceway with 1-1/4" tapered roller thrust bearing
- **Shock Absorbing:** Cushion wheel protects equipment
- **Pressure Lubrication:** To all bearings

OPTIONS

- Swivel lock specify **L**
- Face contact brake **F**
- Sealed swivel specify **NS**
- Foam fill available; consult Acorn™

8-94/BBL SERIES / 9-95/BBL SERIES (PNEUMATIC)

Dia. (in.)	Width (in.)	Capacity (in.)	OAH (in.)	Swivel Lead (in.)	Wt. (lb.)	Tapered Bearing Caster #
8-94/BBL Series						
16	4.80/8	1300	19-1/8	4	44-1/4	8-94/BBL/SF-T-1648-S
18	5.70/8	1590	21-1/2	4-1/2	54-3/4	8-94/BBL/SF-T-1857-S
9-95/BBL Series						
21	6.90/9	2420	24-1/4	5	84-1/4	9-95/BBL/SF-T-2169-S
23	6.50/10	2775	26-1/4	5	87-1/4	9-95/BBL/SF-T-2365-S
25	7.50/10	3630	28-3/4	5	90-1/2	9-95/BBL/SF-T-2575-S

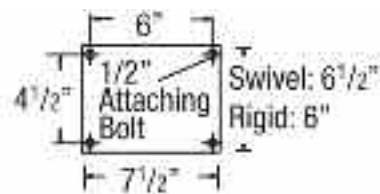

**8-94/BBL Series
Top Plate**

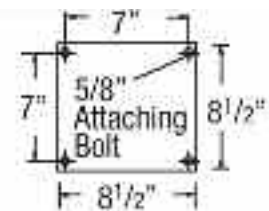

**9-95/BBL Series
Top Plate**

FEATURES

- **Top Plate & Yoke Base:** Cold formed from 1/4" steel plate
- **Swivel Section:** Smooth formed, double ball bearing raceways
- **Fork Legs:** 1/4" steel, formed to increase strength and welded to yoke base
- **Kingpin:** 5/8" diameter orbitally spun steel rivit
- **Axle:** 1/2" diameter solid axle complete with lock nut
- **Wheel Seals:** Nylon seal retaining / thrust washers
- **Lubrication:** Zerk fitting in swivel section
- **Finish:** Polished brass



SWIVEL CROSS SECTION

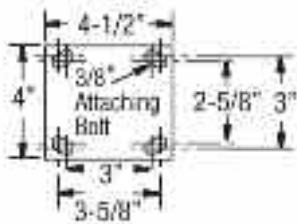
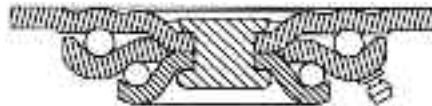

**4-16 Series
Top Plate**

4-16/BR (BRASS PNEUMATIC CASTERS)

Dia. (in.)	Width (in.)	Capacity (in.)	OAH (in.)	Swivel Lead (in.)	Wt. (lb.)	Part #
Black Tread						
8	2.50/4	210	9 1/2	1-3/4	6-1/2	4-16/BR/BT-SF-0825-S
Gray Tread						
8	2.50/4	210	9 1/2	1-3/4	6-1/2	4-16/BR/GT-SF-0825-S

4-16/BR (REPLACEMENT WHEELS)

Dia. (in.)	Width (in.)	Capacity (in.)	Hub Length	Bore ID (in.)	Bearing ID	Wt. (lb.)	Part #
Black Tread							
8	2.50/4	210	2-7/16	1-3/8	1/2	3	SF/BR/BT-SF-0825-08
Gray Tread							
8	2.50/4	210	2-7/16	1-3/8	1/2	3	SF/BR/GT-SF-0825-08



PNEUMATIC DUAL WHEEL CASTERS

Load Capacity Up to 7260 lbs.



SF

Dual wheel models are recommended for the greatest possible protection to both loads and floors with increased capacity. If you transport fragile materials or parts - or if you move delicate instruments over rough floors, you should consider this product offering.

Standard Models

- **Swivel Casters:** Double ball raceway
- **Shock Absorbing:** Cushion wheel protects equipment
- **Bearings:** Ball or roller bearings

BBL Models

- **Swivel Casters:** Hardened double ball bearing raceway with 1-1/4" tapered roller thrust bearing
- **Shock Absorbing:** Cushion wheel protects equipment
- **Pressure Lubrication:** To all bearings

Options

- **Swivel lock** specify L
- **Face contact brake** specify F
- **Sealed Swivel** specify NS
- **Foam fill** please consult Acorn™

Dia. (in.)	Width (in.)	Capacity (lbs.)	OAH (in.)	Swivel Lead (in.)	Wt. (lbs.)	Part Number
5-72/DW Series						
8	2.80/4	590	11	2-5/8	19	5-72/DW-SF-P-0828-S
10	4.10/4	700	13	3-1/4	21-3/4	5-72/DW-SF-P-1041-S
7-90/DW Series						
12	4.10/6	890	15-1/2	3-1/2	35	7-90/DW-SF-P-1241-S
14	5.30/6	1570	17-3/4	4	41	7-90/DW-SF-P-1453-S
16	4.80/9	2000	19-1/8	4-1/2	53-1/4	7-90/DW-SF-P-1648-S
18	5.70/8	2340	21-1/4	5	59-3/4	7-90/DW-SF-P-1857-S
8-94/DW/BBL Series						
16	4.80/8	2600	19-1/8	4	71	8-94/DW/BBL-SF-P-1648-S
18	5.70/8	3180	21-1/2	4-1/2	81-3/4	8-94/DW/BBL-SF-P-1857-S
9-95/DW/BBL Series						
21	6.90/9	4840	24-1/4	5	129-3/4	9-95/DW/BBL-SF-P-2169-S
23	6.50/10	5550	26-1/4	5	134-1/2	9-95/DW/BBL-SF-P-2365-S
25	7.50/10	7260	28-3/4	5	139	9-95/DW/BBL-SF-P-2575-S

5-72/DW Series Top Plate

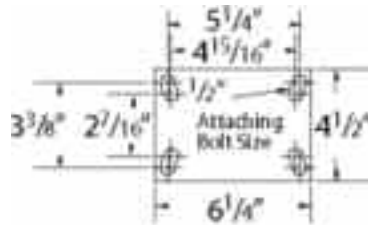

8-94/DW/BBL Series Top Plate

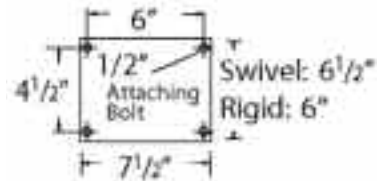

7-90/DW Series Top Plate

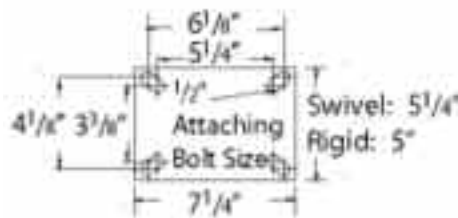

9-95/DW/BBL Series Top Plate

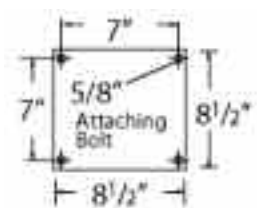

Dual locking system locks both the wheel and swivel simultaneously, and is foot or hand operated. These casters are ideally suited for floodlight stands, motion picture equipment or movable work platforms that need to roll and then lock in place.

SCAFFOLD CASTERS

- Dual locking system engages both the wheel and the swivel to lock at same time.
- When fully locked the system will not disengage without operating locking lever either manually or by foot.
- Thread guards are standard to help keep out dirt, dust, and other materials that may affect wheel bearings.
- Zerk fittings are provided for lubricating both the swivel and wheel bearings.
- Other type wheels (from stock) are available than those specified below.
- The most popular round stem:
 - 1-3/8 x 4" (std) with 1/2" cross drilled hole 2-1/2" up from base on center
- Other round stems:
 - 1-7/16 x 4" (NY) with 3/8" cross drilled hole 2-1/2" up from base on center
 - 1-1/4 x 4" (NE) with 1/2" cross drilled hole 2-1/2" up from base on center

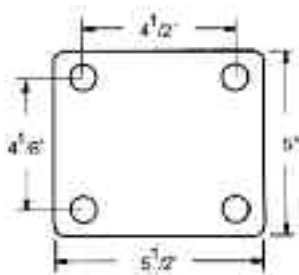

**OPTIONAL TOP PLATE
(IN LIEU OF STEM):**

Top Plate size: 5 x 5-1/2"
 Bolt Hole Centers: 4-1/8 x 4-1/2"
 Attaching bolt size: 7/16"

Wheel Dia.	Tread Width	OAH	Swivel Radius	Wheel Type	Load Capacity	Part Number
6"	2"	7-1/2"	4-31/32"	Moldon Rubber / Cast Iron Core	410	SC-MR-06201-_*TG
6"	2"	7-1/2"	4-31/32"	Polyurethane / Cast Iron Core	700	SC-PY-06201-_*TG
8"	2"	9-1/2"	6-1/4"	Moldon Rubber / Cast Iron Core	500	SC-MR-08201-_*TG
8"	2"	9-1/2"	6-1/4"	Polyurethane / Cast Iron Core	800	SC-PY-08201-_*TG

*Type Fastener (i.e. Top Plate Size or Round Stem Size)

ACORN™ IN-PLANT SURVEY

A simple, safe & ergonomic operating practice for any caster application:
Each caster on the equipment should be rated at an amount equal to the total load.

ACORN PRODUCT SURVEY

Equipment Name / Type: _____

Floor Material: _____

Measurements: _____

Floor Condition: _____

Maximum Capacity:

Contents + Container Weight = _____ lbs

Is Overload Possible? ___ Yes ___ No

Shock Loads? ___ Yes ___ No

Heavier Loads in Future? ___ Yes ___ No

If Yes, _____ lbs

Operating Environmental Factors: (Noise, Speed, Abuse, Extreme Temperature, Oils, Constant Moisture, Other _____

Movement: ___ Manual Operation ___ Power/Towing Operation

Power: ___ High Speed ___ Side Thrust

CASTER MOUNTING PATTERN

Conventional: _____

Diamond: _____

4-Wheel: _____

6-Wheel: _____

Other: _____

ACCESSORIES / OPTIONS

Swivel Locks (SL): _____

Wheel Brakes (WB): _____

Total Lock Brakes (TL): _____

Floor Locks (FL): _____

Other: _____

TOP PLATE / CASTER CONSTRUCTION

Present Top Plate Size: _____ x _____ in / mm

Present Bolt Hole Pattern: _____ x _____ in / mm

Slotted To: _____ x _____ in / mm

Rig Construction: ___ Stamped ___ Cold Forged

 ___ Hot Forged ___ Kingpinless

 ___ Stainless Steel ___ Welded Legs

Present Overall Height: _____ in / mm

Present Swivel Radius: _____ in / mm

Notes: _____

WHEEL OPTIONS

Wheel Diameter: _____

Tread Width: _____

Bearing Type: _____

Other: _____

Acorn Recommendations: _____

