



BLUE ELASTIC RUBBER

Series	Caster Type	Page #
TP1-TP3	Pressed Steel - Top Plates	2
03	Pressed Steel - Brakes	3
LPA / LHA	Pressed Steel - Light Duty (Extrathane® wheels)	4
LE	Pressed Steel - Medium Duty (Nylon / Blue Elastic wheels)....	5-6
L	Pressed Steel - Medium Heavy Duty (w/ Nylon wheels)	7
LK	Pressed Steel - Medium Heavy Duty (w/ Nylon wheels)	8
SS	Pressed Stainless Steel	9-11

Acorn™ can supply any size and type caster rig with any type wheel with proper size precision ball bearings. Call, fax or e-mail for application assistance, or visit our website to view or print our complete catalog.

Visit our Web site for new products
www.acornindprod.com



NOISE ABSORBING NYLON



NYLON



EXTRATHANE®

TOP PLATE #1Dimensions in Millimeters

85 mm x 100 mm

Dimensions in Inches

3-1/8 in x 4-1/8 in

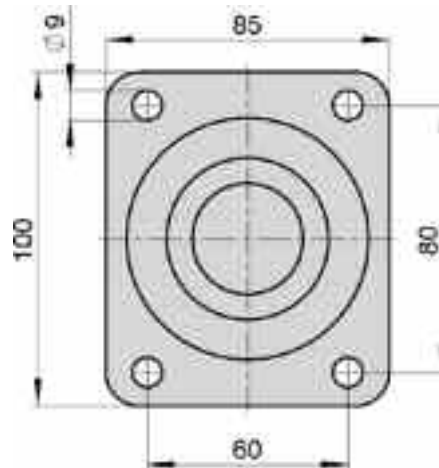
**TOP PLATE #3**Dimensions in Millimeters

110 mm x 140 mm

Dimensions in Inches

4-1/4 in x 5-1/2 in

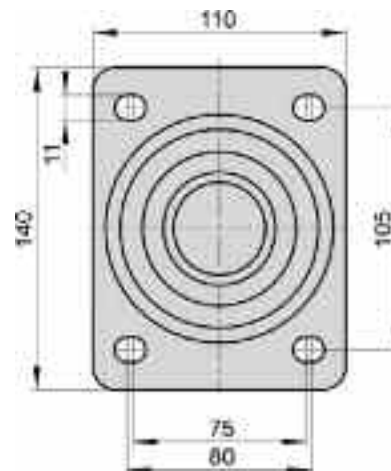
**TOP PLATE #22**Dimensions in Millimeters

60 mm x 60 mm

Dimensions in Inches

2-3/8 in x 2-3/8 in

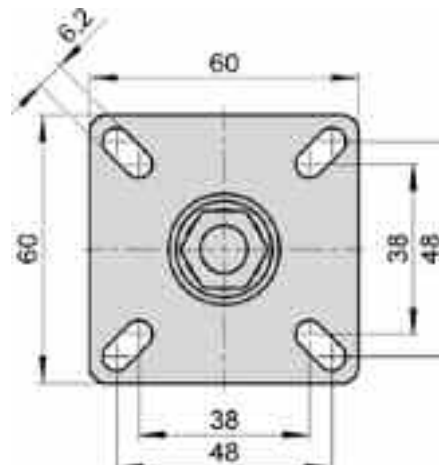

Wheel and Swivel Head Brakes

With the brake systems described in the following sections, the rolling and swivel motions of swivel casters can be locked when the equipment is motionless. (Wheel and swivel head brakes) Depending on the application type, "non-trailing", "trailing" or "stationary" brake systems are used. Related to the rolling direction, the "non-trailing" brake system is fitted to the front of the caster and the "trailing" brake system to the rear. The "stationary" brake system does not rotate with the swivel head. The brake lever remains in the same position at all times. The selection of one of these three brake systems depends on the requirements based upon user-friendliness, fitting conditions, and user-specific accident prevention measures. If these brake systems are combined with wheels with soft tyres/treads, particularly the VW, VWPP and P wheel series, the brake forces are reduced.

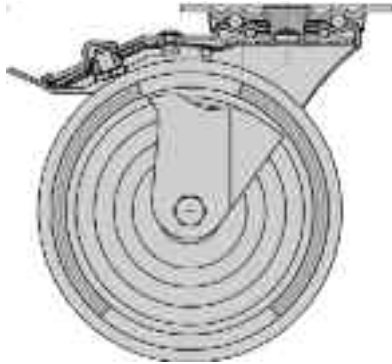

Total Lock Trailing Edge Wheel and Swivel (TL/TE)

This brake system is attached to the back of the bracket and provides a positive locking of the swivel head and a nonpositive locking of the wheel by means of a very strong brake mechanism, designed for high security and long life.

A brake spring engages in a toothed spherical disc and locks both the swivel head and the wheel.

The holding pressure is adjustable for the HD bracket series (all sizes).

The design of this brake system meets the requirement for a minimum swivel radius.



TL/TE

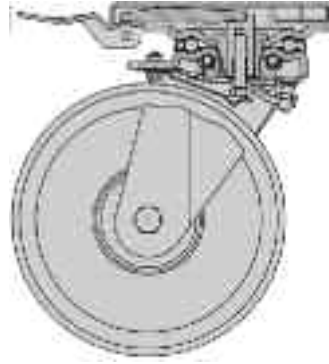

Total Lock Ideal Brake Wheel and Swivel (TL/IB)

This brake system provides a non-positive swivel head and wheel brake on the basis of a very strong brake mechanism which has been designed in accordance with high security and long service life aspects. Wear is prevented by the conical brake within the swivel head.

The holding pressure is adjustable. The special characteristic of this brake system is its "stationary" brake lever which does not rotate together with the swivel caster and therefore is always operable at the same position.

Increases height by 17 mm. A synthetic adapter plate (Ref. No. AP3) is available for the height adjustment of casters without these brakes.



TL/IB

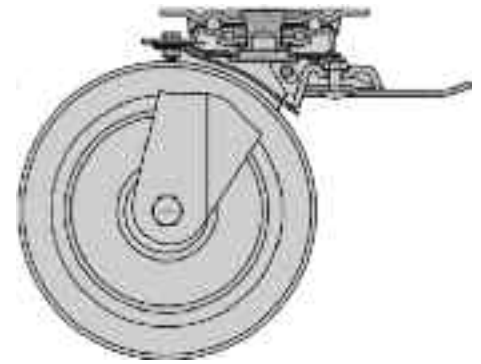

Total Lock Leading Edge Brake Wheel and Swivel (TL/LE)

This brake system provides a non-positive swivel head and wheel brake on the basis of a very strong brake mechanism which has been designed in accordance with high security and long service life aspects.

The holding pressure is adjustable. The rotation radius of the brake lever is mostly positioned within the wheel's swivel radius.



TL/LE

PLATE TYPE FEATURES

Load Capacity Up to 100 kg.

Casters: Pressed steel, swivel bracket with double ball bearing in the swivel head, bolted wheel axle, zinc-plated.

Wheels: Made of Extrathane® polyurethane, firmly bonded, colour light brown, non-marking, 92° shore A, elastic, abrasion-resistant, high cut and tear propagation resistance, non-staining, floor-saving, low-noise operation, low rolling resistance. Very good chemical connection with the wheel centre. Wheel centre: Made of steel **with precision ball bearings.**



**Extrathane®
Wheel**

01 LPA PLATE CASTER SPECIFICATIONS

Wheel Dia. (mm)	Wheel Width (mm)	Capacity (lb)	Bearing Type	OAH (mm)	Plate (mm)	Bolt Hole Spacing (mm)	Bolt Hole (mm)	Offset (mm)	Swivel Part Number
35	27	220	Precision Ball	52	60 x 60	38 x 38 / 48 x 48	6, 2	15	03B-LPA-ER/STL-P-35-S
35	27	220	Precision Ball	52	60 x 60	38 x 38 / 48 x 48	6, 2	15	03B-LPA-NY/MD-P-35-S

HOLE TYPE FEATURES

Load Capacity Up to 100 kg.

Casters: Pressed steel, swivel bracket with double ball bearing in the swivel head, bolted wheel axle, zinc-plated.

Wheels: Made of Extrathane® polyurethane, firmly bonded, colour light brown, non-marking, 92° shore A, elastic, abrasion-resistant, high cut and tear propagation resistance, non-staining, floor-saving, low-noise operation, low rolling resistance. Very good chemical connection with the wheel centre. Wheel centre: Made of steel, precision ball bearing.

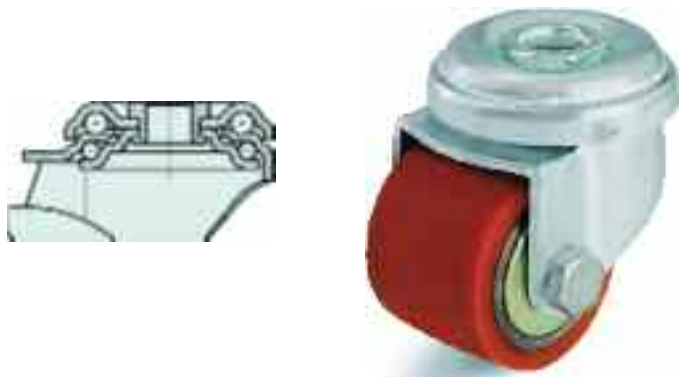

**Extrathane®
Wheel**

01 LHA HOLE CASTER SPECIFICATIONS

Wheel Dia. (mm)	Wheel Width (mm)	Capacity (lb)	Bearing Type	OAH (mm)	Plate (mm)	Bolt Hole (mm)	Offset (mm)	Swivel Part Number
35	27	220	Precision Ball	50	43	11	15	03B-LHA-ER/STL-P-35-S
35	27	220	Precision Ball	50	43	11	15	03B-LHA-NY/MD-P-35-S

LE / LEH SERIES — NOISE ABSORBING NYLON WHEELS

Casters: Pressed steel, swivel bracket with double ball bearing in the swivel head, dynamically pressed resulting in an extremely low swivel head play and a long service life, with swivel head sealing, bolted wheel axle, zinc-plated.

Hole Casters: Pressed steel, with bolt hole, double ball bearing in the swivel head and strong central kingpin, dynamically pressed resulting in an extremely low swivel head play and a long service life, bolted wheel axle, zinc-plated.

Wheels: Made of high-quality nylon, color natural white, noise-absorbing (-10 decibel) achieved with elastic solid rubber inner cushion ring layer, color grey, vibration-cushioned operational comfort, high abrasion resistance, low rolling resistance, smooth running performance on even floors, shock and impact-resistant, corrosion-resistant. Wheel centres: Made of high-quality nylon, color black, shock and impact-proof, corrosion-resistant, ball bearing.

Brake Options:

TL/TE Total lock / **T**ailing edge brake

TL/LE Total lock / **L**eading edge brake

TL/IB Total lock / **I**deal locking brake



LE SWIVEL CROSS SECTION

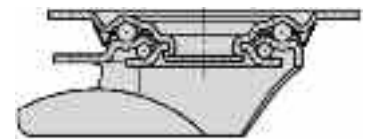

LEH SWIVEL CROSS SECTION



LE / LEH SERIES CASTER SPECIFICATIONS

Wheel Type (Wheel Code)	Diameter (mm)	Width (mm)	Capacity (lbs)	OAH (mm)	Bolt Hole (mm)	Offset Swivel (mm)	Swivel Part Number Bearing Type***
NOISE ABSORBING NYLON (NA/NN) WHEELS W/ PRECISION BALL BEARINGS – SWIVEL RIG W/ TP1 TOP PLATE 100 X 85; BOLT HOLE 80 X 60							
	100	35	330	125	9	36	03B/LE-ST1-NA/NN*-P-100-S**
	125	35	330	150	9	40	03B/LE-ST1-NA/NN*-P-125-S**
Wheel Type (Wheel Code)	Diameter (mm)	Width (mm)	Capacity (lbs)	OAH (mm)	Plate / Bolt (mm)	Offset (mm)	Swivel Part Number
NOISE ABSORBING NYLON (NA/NN) WHEELS W/ PRECISION BALL BEARINGS – SWIVEL RIG W/ BOLT HOLE FITTING							
	100	35	330	125	70 / 13	36	03B/LEH-NA/NN*-P-100-S**
	125	35	330	150	70 / 13	40	03B/LEH-NA/NN*-P-125-S**

* Add wheel options after wheel designation in part number

** Add caster options after swivel designation in part number , i.e. Add "R" for rigid, TL/LE for Total Lock/ Leading Edge Brake

*** P=Precision Bearing, R=Roller Bearing, PL=Plain Bearing

VARIANTS / ACCESSORIES

Code	-XR
Description	Stainless steel roller bearing in wheel hub
Available for Wheel (mm)	-Upon Request

LE SERIES — BLUE ELASTIC RUBBER WHEELS

LE Casters: Pressed steel, swivel bracket with double ball bearing in the reinforced swivel head, dynamically pressed resulting in an extremely low swivel head play and a long service life, strong central kingpin (wheel Ø 160-250 mm) and swivel head sealing, bolted wheel axle, zinc-plated.

Wheels: Elastic solid rubber, smooth rolling quality, color blue, 65° shore A, vulcanised, non-detachable connection, low rolling resistance.

Wheel centres: Made of high-quality nylon, colorblack, shock and impact-resistant, corrosion-resistant, plain, roller or ball bearing.

**Brake Options:**

TL/TE Total lock / **Trailing** edge brake

TL/LE Total lock / **Leading** edge brake

TL/IB Total lock / **Ideal** locking brake

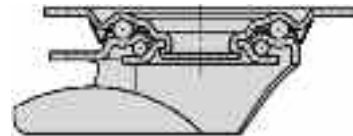
**LE SWIVEL
CROSS SECTION**

LE Casters are Available in Stainless Steel and Hole Casters.

LE SERIES CASTER SPECIFICATIONS

Wheel Type (Wheel Code)	Diameter (mm)	Width (mm)	Capacity (lbs)	OAH (mm)	Bolt Hole (mm)	Offset Swivel	Swivel Part Number Bearing Type***
ELASTIC RUBBER / BLUE / NYLON CORE (ER/BL/NN) WHEEL W/ PRECISION BALL BRG – SWIVEL RIG W/ TP1 TOP PLATE 100 X 85, BHC 80 X 60							
	100	38	375	125	36	9	03BLE-TP1-ER/BL/NN*-P-100-S**
	125	40	440	150	40	9	03BLE-TP1-ER/BL/NN*-P-125-S**

* Add wheel options after wheel designation in part number

** Add caster options after swivel designation in part number , i.e. Add "R" for rigid, TL/LE for Total Lock/ Leading Edge Brake

*** P=Precision Bearing, R=Roller Bearing, PL=Plain Bearing

VARIANTS / ACCESSORIES

Code	-XR
Description	Stainless steel roller bearing in wheel hub
Available for Wheel (mm)	-Upon Request

L SERIES — NOISE ABSORBING NYLON WHEELS

Casters: Pressed steel, swivel bracket with double ball bearing in the reinforced swivel head, dynamically pressed resulting in an extremely low swivel head play and a long service life, swivel head sealing, bolted wheel axle, zinc-plated.

Wheels: Made of high-quality nylon, color natural white, noise-absorbing (-10 decibel) achieved with elastic solid rubber inner cushion ring layer, color grey, vibration-cushioned operational comfort, high abrasion resistance, low rolling resistance, smooth running performance on even floors, shock and impact-resistant, corrosion-resistant. Wheel centres: Made of high-quality nylon, color black, shock and impact-proof, corrosion-resistant, ball bearing.

Brake Options:

- TL/TE Total lock / **T**ailing edge brake
- TL/LE Total lock / **L**eading edge brake
- TL/IB Total lock / **I**deal locking brake



L SWIVEL
CROSS SECTION

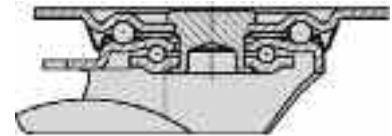

L SERIES CASTER SPECIFICATIONS

Wheel Type (Wheel Code)	Diameter (mm)	Width (mm)	Capacity (lbs)	OAH (mm)	Bolt Hole (mm)	Offset Swivel	Swivel Part Number Bearing Type***
NOISE ABSORBING NYLON (NA/NN) WHEELS W/ PRECISION BALL BEARINGS – SWIVEL RIG W/ TP1 TOP PLATE 100 X 85; BOLT HOLE 80 X 60							
	100	35	440	125	9	36	03BLE-TP1-NA/NN*-P-100-S**
	125	35	440	150	9	40	03BLE-TP1-NA/NN*-P-125-S**

* Add wheel options after wheel designation in part number

** Add caster options after swivel designation in part number , i.e. Add "R" for rigid, TL/LE for Total Lock/ Leading Edge Brake

*** P=Precision Bearing, R=Roller Bearing, PL=Plain Bearing

VARIANTS / ACCESSORIES

Code	-XR
Description	Stainless steel roller bearing in wheel hub
Available for Wheel (mm)	-Upon Request

LK SERIES — NOISE ABSORBING NYLON WHEELS

Casters: Pressed from heavy sheet-steel, swivel bracket with double ball bearing in the swivel head, dynamically pressed resulting in an extremely low swivel head play and a long service life, swivel head sealing, bolted wheel axle, zinc-plated.

Wheels: Made of high-quality nylon, color natural white, noise-absorbing (-10 decibel) achieved with elastic solid rubber inner cushion ring layer, color grey, vibration-cushioned operational comfort, high abrasion resistance, low rolling resistance, smooth running performance on even floors, shock and impact-resistant, corrosion-resistant. Wheel centres: Made of high-quality nylon, color black, shock and impact-proof, corrosion-resistant, ball bearing.

Brake Options:

TL/TE Total lock / **Trailing** edge brake
TL/LE Total lock / **Leading** edge brake
TL/IB Total lock / **Ideal** locking brake

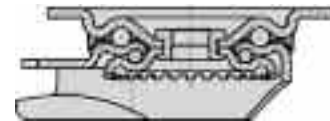

**LK SWIVEL
CROSS SECTION**

**LK SERIES CASTER SPECIFICATIONS**

Wheel Type (Wheel Code)	Diameter (mm)	Width (mm)	Capacity (lbs)	OAH (mm)	Bolt Hole (mm)	Offset Swivel	Swivel Part Number Bearing Type***
NOISE ABSORBING NYLON (NA/NN) WHEELS W/ PRECISION BALL BRG – SWIVEL RIG W/ TP1 TOP PLATE 100 X 85; BOLT HOLE 80 X 60							
	100	35	440	130	9	45	03BLK-TP1-NA/NN*-P-100-S**
	125	35	485	155	9	48	03BLK-TP1-NA/NN*-P-125-S**
NOISE ABSORBING NYLON (NA/NN) WHEELS W/ PRECISION BALL BRG – SWIVEL RIG W/ TP2 TOP PLATE 140 X 110; BOLT HOLE 105 X 75-80**							
	100	35	440	130	9	45	03BLK-TP2-NA/NN*-P-100-S**
	125	35	485	155	9	48	03BLK-TP2-NA/NN*-P-125-S**

* Add wheel options after wheel designation in part number

** Add caster options after swivel designation in part number , i.e. Add "R" for rigid, TL/LE for Total Lock/ Leading Edge Brake

*** P=Precision Bearing, R=Roller Bearing, PL=Plain Bearing

LEH/SS SERIES – ELASTIC RUBBER GRAY / NYLON CORE

Casters: Pressed from high-quality, chromium-nickel stainless steel (material No. 1.4301/AISI 304), with double ball bearing in the swivel head, with strong central kingpin, bolted wheel axle. All metal parts are stainless steel and brackets are vibration-ground finished.

Wheels: Elastic solid rubber, smooth rolling quality, color grey, non-marking, 65° shore A, vulcanised, non-detachable connection, low rolling resistance. Wheel centres: Made of high-quality nylon, color black, shock and impact-resistant, corrosion-resistant, plain or stainless steel roller bearing or sealed ball bearing. As standard, ball bearing versions are supplied with bearing sealing.



Additional wheels available. See Wheel Section or consult Acorn™.

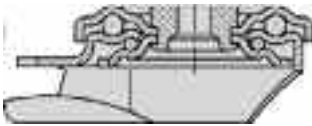

LEH/SS SERIES CASTER SPECIFICATIONS

Wheel Type (Wheel Code)	Dia. (mm)	Width (mm)	Capacity (lbs)	Bearing Type	OAH (mm)	Plate (mm)	Bolt Hole (mm)	Offset Swl (mm)	Part Number
ELASTIC RUBBER GRAY / NYLON CORE (ERG/NN) WHEELS WITH PRECISION BALL BEARINGS									
	100	38	330	Prec. Ball	125	70	13	36	03BSS-LEH-TP1-ERG/NN-P-100/38-S
	125	40	330	Prec. Ball	150	70	13	40	03BSS-LEH-TP1-ERG/NN-P-125/40-S
	160	50	660	Prec. Ball	195	88	13	54	03BSS-LEH-TP1-ERG/NN-P-160/50-S
	200	50	660	Prec. Ball	235	88	13	54	03BSS-LEH-TP1-ERG/NN-P-200/50-S

LE/SS SERIES – ELASTIC RUBBER GRAY / NYLON CORE

Casters: Pressed from high-quality, chromium-nickel stainless steel (material No. 1.4301/AISI 304), swivel bracket with double ball bearing in the swivel head, swivel head sealing, bolted wheel axle. All metal parts are stainless steel and brackets are vibration-ground finished.

Wheels: Elastic solid rubber, smooth rolling quality, color grey, non-marking, 65° shore A, vulcanised, non-detachable connection, low rolling resistance. Wheel centres: Made of high-quality nylon, color black, shock and impact-resistant, corrosion-resistant, plain or stainless steel roller bearing or sealed ball bearing. As standard, ball bearing versions are supplied with bearing sealing.



Additional wheels available. See Wheel Section or consult Acorn™.

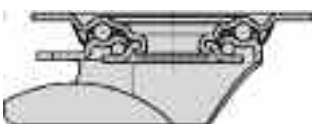

LE/SS SERIES CASTER SPECIFICATIONS

Wheel Type (Wheel Code)	Dia. (mm)	Width (mm)	Cap. (lbs)	Bearing Type	OAH (mm)	Plate (mm)	Bolt Hole Spacing (mm)	Bolt Hole (mm)	Offset Swl (mm)	Part Number
ELASTIC RUBBER GRAY / NYLON CORE (ERG/NN) WHEELS WITH PRECISION BALL BEARINGS										
	100	38	330	Prec. Ball	125	100 x 85	80 x 60	9	36	03BSS-LE-TP1-ERG/NN-P-100/38-S
	125	40	330	Prec. Ball	150	100 x 85	80 x 60	9	40	03BSS-LE-TP1-ERG/NN-P-125/40-S
	160	50	660	Prec. Ball	195	140 x 110	105 x 75-80	11	54	03BSS-LE-TP2-ERG/NN-P-160/50-S
	200	50	660	Prec. Ball	235	100 x 85	80 x 60	9	54	03BSS-LE-TP1-ERG/NN-P-200/50-S

L/SS SERIES – ELASTIC RUBBER GRAY / NYLON CORE

Casters: Pressed from high-quality, chromium-nickel stainless steel (material No. 1.4301/AISI 304), swivel bracket with double ball bearing in the reinforced swivel head, swivel head sealing, strong central kingpin, bolted wheel axle. All metal parts are stainless steel and brackets are vibration-ground finished.

Wheels: Elastic solid rubber, smooth rolling quality, colorgrey, non-marking, 65° shore A, vulcanised, non-detachable connection, low rolling resistance. Wheel centres: Made of high-quality nylon, colorblack, shock and impact-resistant, corrosion-resistant, stainless steel roller or sealed ball bearing. As standard, ball bearing versions are supplied with bearing sealing.

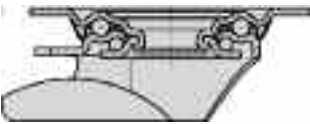

Additional wheels available.
See Wheel Section or consult Acorn™.



L/SS SERIES CASTER SPECIFICATIONS

Wheel Type (Wheel Code)	Dia. (mm)	Width (mm)	Cap. (lbs)	Bearing Type	OAH (mm)	Plate (mm)	Bolt Hole Spacing (mm)	Bolt Hole (mm)	Offset Swl (mm)	Part Number
ELASTIC RUBBER GRAY / NYLON CORE (ERG/NN) WHEELS WITH PRECISION BALL BEARINGS										
	160	50	770	Prec. Ball	195	140 x 110	105 x 75-80	11	60	03BSS-LP-TP2-ERG/NN-P-160/50-S
	200	50	880	Prec. Ball	235	140 x 110	105 x 75-80	11	65	03BSS-LP-TP2-ERG/NN-P-200/50-S

LX/SS SERIES – POLYURETHANE / NYLON CORE

Casters: Pressed from high-quality, chromium-nickel stainless steel (material No. 1.4301/AISI 304), swivel bracket with double ball bearing in the reinforced swivel head, swivel head sealing, strong central kingpin, bolted wheel axle. All metal parts are stainless steel and brackets are vibration-ground finished.

Wheels: Made of injection-moulded polyurethane, colorbrown, non-marking, 98° shore A, non-staining, abrasion-resistant, floor-saving, low-noise operation, low rolling resistance, excellent positive and non-positive connection with the wheel centre. Alternatively available with soft tread with improved skid resistance, colorgrey, 92° shore A, refer to Variants / Accessories. Wheel centres: Made of high-quality nylon, colornatural white, shock and impact-resistant, corrosion-resistant, plain, stainless steel roller or ball bearing.



Additional wheels available.
See Wheel Section or consult Acorn™.



LX/SS SERIES CASTER SPECIFICATIONS

Wheel Type (Wheel Code)	Dia. (mm)	Width (mm)	Cap. (lbs)	Bearing Type	OAH (mm)	Plate (mm)	Bolt Hole Spacing (mm)	Bolt Hole (mm)	Offset Swl (mm)	Part Number
POLYURETHANE / NYLON CORE (PY/NN) WHEELS WITH PRECISION BALL BEARINGS										
	150	40	880	Prec. Ball	190	140 x 110	105 x 75-80	11	60	03BSS-LX-TP2-PY/NN-P-150/40-S
	160	40	880	Prec. Ball	165	140 x 110	105 x 75-80	11	60	03BSS-LX-TP2-PY/NN-P-150/40-S
	200	50	880	Prec. Ball	235	140 x 110	105 x 75-80	11	65	03BSS-LX-TP2-PY/NN-P-150/40-S

LKX/SS SERIES – HEAVY DUTY NYLON

Casters: Pressed from heavy, high-quality, chromium-nickel stainless steel (material No. 1.4301/AISI 304), reinforced fork and top plate, double ball bearing in the swivel head, swivel head sealing, very strong central kingpin. All metal parts are stainless steel and brackets are vibration-ground finished.

Wheels: Made of high-quality nylon, very rugged, color natural white, high abrasion resistance, low rolling resistance, smooth running performance on even floors, shock and impact-resistant, corrosion-resistant, high chemical resistance to alcohol, salts, greases and certain acids and lyes in diluted concentration, plain or stainless steel ball bearing.

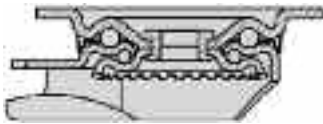

**Additional wheels available.
See Wheel Section or consult Acorn™.**



LKX/SS SERIES CASTER SPECIFICATIONS

Wheel Type (Wheel Code)	Dia. (mm)	Width (mm)	Capacity (lbs)	Bearing Type	OAH (mm)	Plate (mm)	Bolt Hole (mm)	Bolt Hole Spacing	Offset Swl (mm)	Part Number
HEAVY DUTY NYLON (NN/HD) WHEELS WITH PRECISION BALL BEARINGS										
	125	50	1650	Ball bearing	170	140 x 110	105 x 75-80	11	55	03BSS-LKX-TP2-NN/HD-P-125/50-S
	150	50	1760	Ball bearing	197	140 x 110	105 x 75-80	11	63	03BSS-LKX-TP2-NN/HD-P-150/50-S
	200	50	1760	Ball bearing	245	140 x 110	105 x 75-80	11	65	03BSS-LKX-TP2-NN/HD-P-200/50-S

ACORN™ IN-PLANT SURVEY

A simple, safe & ergonomic operating practice for any caster application:
Each caster on the equipment should be rated at an amount equal to the total load.

ACORN PRODUCT SURVEY

Equipment Name / Type: _____

Floor Material: _____

Measurements: _____

Floor Condition: _____

Maximum Capacity:

Contents + Container Weight = _____ lbs

Is Overload Possible? ___ Yes ___ No

Shock Loads? ___ Yes ___ No

Heavier Loads in Future? ___ Yes ___ No

If Yes, _____ lbs

Operating Environmental Factors: (Noise, Speed, Abuse, Extreme
Temperature, Oils, Constant Moisture, Other _____

Movement: ___ Manual Operation ___ Power/Towing Operation

Power: ___ High Speed ___ Side Thrust

CASTER MOUNTING PATTERN

Conventional: _____

Diamond: _____

4-Wheel: _____

6-Wheel: _____

Other: _____

ACCESSORIES / OPTIONS

Swivel Locks (SL): _____

Wheel Brakes (WB): _____

Total Lock Brakes (TL): _____

Floor Locks (FL): _____

Other: _____

TOP PLATE / CASTER CONSTRUCTION

Present Top Plate Size: _____ x _____ in / mm

Present Bolt Hole Pattern: _____ x _____ in / mm

Slotted To: _____ x _____ in / mm

Rig Construction: ___ Stamped ___ Cold Forged

 ___ Hot Forged ___ Kingpinless

 ___ Stainless Steel ___ Welded Legs

Present Overall Height: _____ in / mm

Present Swivel Radius: _____ in / mm

Notes: _____

WHEEL OPTIONS

Wheel Diameter: _____

Tread Width: _____

Bearing Type: _____

Other: _____

Acorn Recommendations: _____

